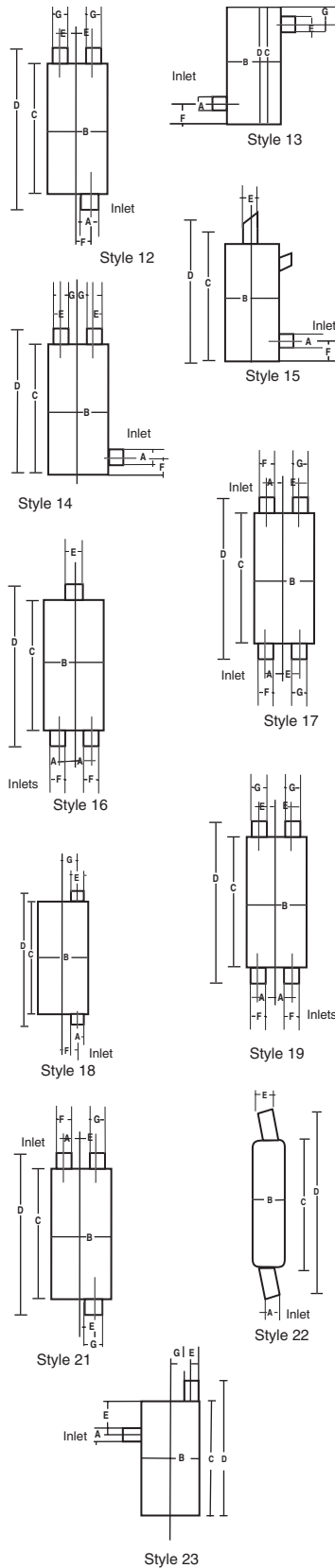

TABLE 2 - MUFFLER SPECIFICATIONS BY INLET SIZE



Part No.	Style	Inlet ID (A)	Shell Dia. (B)	Shell Length (C)	Overall Length (D)	Outlet ID (E)	Inlet Offset (F)	Outlet Offset (G)
21040	§	1 3/8	3 1/4	9 1/2	22 1/4	1 3/8		
22022	§	1 3/8	3 1/4	11	16 1/8	SP	1	
22020	§	1 3/8	5	12 1/2	12 1/2	1 3/8 OD	1 1/2	1 7/8
21035	§	1 1/2	3 1/4	24	34 1/4	1 1/2 OD		
22311	2	1 1/2	3 1/4 x 7 3/4	12	20	1 3/8	2 1/2	2 1/2
22266	3	1 1/2	3 1/4 x 7 3/4	15	18	1 1/2		2 1/2
21899	1	1 1/2	3 1/2	10 1/4	23 1/2	1 3/8 OD		
21585	◆	1 1/2 OD	4 1/4	18 1/2	21	1 3/8 OD		
21197	7	1 1/2	4 1/4 x 8 13/16	11	14 1/2	1 1/2 OD		1/2
22524	11	1 1/2	4 1/4 x 8 13/16	12	17 1/2	1 1/2 AS	2 5/8	
22347	2	1 1/2	4 1/4 x 8 13/16	13	16	1 1/2	2 5/8	2 5/8
22471	11	1 1/2	4 1/4 x 8 13/16	15	28	1 3/4 AS	2 5/8	
21257	7	1 1/2	4 1/4 x 8 7/8	11	27	1 1/2 OD		1/2
22433	□	2	1 1/2	4 1/4 x 9 3/4	17	20	1 1/2	2 7/8
22229	2	1 1/2	6	10	13	1 1/2	1 1/2	1 1/2
22305	□	2	1 1/2	6	11	1 1/2	1 1/2	1 1/2
22477	2	1 1/2	6	13	16 1/2	1 1/2	1 1/2	1 1/2
22615	12	1 1/2	7 x 9	12	17 1/4	1 1/2 AS	2 5/8	2 5/8
21184	11	1 1/2 OD	7 x 9	14	28	1 1/2 OD	2 5/8	1 5/8
22549	2	1 1/2 WF	SPECIAL	19	32	2 1/2 CT		
22550	2	1 1/2 WF	SPECIAL	19	32	2 1/2 CT		
21573	#	1 1/2 WF	SPECIAL	28	28	1 1/2 WF		
22046	§	1	1 5/8	3 1/4	15	17 1/2	1 1/2	
22221	3	1 5/8	3 1/4 x 7 3/4	16	19	1 1/2		2 1/2
22769	▲	10	1 5/8	4 1/4	12 3/4	15	1 5/8	2 1/4
22110	§	1	1 5/8	4 1/4	17 5/8	22 1/2	1 5/8	
22341	1	1 5/8	4 1/4 x 8 13/16	17	19 1/4	1 5/8		
22416	11	1 5/8	4 1/4 x 8 13/16	19	29	1 3/4 AS	2 5/8	
21012	2	1 5/8	6	10	18 1/2	1 1/2	1 1/2	1 1/2
22212	2	1 5/8	6	15	18	1 1/2	1 1/2	1 1/2
21728	1	1 21/32	3	14 5/8	17 1/2	1 1/2		
22340	1	1 21/32	3 1/2	15	34	1 21/32		
22218	2	1 21/32	5	19	27	1 1/2	1 1/4	1 1/4
21962	2	1 21/32	6	19	24	1 21/32	1 1/2	1 1/2
24210	1	1 3/4	3	12	17	1 3/4		
22042	§	1	1 3/4 OD	3 1/4	15 1/2	31 1/2	1 3/4 OD	
22043	§	1	1 3/4 OD	3 1/4	16 3/4	31 1/4	1 3/4 OD	
22527	1	1 3/4	3 1/4 x 7 3/4	12	15	1 7/8		
22428	11	1 3/4 WF	3 1/4 x 7 3/4	13	27	1 1/2 AS	2 1/2	
22424	11	1 3/4	3 1/4 x 7 3/4	17	30	1 5/8 OD	2 1/2	
22422	3	1 3/4	3 1/4 x 7 3/4	19	27	1 3/4 AS		2 1/2
21394	4	1 3/4	3 1/4 x 7 3/4	24	27	1 3/4		2 1/2
22548	1	1 3/4 WF	4	8	16	1 3/4 WF		
24227	4	1 3/4	4	12	16	3 OD		
22613	12	1 3/4	4 1/4 x 8 13/16	9	16 3/4	2 ST	2 5/8	2 5/8
21120	11	1 3/4	4 1/4 x 8 13/16	9	24 3/4	2 AS	2 5/8	
21429	2	1 3/4	4 1/4 x 8 13/16	10	24	2	2 5/8	2 5/8
22735	11	1 3/4	4 1/4 x 8 13/16	12	15	1 1/2	2 5/8	
22446	11	1 3/4	4 1/4 x 8 13/16	13	14 1/2	1 1/2	2 5/8	
22448	2	1 3/4	4 1/4 x 8 13/16	13	16	1 3/4 OD	2 5/8	2 5/8
22410	11	1 3/4	4 1/4 x 8 13/16	13	17	1 1/2 AS	2 5/8	
22334	3	1 3/4 WF	4 1/4 x 8 13/16	13	17 5/8	1 1/2		2 5/8
22411	11	1 3/4	4 1/4 x 8 13/16	13	25	1 1/2 AS	2 5/8	
22612	11	1 3/4	4 1/4 x 8 13/16	13	25	1 1/2 AS	2 5/8	
22421	12	1 3/4	4 1/4 x 8 13/16	14	26	1 1/2 AS		2 5/8
22762	10	1 3/4	4 1/4 x 8 13/16	15	18 5/8	1 3/4		
22763	10	1 3/4	4 1/4 x 8 13/16	15	18 5/8	1 3/4		
22423	2	1 3/4	4 1/4 x 8 13/16	15	22 1/2	1 3/4 OD	2 5/8	2 5/8
22379	2	1 3/4	4 1/4 x 8 13/16	15	23	1 3/4 AS	2 5/8	2 5/8
22707	2	1 3/4	4 1/4 x 8 13/16	15	26 1/2	1 3/4 AS	2 5/8	2 5/8
22387	6	1 3/4	4 1/4 x 8 13/16	16	19 1/2	1 1/2		2 5/8
22220	11	1 3/4	4 1/4 x 8 13/16	16	20	1 3/4	2 5/8	
22420	11	1 3/4	4 1/4 x 8 13/16	16	24	1 3/4 AS	2 5/8	
21119	2	1 3/4	4 1/4 x 8 13/16	16	25	1 3/4	2 5/8	2 5/8
22539	3	1 3/4	4 1/4 x 8 13/16	17	20	1 3/4		2 5/8
22640	11	1 3/4	4 1/4 x 8 13/16	18	21	1 3/4	1 3/4	
22429	3	1 3/4	4 1/4 x 8 13/16	19	23	1 3/4		2 5/8

- ▲ Arc Welded.
- † Double-Wall.
- ◆ Spark Arrestor.
- Welded Heat Shield.
- ◆ Resonator.
- # Special Style, not shown.
- @ Stainless.
- ‡ Threaded.
- § Tractor.
- AS Aluminized Spout.
- CT Chrome Tip.
- SB Spherical Ball.
- SF Spherical Flare Loose Flange.
- SP Spout.
- ST Stainless Tip.
- WF Welded Flange.
- WP Welded Pipe.
- WS Welded Spout.

INFORMATION & BUILD TO ORDER
 TOOLS AND ACCESSORIES
 SCHOOL BUS
 MEDIUM DUTY TRUCK GVV 3-6
 HEAVY DUTY TRUCK GVV 7-8
 APPLICATION BY ENGINE
 NOISE AND BACKPRESSURE DATA
 TRACTOR
 MUFFLER SPECS
 O.E. CROSS INDEX

TABLE 2 - MUFFLER SPECIFICATIONS BY INLET SIZE

Part No.	Style	Inlet ID (A)	Shell Dia. (B)	Shell Length (C)	Overall Length (D)	Outlet ID (E)	Inlet Offset (F)	Outlet Offset (G)
21392	2	1 3/4	4 1/4 x 9 3/4	10	24	2 AS OD	2 5/8	
22353	3	1 3/4	4 1/4 x 9 3/4	14	16 1/2	1 3/4		2 7/8
22419	2	1 3/4	4 1/4 x 9 3/4	14	22 1/4	1 3/4 AS	2 5/8	2 5/8
21348	11	1 3/4	4 1/4 x 9 3/4	15	22 1/2	1 7/8 OD	2 7/8	
22760	3	1 3/4	4 1/4 x 9 3/4	16	26	1 3/4 AS		2 7/8
22761	3	1 3/4	4 1/4 x 9 3/4	16	26	1 3/4 AS		2 7/8
22239	2	1 3/4	4 1/4 x 9 3/4	17	20 1/2	1 7/8 OD	2 7/8	2 7/8
22488	11	1 3/4	4 1/4 x 9 3/4	18	21	1 3/4		2 7/8
22525	11	1 3/4	4 1/4 x 9 3/4	18	21	1 3/4	3	
22482	12	1 3/4	4 1/4 x 9 3/4	19	22	1 1/2	2 7/8	2 7/8
21321	2	1 3/4	4 1/4 x 9 3/4	19	26	2 OD	2 7/8	2 7/8
22518	3	1 3/4	4 1/4 x 9 3/4	19	26 3/4	1 3/4 AS		2 7/8
21322	2	1 3/4	4 1/4 x 9 3/4	19	29	1 3/4 OD	2 7/8	2 7/8
21323	2	1 3/4	4 1/4 x 9 3/4	19	29	1 3/4 OD	2 7/8	2 7/8
21032	1	1 3/4	4 1/4 x 9 3/4	20	24	2		
22639	11	1 3/4	4 1/4 x 9 3/4	20	24	2	2 7/8	
21393	3	1 3/4	4 1/4 x 9 3/4	20	37 3/8	2 AS OD	2 7/8	
21127	2	1 3/4	4 1/4 x 9 3/4	21	24	1 3/4	2 7/8	2 7/8
22519	2	1 3/4	4 1/4 x 9 3/4	21	24	1 3/4	2 7/8	2 7/8
21320	2	1 3/4	4 1/2 x 9 3/4	19	26	2 OD	2 7/8	2 7/8
21077	11	1 3/4	4 1/2 x 11	15	22	2 AS	3	
22720	11	1 3/4	4 1/2 x 11	15	22	1 3/4 AS	3	
22721	11	1 3/4	4 1/2 x 11	15	22	1 7/8	3	
22453	2	1 3/4	5	18	23	1 3/4 OD	1 1/4	1 1/4
21335	#	1 3/4	5 x 8	20 1/2	34	1 3/4	2 1/2	
21140	2	1 3/4	5 1/2 x 11	12	21	1 3/4 OD		3 1/2
22441	11	1 3/4	5 1/2 x 11	13	15 1/2	1 3/8	3 3/4	
22546	12	1 3/4	5 1/2 x 11	13	15 1/2	1 3/8	3 3/4	3 3/4
22593	11	1 3/4	5 1/2 x 11	13	15 1/2	1 3/4	3 3/4	
22783	11	1 3/4 WF	5 1/2 x 11	13	32 3/8	1 3/4 AS	3 3/4	
22544	12	1 3/4	5 1/2 x 11	14	19 1/2	1 1/2 AS	3 3/4	3 3/4
22473	12	1 3/4	5 1/2 x 11	15	24	1 7/8 AS	3 3/4	3 3/4
22752	12	1 3/4	5 1/2 x 11	16	19 1/2	1 3/4 (2) OD	1 1/2	1 1/2
22407	6	1 3/4	5 1/2 x 11	16	20 1/2	1 3/4 AS		3 3/4
22406	11	1 3/4	5 1/2 x 11	16	21 1/2	2 AS	3 3/4	
22404	11	1 3/4	5 1/2 x 11	18	21	2	3 3/4	
22472	11	1 3/4	5 1/2 x 11	18	21	2	3 3/4	
22474	12	1 3/4	5 1/2 x 11	18	24	1 3/4	3 3/4	3 3/4
22597	11	1 3/4	5 1/2 x 11	18	25	1 7/8 AS	3 3/4	
21105	2	1 3/4	5 1/2 x 11	18	27 1/2	1 3/8 OD	3 3/4	3 3/4
22737	12	1 3/4	5 1/2 x 11	18	30 1/2	1 1/2	3 3/4	1 1/2
22248	4	1 3/4	6	13	16 1/2	1 3/4	1 1/2	1 1/2
22243	2	1 3/4	6	15	18	1 3/4	1 1/2	1 1/2
22454	2	1 3/4 WF	6	18	33 1/2	2 1/2 CT	1 1/2	1 1/2
22455	2	1 3/4 WF	6	18	33 1/2	2 1/2 CT	1 1/2	1 1/2
22116	2	1 3/4	6	19	23	1 3/4	1 1/2	1 1/2
22331	2	1 3/4	6	19	30	2 AS	1 1/2	1 1/2
22484	2	1 3/4	6	20	25 1/2	1 3/4	1 1/2	1 1/2
21512	2	1 3/4	6	22	30	1 3/4 OD	1 1/2	1 1/2
22200	2	1 3/4	7	11	14	1 1/2	2 1/4	2 1/4
22252	2	1 3/4	7	12	15 1/2	1 3/4	2 1/4	2 1/4
22569	11	1 3/4	7	14	17	1 1/2	1 1/2	2 1/4
22750	12	1 3/4	7	14	29	1 1/2 (2) OD	2	1 1/8, 1 3/4
22489	2	1 3/4	7	16	23 1/2	1 7/8 AS	2 1/4	2 1/4
22487	12	1 3/4	7	16	23 3/4	1 1/2 AS	2 1/4	2 1/4
22495	12	1 3/4	7	16	24 1/2	1 1/2 (2) OD	1 1/2	1 1/2
22308	2	1 3/4	7	16	26 1/2	1 7/8 OD	1 1/2	1 1/2
22749	2	1 3/4	7	19	22	1 3/4	1 3/4	1 3/4
22729	2	1 3/4	7 x 9	12	15	1 1/2	2	2
22756	1	1 3/4	7 x 9	12	17 1/2	1 1/2	1 1/2	
22718	18	1 3/4	7 x 9	13	22 7/8	1 3/4	2 5/8	
22705	2	1 3/4	7 x 9	14	26 1/2	1 3/4 AS	2 5/8	2 5/8
22650	2	1 3/4	7 x 9	15	18	1 7/8	1 3/4	1 3/4
22710	11	1 3/4	7 x 9	15	28 1/4	1 5/8 AS	2 5/8	
21080	2	1 3/4	7 x 9	16	23	1 3/4 AS	2 5/8	2 5/8
22591	12	1 3/4	7 x 9	16	23 3/4	1 1/2 AS	2 5/8	2 5/8
21528	2	1 3/4	7 x 9	18	31	2	1 3/4	1 3/4

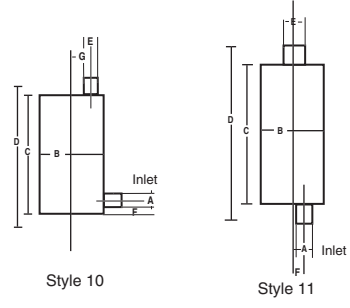
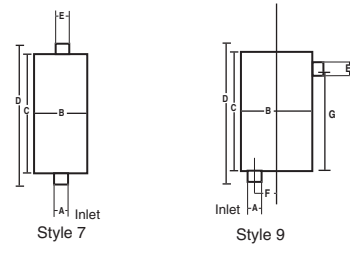
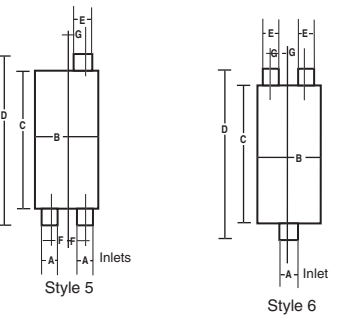
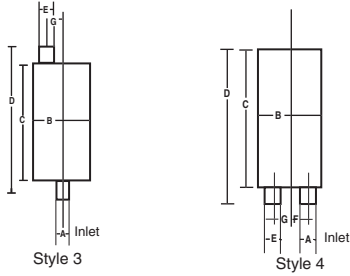
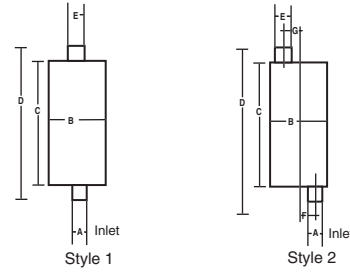

- ▲ Arc Welded.
- † Double-Wall.
- ◆ Spark Arrestor.
- Welded Heat Shield.
- ↕ Resonator.
- # Special Style, not shown.
- @ Stainless.
- ‡ Threaded.
- § Tractor.
- AS Aluminized Spout.
- CT Chrome Tip
- SB Spherical Ball.
- SF Spherical Flare Loose Flange.
- SP Spout.
- ST Stainless Tip
- WF Welded Flange.
- WP Welded Pipe.
- WS Welded Spout.

TABLE 2 - MUFFLER SPECIFICATIONS BY INLET SIZE

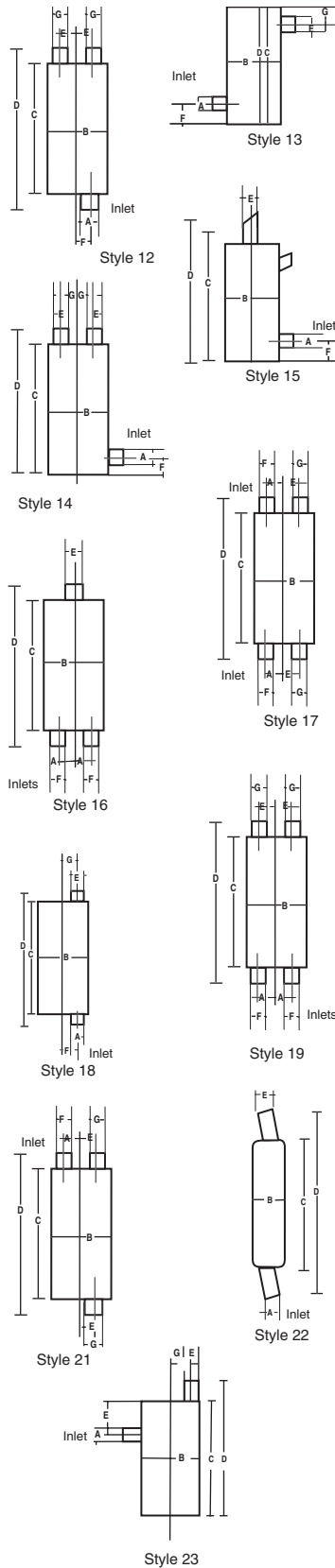

Part No.	Style	Inlet ID (A)	Shell Dia. (B)	Shell Length (C)	Overall Length (D)	Outlet ID (E)	Inlet Offset (F)	Outlet Offset (G)
21129	#	1 3/4	SPECIAL	20	25 1/4	1 3/4		
21130	11	1 5/8 WF	4 1/4 x 8 13/16	12	23 1/2	1 5/8		
22035§	1	1 7/8	3 3/4	15	18	1 5/16 OD		
22024§	9	1 7/8	3 3/4	17 3/8	18 1/2	1 3/8 OD		1 5/8
22327	3	1 7/8	3 1/4 x 7 3/4	16	19 1/4	1 1/2		2 1/2
22415□	1	1 7/8 WF	3 1/2	12	18 1/2	1 1/2		
24228	4	1 7/8	4	12	16	3 OD		
22281	1	1 7/8	4	18	21	1 7/8		
22302	1	1 7/8	4	18	23	1 7/8		
22369	2	1 7/8	4 x 8	11	17 1/2	1 7/8 SF	2 1/2	2 1/2
22370	2	1 7/8	4 x 8	11	17 1/2	1 7/8 SF	2 1/2	2 1/2
22923§	1	1 7/8	4 1/8 x 9	18	48 1/2	2 OD		
22922§	1	1 7/8	4 1/8 x 9	26	41	2 OD		
22023§	1	1 7/8	4 1/4	12 5/8	18	1 1/2		
22601	1	1 7/8	4 1/4 x 8 13/16	16	19	1 7/8		
22478	2	1 7/8	4 1/4 x 8 13/16	16	19 1/2	1 7/8	2 5/8	2 5/8
21934	11	1 7/8	4 1/4 x 8 13/16	17	22	1 7/8	2 5/8	
22432	3	1 7/8	4 1/4 x 8 13/16	19	23	1 15/16 OD		2 5/8
22332	4	1 7/8	4 1/4 x 9 3/4	13	15	1 3/4		2 7/8
22568	11	1 7/8	4 1/4 x 9 3/4	13	21 1/2	1 7/8 AS	2 7/8	
22451	11	1 7/8	4 1/4 x 9 3/4	14	16 1/2	1 7/8	2 7/8	
21896	11	1 7/8	4 1/4 x 9 3/4	17	20	1 3/4	2 7/8	
22071	11	1 7/8	4 1/4 x 9 3/4	17	20	2	2 7/8	
22618	2	1 7/8	4 1/4 x 9 3/4	17	20 1/4	1 3/4	3	3
22343	11	1 7/8	4 1/4 x 9 3/4	18	22 1/4	2 1/4	2 7/8	
22649	12	1 7/8	4 1/4 x 9 3/4	20	23	1 1/2	2 7/8	2 7/8
22438§	1	1 7/8	4 5/8	17 1/2	22 1/2	1 7/8		
22371	1	1 7/8	5	16 3/4	29 1/2	1 7/8 OD		
22372	1	1 7/8	5	16 3/4	29 1/2	1 7/8 OD		
22491	1	1 7/8	5	17	22	1 7/8 OD		
22280	2	1 7/8	5	19	26 1/2	1 7/8 AS	1 1/4	1 1/4
22301	2	1 7/8	5	21	27 1/2	1 7/8 OD	1 1/4	1 1/4
21419	11	1 7/8	5 1/2 x 11	15	29 5/32	2		
21418	11	1 7/8	5 1/2 x 11	15	29 5/16	2		
21128	12	1 7/8	5 1/2 x 11	18	27 1/2	1 7/8 AS	3 3/4	3 3/4
22444§	1	1 7/8	5 5/8	17	28 3/4	2 OD		
21849	2	1 7/8	6	10	14 1/2	1 3/4	1 1/2	1 1/2
22659	2	1 7/8	6	16	19	1 7/8	1 1/2	1 1/2
22321	2	1 7/8	6	16	19 1/2	2	1 1/2	1 1/2
22400	2	1 7/8	6	18	26	2 AS	1 1/2	1 1/2
21949	2	1 7/8	6	22	26 1/2	2 OD	1 1/2	1 1/2
22797	12	1 7/8	7	15	24 3/8	1 1/2 AS	2 1/4	2 1/4
22748	12	1 7/8	7	16	29 1/8	1 3/4 (2)	1 3/4	1 3/4
22565	2	1 7/8	7 x 9	14	17	1 7/8	2 5/8	2 5/8
21381	2	1 7/8	7 x 9	14	17 1/4	2 1/4	1 5/8	1 5/8
21382	2	1 7/8	7 x 9	14	17 1/4	2 1/4	1 5/8	1 5/8
21433	2	1 7/8	7 x 9	14	28	2 1/4 AS	1 5/8	1 5/8
21434	2	1 7/8	7 x 9	14	28	2 1/4 AS	1 5/8	1 5/8
21502	2	1 7/8	7 x 9	14	28 7/8	2 OD	2 5/8	1 5/8
21503	2	1 7/8	7 x 9	14	28 7/8	2 OD	2 5/8	1 5/8
22754	2	1 7/8	7 x 9	15	18	1 3/4	1 5/8	1 5/8
22746	2	1 7/8	7 x 9	16	18	1 3/4	2	1 5/8
22753	12	1 7/8	7 x 9	18	19 1/2	1 1/2 (2)	1 5/8	1 5/8
22520	12	1 7/8	7 x 9	18	27 1/2	1 1/2 AS	2 5/8	2 5/8
22529	2	1 7/8	7 x 9	18	27 1/2	1 1/2 AS	2 5/8	2 5/8
22588	1	1 11/16 WF	5	14	21 1/2	1 3/4		
21281	1	2	3	14 1/4	17 3/4	1 3/4		
24041	22	2	3 1/2	14	20	2	1 1/4	1 1/4
24038	22	2	3 1/2	14	22	1 3/4		
24099	22	2	3 1/2	18	23 3/4	2	1 1/4	1 1/4
24065	22	2	3 1/2	18	24	1 7/8		
22486	1	2	3 1/2	18	27 1/2	2 AS		
22158	1	2	3 1/2	18	28 1/2	2 AS		
24081	22	2	3 1/2	20	25	2	1 3/8	1 3/8
24102	22	2	3 1/2	20	25	2	2 1/2	2 1/2
24200	1	2	3 1/2	20	25	2		
24202	1	2	3 1/2	22	27	2		

- ▲ Arc Welded.
- † Double-Wall.
- ◆ Spark Arrestor.
- Welded Heat Shield.
- ✦ Resonator.

- # Special Style, not shown.
- @ Stainless.
- ‡ Threaded.
- § Tractor.

- AS Aluminized Spout.
- CT Chrome Tip.
- SB Spherical Ball.
- SF Spherical Flare Loose Flange.
- SP Spout.

- ST Stainless Tip.
- WF Welded Flange.
- WP Welded Pipe.
- WS Welded Spout.

INFORMATION & BUILD TO ORDER
 TOOLS AND ACCESSORIES
 SCHOOL BUS
 MEDIUM DUTY TRUCK GVV 3-6
 HEAVY DUTY TRUCK GVV 7-8
 APPLICATION BY ENGINE
 NOISE AND BACKPRESSURE DATA
 TRACTOR
 MUFFLER SPECS
 O.E. CROSS INDEX

TABLE 2 - MUFFLER SPECIFICATIONS BY INLET SIZE

Part No.	Style	Inlet ID (A)	Shell Dia. (B)	Shell Length (C)	Overall Length (D)	Outlet ID (E)	Inlet Offset (F)	Outlet Offset (G)
24204	1	2	3½	26	31	2		
24042	22	2	3½	30	34	2	1½	1½
22047§	1	2	3¼	15	17¼	1¾		
22530	1	2	3¼ x 7¾	8	11	2		
22492	1	2	3¼ x 7¾	9	11½	2	2½	2½
22385□	11	2	3¼ x 7¾	9	12	2	2½	
21598	2	2	3¼ x 7¾	11	15½	2¼	2½	2½
21535	11	2	3¼ x 7¾	15	19	2	2½	
22599	16	2	3¼ x 7¾	15	19	2¼	2½	2½
21314	3	2	3¼ x 7¾	27	33¾	1½ OD		2½
21395	4	2	3¼ x 7¾	28	31	2		2½
22652	1	2	4	8	16½	2		
21132	1	2	4	11¼	24	2 AS		
21133	1	2	4	11¼	24	2 AS		
21188§	1	2	4¼	12¾	17	2		
22543	18	2	4¼ x 8½	12	15	2	2½	2½
22149□	11	2	4¼ x 8½	12	18	1¾	2½	
22339	3	2	4¼ x 8½	13	17½	2½		2½
22360	2	2	4¼ x 8½	14	17¼	2	2½	2½
22627	12	2	4¼ x 8½	15	19¾	1½ AS	2½	2½
21354	2	2	4¼ x 8½	16	19	2	2½	2½
22607	6	2	4¼ x 8½	16	19	1¾		2½
21885	11	2	4¼ x 8½	16	20¾	2	2½	
22430	11	2	4¼ x 8½	16	21	2 OD	2½	
21064	3	2	4¼ x 8½	18	21	2	½	2½
22242	2	2	4¼ x 8½	20	24	2	2½	2½
22542	18	2	4¼ x 9¾	11	13	2	2½	2½
22561	2	2	4¼ x 9¾	12	18	2½ WF	3	3
22435	3	2	4¼ x 9¾	13	16¼	2¼		2½
22742	11	2	4¼ x 9¾	14	17	1½ OD	2½	
22497	2	2	4¼ x 9¾	14	17½	1½	2½	2½
22526	21	2	4¼ x 9¾	14	19½	1½	2½	
22282□	2	2	4¼ x 9¾	15	18	2	2½	2½
22463□	2	2	4¼ x 9¾	15	18½	1¾	2½	2½
21316	11	2	4¼ x 9¾	15	29	2 OD	3	
22602	2	2	4¼ x 9¾	16	19	1¾	2½	2½
21199	2	2	4¼ x 9¾	16	19½	2 OD	2½	2½
22386□	2	2	4¼ x 9¾	16	19½	2	2½	2½
21317	11	2	4¼ x 9¾	16	29	2 OD	3	
22326	12	2	4¼ x 9¾	17	20¼	2	2½	2½
22608	12	2	4¼ x 9¾	17	20¼	2	2½	2½
22611	12	2	4¼ x 9¾	17	20¼	2	2½	2½
22325	11	2	4¼ x 9¾	17	20½	2	2½	
22464□	2	2	4¼ x 9¾	17	20½	1½	2½	2½
22510	11	2	4¼ x 9¾	17	26	1¾ AS	2½	
22535	12	2	4¼ x 9¾	17	26	1½ AS	2½	2½
22479	12	2	4¼ x 9¾	17	27	2 AS	2½	2½
22496	2	2	4¼ x 9¾	18	21¾	1½	2½	2½
22129	11	2	4¼ x 9¾	18	22	2¼	2½	
22425	12	2	4¼ x 9¾	18	26	1½ AS	2½	2½
22736	11	2	4¼ x 9¾	18	27½	1¾	2½	
22184	11	2	4¼ x 9¾	18	30	1¾ AS	2½	
22614	19	2	4¼ x 9¾	18	32¾	2 ST	2½	2½
22605	11	2	4¼ x 9¾	18	33½	2 AS	2½	
22417	11	2	4¼ x 9¾	18	33½	2 AS	2½	
22418	12	2	4¼ x 9¾	18	33½	2 AS	2½	2½
21311	12	2	4¼ x 9¾	19	21¾	1½ (2)	2½	0, 2½
22352	2	2	4¼ x 9¾	19	22	2	2½	2½
22157	2	2	4¼ x 9¾	19	23	2	2½	2½
22283□	2	2	4¼ x 9¾	19	23	2	2½	2½
22318	2	2	4¼ x 9¾	19	23	2	2½	2½
21479	11	2	4¼ x 9¾	19	23½	2 OD	2½	
22052	11	2	4¼ x 9¾	19	23¾	2	2½	
22105	2	2	4¼ x 9¾	19	24½	2	2½	2½
22359	11	2	4¼ x 9¾	19	24½	2	2½	
22559	2	2	4¼ x 9¾	19	24½	2	2½	2½
22560	2	2	4¼ x 9¾	19	24½	2	2½	2½

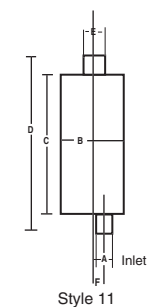
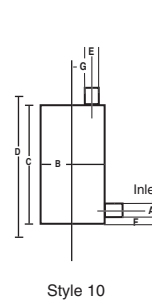
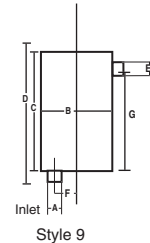
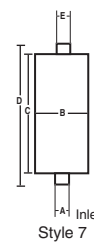
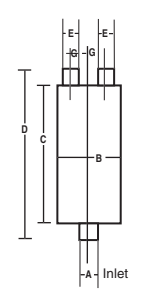
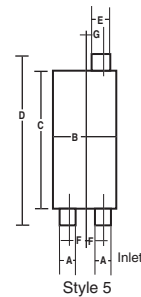
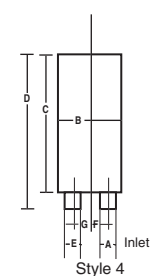
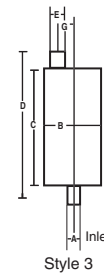
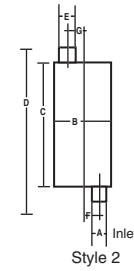
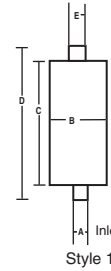

- ▲ Arc Welded.
- † Double-Wall.
- ◆ Spark Arrestor.
- Welded Heat Shield.
- ↕ Resonator.

- # Special Style, not shown.
- @ Stainless.
- ‡ Threaded.
- § Tractor.

- AS Aluminized Spout.
- CT Chrome Tip
- SB Spherical Ball.
- SF Spherical Flare Loose Flange.
- SP Spout.

- ST Stainless Tip
- WF Welded Flange.
- WP Welded Pipe.
- WS Welded Spout.

TABLE 2 - MUFFLER SPECIFICATIONS BY INLET SIZE

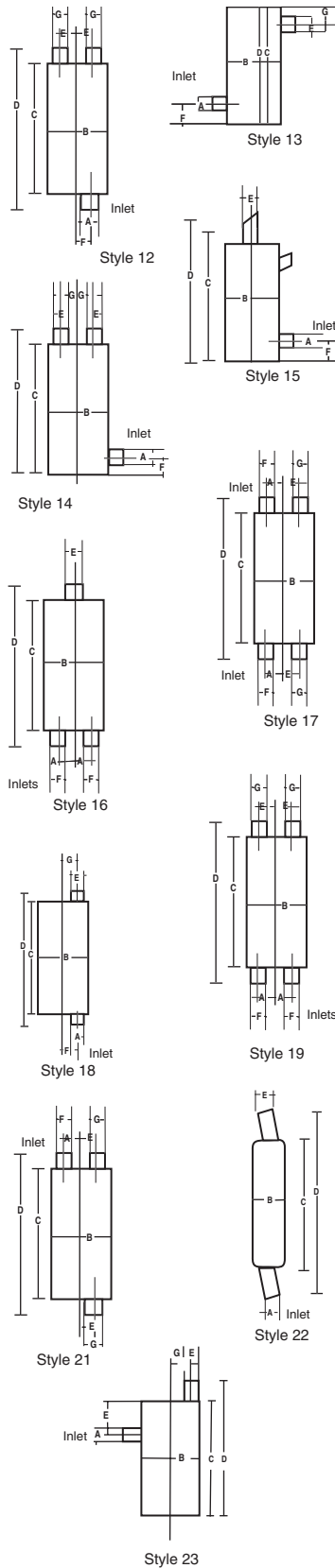

Part No.	Style	Inlet ID (A)	Shell Dia. (B)	Shell Length (C)	Overall Length (D)	Outlet ID (E)	Inlet Offset (F)	Outlet Offset (G)
22621	2	2	4¼ x 9¾	19	24½	2	2⅞	2⅞
22622	2	2	4¼ x 9¾	19	24½	2	2⅞	2⅞
21279	2	2	4¼ x 9¾	19	27	2 OD	2⅞	2⅞
21280	2	2	4¼ x 9¾	19	29	2 OD	2⅞	2⅞
21037	11	2	4¼ x 9¾	20	24	2	2⅞	
21201	#	2	4¼ x 9¾	20	24	2		
21438	11	2	4¼ x 9¾	20	24¾	2 WF	2⅞	
21343	11	2	4¼ x 9¾	20	25¼	2	2⅞	
21435	11	2	4¼ x 9¾	20	27¾	2 WF	2⅞	
21441	11	2 OD	4¼ x 9¾	20	27¾	2 WF	2	
21440	11	2	4¼ x 9¾	20	27¾	2 WF	2	
21342	3	2	4¼ x 9¾	20	29	2 OD	2⅞	
21115	11	2	4¼ x 9¾	20	32⅞	2 AS	2⅞	
21123	11	2	4¼ x 9¾	20	33¾	1¾ AS	2⅞	
21121	16	2	4¼ x 9¾	20	41½	2 ST	2⅞	
21190	11	2	4¼ x 9¾	21	25½	2	2⅞	
21192	11	2	4¼ x 9¾	21	25½	2 OD	2⅞	
21782	11	2	4¼ x 9¾	21	25½	2	2⅞	
22557	1	2	4¼ x 9¾	21	29½	2		
22362	11	2	4¼ x 9¾	21	32¼	2 AS	2⅞	
22299	4	2	4¼ x 9¾	22	24	2	2⅞	2⅞
22793	11	2	4¼ x 9¾	22	25	2	2⅞	
22790	11	2	4¼ x 9¾	22	26	2	2⅞	
22645	#	2	4¼ x 9¾	26	27½	1½		
21353	11	2	4¼ x 9¾	32	25	2	2⅞	
24229	4	2	4½	12	16	3½ OD		
21480	11	2	4½ x 11	13	24½	2 OD	3½	
22522	11	2	4½ x 11	16	27	2 AS	3	
22507	2	2	4½ x 11	20	23½	2	3	3
21039§	1	2	4⅝	15½	28⅞	2		
22234	1	2	5	10	13	2		
22346	2	2	5	18	21	2	1¼	1¼
22443	2	2	5	18	21	2	1¼	1¼
22445	2	2	5	18	21	2	1¼	1¼
22436	2	2	5	21	24	2	1¼	1¼
22450	2	2	5	21	24	2	1¼	1¼
21028	1	2	5	21	25¾	1⅜ OD		
22620	6	2	5½ x 11	12	18	1½ AS		3¾
22619	6	2	5½ x 11	12	18½	1½ AS		3¾
21141	2	2	5½ x 11	12	21	2 OD		3½
22751	#	2	5½ x 11	12	21⅞	2 (2) OD	1½	
21505	11	2	5½ x 11	13	24½	2 OD	3½	
22651	2	2	5½ x 11	14	17	2	3¾	3¾
22493	6	2	5½ x 11	14	20	1½ AS		3¾
21252	11	2	5½ x 11	15	16½	2 OD	3¾	1
21525	11	2	5½ x 11	15	21¼	2¼ OD	3½	
21398	11	2	5½ x 11	15	21¼	2¼	3½	
22540	12	2	5½ x 11	15	26	2 AS	3	3
21203	2	2	5½ x 11	15	26⅞	2¼ OD	3¾	1
21209	2	2	5½ x 11	15	26⅞	2¼ OD	3¾	1
21341	12	2	5½ x 11	15	29	2¼ OD	3½	
22408	6	2	5½ x 11	16	22½	1⅞ AS		3¾
22409	11	2	5½ x 11	16	24	1¾ AS	3¾	
21198	2	2	5½ x 11	16	26⅞	2¼ OD	3¾	1
22461	11	2	5½ x 11	16	27	2 OD	3	
22426	6	2	5½ x 11	16	27½	1¼ AS		3¾
21250	11	2	5½ x 11	16	27¾	2 OD	3¾	1
21126	12	2	5½ x 11	17	27	1½ ST	3¾	3¾
22706	11	2 WF	5½ x 11	17	30¼	2 AS	3¾	
22476	11	2	5½ x 11	18	21	2	3¾	
22757	2	2	5½ x 11	18	24½	2 AS	3¾	3¾
22521	6	2	5½ x 11	18	25	1⅞ AS		3¾
22704	6	2	5½ x 11	18	25	1⅞ AS		3¾
21284	11	2	5½ x 11	18	29	1¾ OD	3½	
21285	11	2	5½ x 11	18	30¼	2 (2) OD	3½	
22734	12	2	5½ x 11	19	29¾	1½	3¾	1½
21328	11	2	5½ x 11	19	30	2 OD	3¾	1

- ▲ Arc Welded.
- † Double-Wall.
- ◆ Spark Arrestor.
- Welded Heat Shield.
- ✦ Resonator.

- # Special Style, not shown.
- @ Stainless.
- ‡ Threaded.
- § Tractor.

- AS Aluminized Spout.
- CT Chrome Tip.
- SB Spherical Ball.
- SF Spherical Flare Loose Flange.
- SP Spout.

- ST Stainless Tip.
- WF Welded Flange.
- WP Welded Pipe.
- WS Welded Spout.

INFORMATION & BUILD TO ORDER
TOOLS AND ACCESSORIES
SCHOOL BUS
MEDIUM DUTY TRUCK GVV 3-6
HEAVY DUTY TRUCK GVV 7-8
APPLICATION BY ENGINE
NOISE AND BACKPRESSURE DATA
TRACTOR
MUFFLER SPECS
O.E. CROSS INDEX

TABLE 2 - MUFFLER SPECIFICATIONS BY INLET SIZE

Part No.	Style	Inlet ID (A)	Shell Dia. (B)	Shell Length (C)	Overall Length (D)	Outlet ID (E)	Inlet Offset (F)	Outlet Offset (G)
21135	11	2	5½ x 11	19	30½	2 OD	3¾	1
21081	12	2	5½ x 11	19	32	1½ CT	3¾	3¾
21182	11	2	5½ x 11	19	36½	2 OD	1½	
22755	14	2 WF	5½ x 11	20	21¼	1¾ (2) OD	1½	
22661	10	2 WF	5½ x 11	20	22	2		
21494	2	2	5½ x 11	20	23	2 OD	3½	3½
21207	11	2	5½ x 11	20	34	2 OD	3	
21304	11	2	5½ x 11	20	37	2 OD	3	
21305	11	2	5½ x 11	20	37	2 OD	3	
21118	14	2 WF	5½ x 11	20	38	1¾ AS		3¾
21268	11	2	5½ x 11	20	38	WS	3½	
21263	11	2	5½ x 11	20	38	WS	3½	
21264	11	2	5½ x 11	20	38	WS	3½	
21265	11	2	5½ x 11	20	38	WS	3½	
21266	11	2	5½ x 11	20	39	WS	3½	
21267	11	2	5½ x 11	20	39	WS	3½	
21430	11	2	5½ x 11	29	36⅝	2	3½	
22658§	10	2	5⅝	22½	26	2½ OD	2	
21578◆	7	2	6	5⅝	11	2		
22065	2	2	6	13	19	2 OD	1½	1½
22766‡▲	1	2	6	15	20¼	2		
22285	2	2 WF	6	15	20¾	1¾	1½	1½
22323	2	2	6	16	19½	2	1½	1½
22660	2	2	6	17	20	2	1½	1½
22641	12	2	6	17	28	2 AS	1½	1½
22554	2	2	6	18	21	2	1½	1½
22585	2	2	6	18	21	2	1½	1½
21874	2	2	6	18	28	2 OD	1½	1½
22336	2	2	6	19	32¾	2 AS	1½	1½
21331	2	2	6	20	27	1⅜ OD	1½	1½
22506	2	2	6	21	24	2	1½	1½
22625	2	2	6	21	24	2	1½	1½
21169▲	2	2	6	22½	29	2	1⅝	1⅝
22361	2	2	6	25	29	2	1½	1½
21444	2	2	6	25	31½	2 OD	1½	1½
21287	2	2	6	26	33	2	1½	1½
22456	12	2	7	13	17½	1½ AS	2¼	2¼
22342	2	2	7	16	23½	1⅞ AS	2¼	2¼
21030	2	2	7	17	20½	2	2¼	2¼
21062	12	2	7	17	30½	1⅞ AS	2¼	2¼
22286	2	2	7	18	21	2	1¾	1¾
22384	2	2	7	20	24	2	1¾	1¾
22603▲	2	2	7	20	24½	2	1⅝	1⅝
22670	2	2	7	20	25	2	1¾	1¾
22483	2	2	7	21	24	2	1¾	1¾
22494	2	2	7	21	24	2	1¾	1¾
22358	2	2	7	25	28	1¾	2¼	2¼
22531	2	2	7	25	29	2 OD	1¾	1¾
21500	11	2 WP	7 x 9	12	26¾	2 AS		
21501	11	2 WP	7 x 9	12	27	2 AS		
22708	3	2	7 x 9	13	19¾	2 AS		2⅝
22709	3	2	7 x 9	13	19¾	2 AS		2⅝
21108	11	2	7 x 9	13	21	1¾ AS	2⅝	
22711	3	2	7 x 9	13	21	1⅞ AS		2⅝
22712	3	2	7 x 9	13	21	1⅞ AS		2⅝
22616	3	2	7 x 9	13	21⅝	2 AS		2⅝
22617	3	2	7 x 9	13	21⅝	2 AS		2⅝
22516	3	2	7 x 9	13	21¼	2 AS		2⅝
22328□	3	2	7 x 9	13	22½	1⅞ AS		2⅝
21136	11	2	7 x 9	14	17½	1⅞	2⅝	
21407	2	2	7 x 9	14	28⅜	2	1⅝	2⅝
21408	2	2	7 x 9	14	28 ²¹ / ₃₂	2	2⅝	2⅝
21319	#	2	7 x 9	14	32	2¼ OD	2⅝	1⅝
22553	12	2	7 x 9	15	23	1½ AS	2⅝	2⅝
22600	11	2	7 x 9	15	23	1⅞ AS	2⅝	
21318	#	2	7 x 9	15	28	2¼ OD	2⅝	1⅝
21124	2	2	7 x 9	17	21	2 AS	2⅝	2⅝

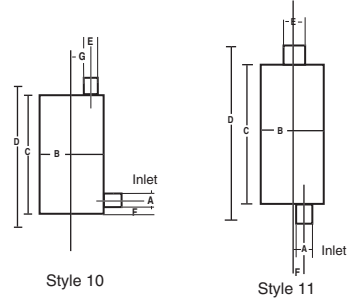
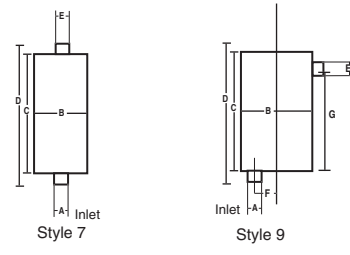
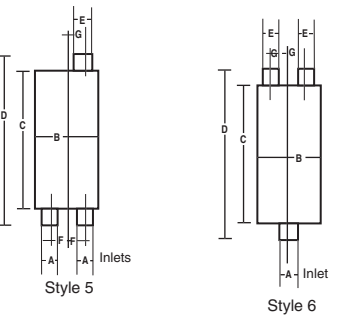
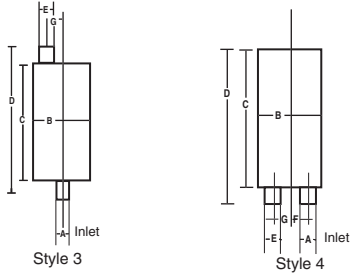
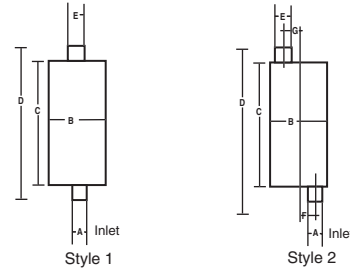

- ▲ Arc Welded.
- † Double-Wall.
- ◆ Spark Arrestor.
- Welded Heat Shield.
- ↕ Resonator.
- # Special Style, not shown.
- @ Stainless.
- ‡ Threaded.
- § Tractor.
- AS Aluminized Spout.
- CT Chrome Tip
- SB Spherical Ball.
- SF Spherical Flare Loose Flange.
- SP Spout.
- ST Stainless Tip
- WF Welded Flange.
- WP Welded Pipe.
- WS Welded Spout.

TABLE 2 - MUFFLER SPECIFICATIONS BY INLET SIZE

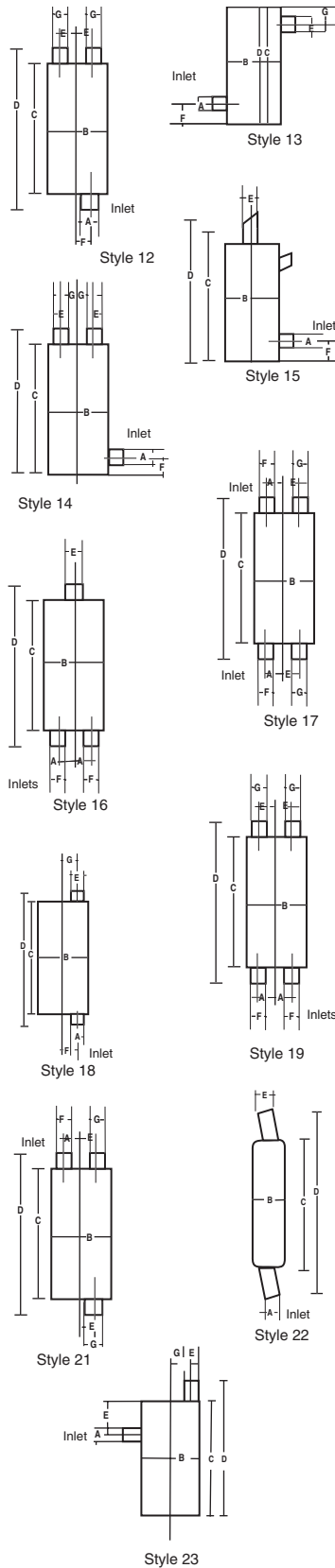

Part No.	Style	Inlet ID (A)	Shell Dia. (B)	Shell Length (C)	Overall Length (D)	Outlet ID (E)	Inlet Offset (F)	Outlet Offset (G)
21125	2	2	7 x 9	17	21	2 AS	2 5/8	2 5/8
21038	3	2	7 x 9	18	21	1 3/4		2 5/8
22795	3	2	7 x 9	18	21	1 3/4		2 5/8
21112	6	2	7 x 9	19	29 1/2	1 3/4 AS		2 5/8
21094	6	2	7 x 9	19	31 1/2	1 3/4 CT		2 5/8
21106	12	2	7 x 9	19	33	1 3/4 CT	2 5/8	2 5/8
21196	2	2	7 x 9	20	26 1/2	2 OD	2 5/8	2 5/8
22562	2	2	7 x 9	20	29 1/2	2 1/8 AS	2 5/8	2 5/8
22646	1	2	7 x 9	21	25	2		
21289	5	2	7 x 9	22	26	2 3/4 OD	1 5/8	1 5/8
21291	5	2	7 x 9	22	26	2 3/4 OD	1 5/8	1 5/8
21504	5	2	7 x 9	22	26	2 3/4 OD	1 5/8	1 5/8
21324	4	2	7 x 9	22	30 13/16	2	2	2
21282	5	2	7 x 9	24	29	2 3/4 OD		2 5/8
22109§	1	2 1/8	4 1/4	15 1/4	21	1 7/8 OD		
22434□	2	2 1/8 WF	4 1/4 x 8 13/16	18	21 1/4	1 3/4	2 5/8	2 5/8
22528	2	2 1/8 WF	4 1/4 x 8 13/16	18	22 3/8	2	2 5/8	2 5/8
24230	4	2 1/8	4 1/2	12	16	3 1/2 OD		
21183	#	2 1/8 WF OD	5 1/2 x 11	19	39	SP	3 3/4	1
21034	4	2 1/8	7 x 9	17	19	2		2 5/8
21048	2	2 1/4	3 1/4 x 7 3/4	8	12 1/2	3 SB	2 1/2	2 1/2
21049	2	2 1/4	3 1/4 x 7 3/4	8	12 1/2	2 1/4 SB	2 1/2	2 1/2
22623	1	2 1/4	3 1/4 x 7 3/4	11	16 1/4	2 1/4		
21358	16	2 1/4	3 1/4 x 7 3/4	16	21 1/2	2 1/4 OD	1 1/2 (2)	
24098	22	2 1/4	3 1/2	14	21 3/4	2 1/4	1 1/4	1 1/4
24100	22	2 1/4	3 1/2	14	21	2	1	1
24049	22	2 1/4	3 1/2	18	24 1/2	2	1 1/4	1 1/4
24057	22	2 1/4	3 1/2	18	23 1/2	2		
24069	1	2 1/4	3 1/2	18	23	2 1/4		
24047	22	2 1/4	3 1/2	20	25	2	2 1/2	2 1/2
24051	22	2 1/4	3 1/2	20	27 3/8	2		
24095	22	2 1/4	3 1/2	20	26	2 1/4	1 3/8	1 3/8
24201	1	2 1/4	3 1/2	20	25	2 1/4		
24239@	1	2 1/4	3 1/2	20	25	2 1/4		
24203	1	2 1/4	3 1/2	22	27	2 1/4		
24090	22	2 1/4	3 1/2	24	29 3/8	2 1/4	1 3/4	1 3/4
24205	1	2 1/4	3 1/2	26	31	2 1/4		
24030	22	2 1/4	3 1/2	30	34	2	1 1/2	1 1/2
21122	1	2 1/4	4	11 1/4	22 1/2	2 1/2 AS		
24234	1	2 1/4	4	12	16 1/2	2 1/4		
22545	1	2 1/4	4	14	25	2 1/4 AS		
21992	1	2 1/4	4	15	28 1/2	2 1/4 AS		
21687	1	2 1/4	4	16	21	2 1/4		
21042	1	2 1/4	4	18	26 3/4	2 1/4 AS		
22796	1	2 1/4	4	18	22	2 1/4		
24235	1	2 1/4	4	18	23 1/4	2 1/4		
24211	1	2 1/4	4	30	35	2 1/4		
24212	1	2 1/4	4	40	45	2 1/4		
21102▲	11	2 1/4	4 1/8 x 9	16	27 1/4	2 1/4	2 7/8	
21104	11	2 1/4	4 1/8 x 9	19	24	2	2 7/8	
22038§	1	2 1/4	4 1/4	13	17	2 1/4 OD		
21033§	1	2 1/4	4 1/4	22 1/2	26 3/4	2 1/4		
22348□	2	2 1/4	4 1/4 x 8 13/16	13	16	2 1/4	2 5/8	2 5/8
22440□	2	2 1/4	4 1/4 x 8 13/16	15	18	2 1/4	2 5/8	2 5/8
21277	2	2 1/4	4 1/4 x 8 13/16	16	18 1/2	2 1/4	2 5/8	2 5/8
21278	2	2 1/4	4 1/4 x 8 13/16	16	18 1/2	2 1/4	2 5/8	2 5/8
22431	11	2 1/4	4 1/4 x 8 13/16	16	21	2 1/4 OD	2 5/8	
21325	11	2 1/4 WF	4 1/4 x 8 13/16	28	33 3/4	2 1/4	2 5/8	
22990	11	2 1/4 WF	4 1/4 x 8 13/16	28	41 1/4	2 1/4	2 5/8	
21031	11	2 1/4	4 1/4 x 9 3/4	13	23	1 7/8	2 7/8	
22703	12	2 1/4	4 1/4 x 9 3/4	13	24	1 1/2 CT	2 7/8	2 7/8
21362	11	2 1/4	4 1/4 x 9 3/4	14	24 1/2	2 1/4 OD	2 7/8	
21372	11	2 1/4	4 1/4 x 9 3/4	14	25	2 1/4 OD	2 7/8	
22324	6	2 1/4	4 1/4 x 9 3/4	14	20 3/4	2 1/4 AS		2 7/8
22396	12	2 1/4	4 1/4 x 9 3/4	14	29 1/4	2 1/2 AS	2 7/8	2 7/8
22397	12	2 1/4	4 1/4 x 9 3/4	14	29 1/4	2 1/2 AS	2 7/8	2 7/8
22579	2	2 1/4	4 1/4 x 9 3/4	14	17 1/2	1 7/8	2 7/8	2 7/8

- ▲ Arc Welded.
- † Double-Wall.
- ◆ Spark Arrestor.
- Welded Heat Shield.
- ◇ Resonator.
- # Special Style, not shown.
- @ Stainless.
- ‡ Threaded.
- § Tractor.
- AS Aluminized Spout.
- CT Chrome Tip.
- SB Spherical Ball.
- SF Spherical Flare Loose Flange.
- SP Spout.
- ST Stainless Tip.
- WF Welded Flange.
- WP Welded Pipe.
- WS Welded Spout.

INFORMATION & BUILD TO ORDER
 TOOLS AND ACCESSORIES
 SCHOOL BUS
 MEDIUM DUTY TRUCK GVV 3-6
 HEAVY DUTY TRUCK GVV 7-8
 APPLICATION BY ENGINE
 NOISE AND BACKPRESSURE DATA
 TRACTOR
 MUFFLER SPECS
 O.E. CROSS INDEX

TABLE 2 - MUFFLER SPECIFICATIONS BY INLET SIZE

Part No.	Style	Inlet ID (A)	Shell Dia. (B)	Shell Length (C)	Overall Length (D)	Outlet ID (E)	Inlet Offset (F)	Outlet Offset (G)
22606	12	2 1/4	4 1/4 x 9 3/4	14	25	2 1/4 AS	2 7/8	2 7/8
22567	12	2 1/4	4 1/4 x 9 3/4	14 1/2	21 1/2	2 1/4 AS	2 7/8	2 7/8
21200	3	2 1/4	4 1/4 x 9 3/4	16	19 1/4	2 1/4	5/8	2 7/8
22298	2	2 1/4	4 1/4 x 9 3/4	16	19 1/2	2	2 7/8	2 7/8
22395	17	2 1/4	4 1/4 x 9 3/4	16	20 1/2	2 1/4	2 7/8	2 7/8
22458	2	2 1/4	4 1/4 x 9 3/4	16	19 1/2	2	2 7/8	2 7/8
22564	11	2 1/4	4 1/4 x 9 3/4	16	27 3/4	2 1/4	2 7/8	
22595	11	2 1/4	4 1/4 x 9 3/4	16	27	2 AS	3	
21385	11	2 1/4	4 1/4 x 9 3/4	17	21	2 1/4	2 7/8	
22349	2	2 1/4	4 1/4 x 9 3/4	17	20 1/2	2 1/4	2 7/8	2 7/8
22447	12	2 1/4	4 1/4 x 9 3/4	17	28 1/2	2 AS	2 7/8	2 7/8
22462	12	2 1/4	4 1/4 x 9 3/4	17	26	1 3/4 AS	2 7/8	2 7/8
22501	3	2 1/4	4 1/4 x 9 3/4	17	20 1/2	2 1/4	5/8	2 7/8
21191	#	2 1/4	4 1/4 x 9 3/4	18	27 1/2	2 1/4 OD		3
21290	#	2 1/4	4 1/4 x 9 3/4	18	31 1/4	2 OD		3
21337	3	2 1/4	4 1/4 x 9 3/4	18	21 1/2	2 1/4	5/8	2 7/8
21456	3	2 1/4	4 1/4 x 9 3/4	18	22	2 1/4 OD		2 7/8
22363	11	2 1/4	4 1/4 x 9 3/4	18	30 3/4	2 AS	2 7/8	
22364	12	2 1/4	4 1/4 x 9 3/4	18	30 3/4	2 AS	2 7/8	2 7/8
22580	2	2 1/4	4 1/4 x 9 3/4	18	21 3/4	1 7/8	2 7/8	
21043	2	2 1/4	4 1/4 x 9 3/4	19	21	2	3	3
21110	2	2 1/4	4 1/4 x 9 3/4	19	23	2	3	3
21111	2	2 1/4	4 1/4 x 9 3/4	19	23	2	3	3
21424	11	2 1/4	4 1/4 x 9 3/4	19	23	2 1/4		
21206	11	2 1/4	4 1/4 x 9 3/4	19	24 1/2	2	2 7/8	
21283	11	2 1/4	4 1/4 x 9 3/4	19	33	2 1/4 OD	3	
21339	11	2 1/4	4 1/4 x 9 3/4	19	32 3/4	2 1/4	2 7/8	
21386	2	2 1/4	4 1/4 x 9 3/4	19	27 1/2	2 OD	2 7/8	2 7/8
21387	2	2 1/4	4 1/4 x 9 3/4	19	28 1/2	2 OD	2 7/8	2 7/8
22070	11	2 1/4	4 1/4 x 9 3/4	19	23 3/4	2	2 7/8	
22143	21	2 1/4	4 1/4 x 9 3/4	19	24	2	2 7/8	2 7/8
22146	3	2 1/4	4 1/4 x 9 3/4	19	23	2 1/4		2 7/8
22253	21	2 1/4	4 1/4 x 9 3/4	19	24	2	2 7/8	2 7/8
22297	3	2 1/4	4 1/4 x 9 3/4	19	23	2 1/2		2 7/8
22313	11	2 1/4	4 1/4 x 9 3/4	19	26 1/4	2	2 7/8	
22316	2	2 1/4	4 1/4 x 9 3/4	19	23	2	2 7/8	2 7/8
22317	2	2 1/4	4 1/4 x 9 3/4	19	23	2 1/4	2 7/8	2 7/8
22394	2	2 1/4	4 1/4 x 9 3/4	19	23	2 1/4	2 7/8	2 7/8
22401	12	2 1/4	4 1/4 x 9 3/4	19	23	2	2 7/8	2 7/8
22480	12	2 1/4	4 1/4 x 9 3/4	19	23	2	2 7/8	2 7/8
22490	11	2 1/4	4 1/4 x 9 3/4	19	26 1/4	2	2 7/8	
22517	2	2 1/4	4 1/4 x 9 3/4	19	22 3/4	2 1/4	2 7/8	2 7/8
22638	11	2 1/4	4 1/4 x 9 3/4	19	25	2 OD	2 7/8	
22714	11	2 1/4	4 1/4 x 9 3/4	19	24 1/2	2 1/4 OD	2 7/8	
21114	2	2 1/4	4 1/4 x 9 3/4	20	24	2 1/4	2 7/8	2 7/8
21276	3	2 1/4	4 1/4 x 9 3/4	20	24	2 1/4		3
21489	3	2 1/4	4 1/4 x 9 3/4	20	26 1/2	2 1/4 OD		2 7/8
22502	3	2 1/4	4 1/4 x 9 3/4	20	24	2 1/4		2 7/8
22503	3	2 1/4	4 1/4 x 9 3/4	20	33	2 1/4 AS		2 7/8
22508	11	2 1/4	4 1/4 x 9 3/4	20	24	2 1/4	2 7/8	
22523	3	2 1/4	4 1/4 x 9 3/4	20	32	2 1/4 AS		2 7/8
22537	2	2 1/4	4 1/4 x 9 3/4	20	24	2 1/4	2 7/8	2 7/8
21345	16	2 1/4 SF	4 1/4 x 9 3/4	20	29	2	2 7/8 (2)	
21045	3	2 1/4	4 1/4 x 9 3/4	21	26	2 1/4	2 7/8	
21193	11	2 1/4	4 1/4 x 9 3/4	21	34 1/2	2 1/4 OD	2 7/8	
21768	11	2 1/4	4 1/4 x 9 3/4	21	25 1/2	2	2 7/8	
21848	11	2 1/4	4 1/4 x 9 3/4	21	25 3/4	2 1/4	2 7/8	
21979	2	2 1/4	4 1/4 x 9 3/4	21	28 1/2	2		
21988	2	2 1/4	4 1/4 x 9 3/4	21	29 3/4	2 OD	2 7/8	2 7/8
22241	11	2 1/4	4 1/4 x 9 3/4	21	32	2 OD	2 7/8	
22380	2	2 1/4	4 1/4 x 9 3/4	21	25	2 1/4	2 7/8	2 7/8
22500	11	2 1/4	4 1/4 x 9 3/4	21	31 7/8	2 OD	2 7/8	
22724	11	2 1/4	4 1/4 x 9 3/4	21	33	2 OD	2 7/8	
22727	11	2 1/4	4 1/4 x 9 3/4	21	33	2 OD	2 7/8	
22799	3	2 1/4	4 1/4 x 9 3/4	21	25 1/2	2		2 7/8
21415	2	2 1/4	4 1/4 x 9 3/4	22	25	2 1/4 OD	2 7/8	2 7/8
21066	11	2 1/4	4 1/4 x 9 3/4	22	31	2 1/4 AS	3	

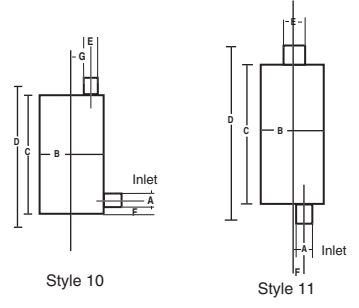
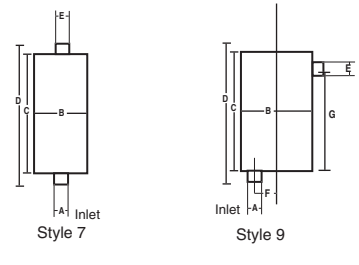
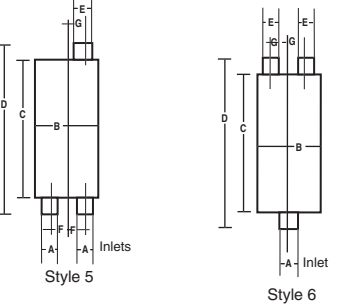
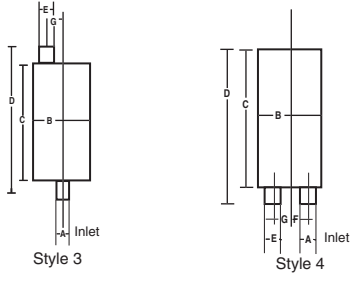
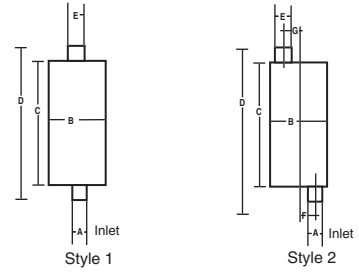

- ▲ Arc Welded.
- † Double-Wall.
- ◆ Spark Arrestor.
- Welded Heat Shield.
- ⚡ Resonator.
- # Special Style, not shown.
- @ Stainless.
- ‡ Threaded.
- § Tractor.
- AS Aluminized Spout.
- CT Chrome Tip.
- SB Spherical Ball.
- SF Spherical Flare Loose Flange.
- SP Spout.
- ST Stainless Tip.
- WF Welded Flange.
- WP Welded Pipe.
- WS Welded Spout.

TABLE 2 - MUFFLER SPECIFICATIONS BY INLET SIZE

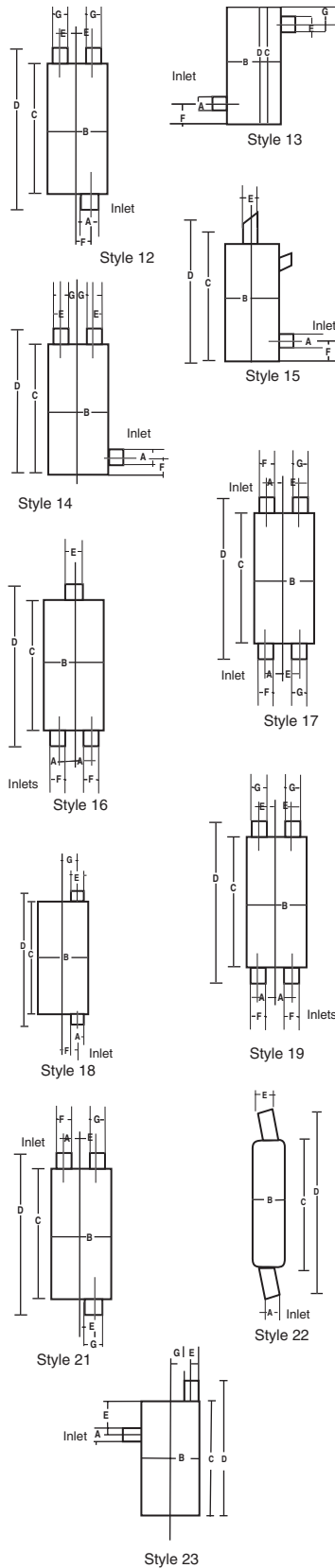

Part No.	Style	Inlet ID (A)	Shell Dia. (B)	Shell Length (C)	Overall Length (D)	Outlet ID (E)	Inlet Offset (F)	Outlet Offset (G)
21303	11	2 1/4	4 1/4 x 9 3/4	22	37	2 OD	3	
21807	2	2 1/4	4 1/4 x 9 3/4	22	28	2	2 7/8	2 7/8
21907	21	2 1/4	4 1/4 x 9 3/4	22	28 1/2	2	2 7/8	2 7/8
22592	11	2 1/4	4 1/4 x 9 3/4	22	26 1/2	2 1/4	2 7/8	
22738	11	2 1/4	4 1/4 x 9 3/4	24	31	2 OD	2 7/8	
22739	11	2 1/4	4 1/4 x 9 3/4	24	38	2 OD	2 7/8	
21272	3	2 1/4	4 1/4 x 9 3/4	25	30	2		2 7/8
21275	3	2 1/4	4 1/4 x 9 3/4	25	37	2		2 7/8
21410	11	2 1/4	4 1/2 x 8 13/16	28	32	2 1/4 OD	2 5/8	
21357	3	2 1/4	4 1/2 x 11	20	24 1/2	2 1/4		2 7/8
24231	4	2 1/4	5	12	16	4 OD		
21976	1	2 1/4	5	16	24 1/2	2 1/2 AS		
22140	1	2 1/4	5	18	33 1/2	2 3/4 AS		
22180	1	2 1/4	5	18	38 1/2	2 1/4 AS		
21346	11	2 1/4 OD	5 1/2 x 11	15	27 3/4	2 1/4 SP		
21399	11	2 1/4	5 1/2 x 11	15	30 1/2	2 1/4 OD	3 3/4	1
21389	11	2 1/4	5 1/2 x 11	16	30 1/2	2 SP OD	3 1/2	
21360	2	2 1/4	5 1/2 x 11	17	21 1/2	2 1/4 OD	3 1/2	3 1/2
21333	11	2 1/4	5 1/2 x 11	19	30 9/16	2 OD	3 3/4	1
21546	10	2 1/4	5 1/2 x 11	19	31 1/4	2	5	
21186	12	2 1/4	5 1/2 x 11	19	35 1/2	1 5/8	3 3/4	
21307	10	2 1/4	5 1/2 x 11	20	26	2 3/8 SP OD		
21253	10	2 1/4	5 1/2 x 11	20	27 3/16	2 OD	1 5/8	1 5/8
21254	10	2 1/4	5 1/2 x 11	20	27 3/16	2 1/4 OD		
21181	10	2 1/4 OD	5 1/2 x 11	20	36 1/2	1 3/4		1 1/2
21185	14	2 1/4 OD	5 1/2 x 11	20	36 1/2	1 3/4		
21344	16	2 1/4 SF	5 1/2 x 11	20	39	2	3 1/2 (2)	
21179	11	2 1/4	5 1/2 x 11	23	26 1/2	2	3 1/2	
21180	#	2 1/4	5 1/2 x 11	23	26 1/2	2	3 1/2	3 1/2
21432	3	2 1/4	5 1/2 x 11	25	30 1/8	2 1/4 OD		3 1/2
21414	3	2 1/4	5 1/2 x 11	27	33 3/4	2 1/4		3 1/2
21411	3	2 1/4	5 1/2 x 11	29	37 3/8	2 1/4		3 1/2
22581▲	2	2 1/4	6	19	26	2	1 3/8	1 3/8
22245	2	2 1/4	6	20	24 3/4	2	1 1/2	1 1/2
22382▲	2	2 1/4	6	24	30	2 1/4	1 3/8	1 3/8
22465	2	2 1/4	6	25	29 1/4	2	1 1/2	1 1/2
22582▲	2	2 1/4	6	25	31	2	1 3/8	1 3/8
22338	2	2 1/4	6	25	33 1/2	2 1/4	1 1/2	1 1/2
21894	2	2 1/4	6	26	31	2 1/4	1 1/2	1 1/2
22437	#	2 1/4	6	26 1/2	32 1/2	2 1/4	1 1/2	1 1/2
22155	2	2 1/4	6	27	31	2	1 1/2	1 1/2
22335	12	2 1/4	7	17	28 1/2	2 1/4 AS	2 1/4	2 1/4
22314	12	2 1/4	7	18	29 1/4	2 1/4 AS	2 1/4	2 1/4
21095▲	6	2 1/4	7	22	27 1/2	2 (2)	1 3/4	1 3/4
21326	2	2 1/4	7	24	35 3/8	2 1/4	1 3/4	1 3/4
21078	12	2 1/4	7	25	29	2 (2)	1 3/4	1 3/4
22399	12	2 1/4	7	25	29	2	1 3/4	1 3/4
22402	6	2 1/4	7	25	29	2		1 3/4
22173	2	2 1/4	7	25	29 1/4	2 1/4	1 3/4	1 3/4
22460	2	2 1/4	7	25	29 1/4	2 1/4	1 3/4	1 3/4
22466	2	2 1/4	7	25	29 1/4	2 1/4	1 3/4	1 3/4
22798	2	2 1/4	7	25	30	2 1/2	1 3/4	1 3/4
22177	2	2 1/4	7	27	31 1/4	2 1/4	1 3/4	1 3/4
22609	6	2 1/4	7 x 9	15	30	2 1/4 AS		2 5/8
22610	6	2 1/4	7 x 9	15	30	2 1/4 AS		2 5/8
22758	3	2 1/4	7 x 9	17	26 3/4	1 3/4 AS		2 5/8
21286	2	2 1/4	7 x 9	20	24	2 1/2	2	2
21315	2	2 1/4	7 x 9	20	24	2 1/4	2	2
21422	3	2 1/4	7 x 9	24	28	2 1/4	1 5/8	2 5/8
21352	3	2 1/4	7 x 9	24	30	2	1 5/8	2 5/8
21478	1	2 1/4	7 x 9	25	28	2 1/4 OD	2 5/8	1 5/8
21041§	1	2 3/8	4 1/2	11	21	2 3/8		
24232	4	2 3/8	5	12	16	4 OD		
21060§	1	2 3/8	5 5/8	17 3/4	32	2 1/2 OD		
22890§	1	2 3/8	4 1/8 x 9	26	29	2 1/2		
22782	3	2 3/8 WF	4 7/8 x 9 3/4	20	36 1/4	2 3/8 AS		
22780	#	2 3/8	4 7/8 x 9 3/4	20	36 1/2	2 AS		

- ▲ Arc Welded.
- † Double-Wall.
- ◆ Spark Arrestor.
- Welded Heat Shield.
- ◇ Resonator.
- # Special Style, not shown.
- @ Stainless.
- ‡ Threaded.
- § Tractor.
- AS Aluminized Spout.
- CT Chrome Tip.
- SB Spherical Ball.
- SF Spherical Flare Loose Flange.
- SP Spout.
- ST Stainless Tip.
- WF Welded Flange.
- WP Welded Pipe.
- WS Welded Spout.

INFORMATION & BUILD TO ORDER
 TOOLS AND ACCESSORIES
 SCHOOL BUS
 MEDIUM DUTY TRUCK GVV 3-6
 HEAVY DUTY TRUCK GVV 7-8
 APPLICATION BY ENGINE
 NOISE AND BACKPRESSURE DATA
 TRACTOR
 MUFFLER SPECS
 O.E. CROSS INDEX

TABLE 2 - MUFFLER SPECIFICATIONS BY INLET SIZE

Part No.	Style	Inlet ID (A)	Shell Dia. (B)	Shell Length (C)	Overall Length (D)	Outlet ID (E)	Inlet Offset (F)	Outlet Offset (G)
21350	3	2 ³ / ₈ WF	4 ⁷ / ₈ x 9 ³ / ₄	20	36 ¹ / ₂	2 ³ / ₈		
21349	3	2 ³ / ₈ WF	4 ⁷ / ₈ x 9 ³ / ₄	20	38 ¹ / ₂	2 ³ / ₈		
22791	3	2 ³ / ₈ WF	4 ⁷ / ₈ x 9 ³ / ₄	20	39 ³ / ₄	2 ³ / ₈ AS		
22781	#	2 ³ / ₈	4 ⁷ / ₈ x 9 ³ / ₄	20	40 ¹ / ₂	2 AS		
22773	#	2 ³ / ₈ OD	6 x 7	36 ¹ / ₂	42 ¹ / ₂	2 ¹ / ₄ OD		
22467@	2	2 ³ / ₈	7 ⁹ / ₁₆	22	26	2 ¹ / ₄	1 ³ / ₄	1 ³ / ₄
24120	22	2 ¹ / ₂	3 ¹ / ₂	18	23	2 ¹ / ₄	2 ⁵ / ₁₆	2 ⁵ / ₁₆
24079	22	2 ¹ / ₂	3 ¹ / ₂	20	25	2 OD	2 ¹ / ₂	2 ¹ / ₂
24117	22	2 ¹ / ₂	3 ¹ / ₂	20	25	2 ¹ / ₄ OD	2 ¹ / ₂	2 ¹ / ₂
24240@	1	2 ¹ / ₂	3 ¹ / ₂	20	25	2 ¹ / ₂		
24091	22	2 ¹ / ₂	3 ¹ / ₂	20	26	2 ¹ / ₄	1 ³ / ₈	1 ³ / ₈
24103	22	2 ¹ / ₂	3 ¹ / ₂	20	26	2	1 ³ / ₈	1 ³ / ₈
24104	22	2 ¹ / ₂	3 ¹ / ₂	24	29	2 ¹ / ₄	1 ³ / ₄	1 ³ / ₄
24016	22	2 ¹ / ₂	3 ¹ / ₂	30	34	2	1 ¹ / ₂	1 ¹ / ₂
24215	1	2 ¹ / ₂	4	12	16 ¹ / ₂	2 ¹ / ₂		
24225	1	2 ¹ / ₂	4	12	25 ¹ / ₂	2 ¹ / ₂ OD		
24226	1	2 ¹ / ₂	4	12	25 ¹ / ₂	2 ¹ / ₂ OD		
24236	1	2 ¹ / ₂	4	18	23 ¹ / ₄	2 ¹ / ₂		
22839	1	2 ¹ / ₂	4	21	36 ¹ / ₂	2 ¹ / ₂ OD		
24214	1	2 ¹ / ₂	4	23	28	2 ¹ / ₂		
24218	6	2 ¹ / ₂	4	23	33 ¹ / ₂	2 ¹ / ₄ (2) OD		2 ¹ / ₄ (2)
24220	1	2 ¹ / ₂	4	24	30	2 ¹ / ₂		
24213	1	2 ¹ / ₂	4	40	45	2 ¹ / ₂		
22730▲	2	2 ¹ / ₂	4 ¹ / ₈ x 9	19	26	2 OD	2 ⁷ / ₈	2 ⁷ / ₈
22731▲	2	2 ¹ / ₂	4 ¹ / ₈ x 9	19	26	2 ¹ / ₄ OD	2 ⁷ / ₈	2 ⁷ / ₈
22732▲	6	2 ¹ / ₂	4 ¹ / ₈ x 9	19	26	2		2 ⁷ / ₈
21099▲	11	2 ¹ / ₂	4 ¹ / ₈ x 9	25	30	2 ¹ / ₄	2 ⁷ / ₈	
21103	3	2 ¹ / ₂	4 ¹ / ₈ x 9	28	33	2 ¹ / ₂		2 ⁷ / ₈
22032§	10	2 ¹ / ₂	4 ¹ / ₄	14 ³ / ₄	19 ¹ / ₂	2 ¹ / ₈ OD	3 ³ / ₈	
22288	3	2 ¹ / ₂	4 ¹ / ₄ x 8 ¹³ / ₁₆	13	17 ¹ / ₂	2 ¹ / ₈		2 ⁵ / ₈
21548	2	2 ¹ / ₂	4 ¹ / ₄ x 8 ¹³ / ₁₆	16	20	2 ¹ / ₂	2 ⁵ / ₈	2 ⁵ / ₈
22427	11	2 ¹ / ₂	4 ¹ / ₄ x 8 ¹³ / ₁₆	19	23	2 ³ / ₈ OD	2 ⁷ / ₈	
21903	3	2 ¹ / ₂	4 ¹ / ₄ x 8 ¹³ / ₁₆	21	26	2 ¹ / ₄		2 ⁵ / ₈
21401↔	12	2 ¹ / ₂	4 ¹ / ₄ x 9 ³ / ₄	14	17	2 OD	2 ⁷ / ₈	2 ⁷ / ₈ (2)
22160	2	2 ¹ / ₂	4 ¹ / ₄ x 9 ³ / ₄	15	28 ¹ / ₂	2 ¹ / ₄ AS	2 ⁷ / ₈	2 ⁷ / ₈
22161	2	2 ¹ / ₂	4 ¹ / ₄ x 9 ³ / ₄	15	28 ¹ / ₂	2 ¹ / ₄ AS	2 ⁷ / ₈	2 ⁷ / ₈
22590	11	2 ¹ / ₂	4 ¹ / ₄ x 9 ³ / ₄	16	20	2 ¹ / ₄	2 ⁷ / ₈	
22589	11	2 ¹ / ₂	4 ¹ / ₄ x 9 ³ / ₄	16	23	2 ¹ / ₂	2 ⁷ / ₈	
22558	11	2 ¹ / ₂	4 ¹ / ₄ x 9 ³ / ₄	16	24 ¹ / ₂	2 ¹ / ₄	2 ⁷ / ₈	
22584	11	2 ¹ / ₂	4 ¹ / ₄ x 9 ³ / ₄	16	29	2 ¹ / ₄	2 ⁷ / ₈	
21405	11	2 ¹ / ₂	4 ¹ / ₄ x 9 ³ / ₄	18	21	2 ¹ / ₄ OD	2 ⁷ / ₈	
21109	2	2 ¹ / ₂	4 ¹ / ₄ x 9 ³ / ₄	19	23	2 ¹ / ₂	3	3
21550	2	2 ¹ / ₂	4 ¹ / ₄ x 9 ³ / ₄	19	23	2 OD	2 ⁷ / ₈	2 ⁷ / ₈
21856	11	2 ¹ / ₂	4 ¹ / ₄ x 9 ³ / ₄	19	23	2 ¹ / ₂	2 ⁷ / ₈	
22393	2	2 ¹ / ₂	4 ¹ / ₄ x 9 ³ / ₄	19	23	2 ¹ / ₂	2 ⁷ / ₈	2 ⁷ / ₈
22354	21	2 ¹ / ₂	4 ¹ / ₄ x 9 ³ / ₄	19	24	2 ¹ / ₄	2 ⁷ / ₈	2 ⁷ / ₈
22457	2	2 ¹ / ₂	4 ¹ / ₄ x 9 ³ / ₄	21	24	2 ¹ / ₄	2 ⁷ / ₈	2 ⁷ / ₈
22513	11	2 ¹ / ₂	4 ¹ / ₄ x 9 ³ / ₄	21	24	2 ¹ / ₄	2 ⁷ / ₈	
22624	2	2 ¹ / ₂	4 ¹ / ₄ x 9 ³ / ₄	21	24	2 ¹ / ₄	2 ⁷ / ₈	2 ⁷ / ₈
22514	3	2 ¹ / ₂	4 ¹ / ₄ x 9 ³ / ₄	21	25	2 ¹ / ₂		2 ⁷ / ₈
21784	2	2 ¹ / ₂	4 ¹ / ₄ x 9 ³ / ₄	21	25 ¹ / ₄	2 OD	2 ⁷ / ₈	2 ⁷ / ₈
21669	2	2 ¹ / ₂	4 ¹ / ₄ x 9 ³ / ₄	21	25 ¹ / ₂	2 ¹ / ₂	2 ⁷ / ₈	2 ⁷ / ₈
21883	11	2 ¹ / ₂	4 ¹ / ₄ x 9 ³ / ₄	21	25 ¹ / ₂	2	2 ⁷ / ₈	
22153	11	2 ¹ / ₂	4 ¹ / ₄ x 9 ³ / ₄	21	25 ¹ / ₂	2 ¹ / ₄	2 ⁷ / ₈	
22171	6	2 ¹ / ₂	4 ¹ / ₄ x 9 ³ / ₄	21	25 ¹ / ₂	2		2 ⁷ / ₈
22172	6	2 ¹ / ₂	4 ¹ / ₄ x 9 ³ / ₄	21	25 ¹ / ₂	2 OD		2 ⁷ / ₈
22329	2	2 ¹ / ₂	4 ¹ / ₄ x 9 ³ / ₄	21	25 ¹ / ₂	2 ¹ / ₄ OD	2 ⁷ / ₈	2 ⁷ / ₈
22512	2	2 ¹ / ₂	4 ¹ / ₄ x 9 ³ / ₄	21	25 ¹ / ₂	2 ¹ / ₄	2 ⁷ / ₈	2 ⁷ / ₈
22725	11	2 ¹ / ₂	4 ¹ / ₄ x 9 ³ / ₄	21	26	2 ¹ / ₄ OD	2 ⁷ / ₈	
22726	11	2 ¹ / ₂	4 ¹ / ₄ x 9 ³ / ₄	21	26	2 ¹ / ₄ OD	2 ⁷ / ₈	
21910	2	2 ¹ / ₂	4 ¹ / ₄ x 9 ³ / ₄	21	26 ¹ / ₂	2 ¹ / ₄ OD	2 ⁷ / ₈	2 ⁷ / ₈
22504	3	2 ¹ / ₂	4 ¹ / ₄ x 9 ³ / ₄	21	27	3 ⁹ / ₁₆		2 ⁷ / ₈
22509	11	2 ¹ / ₂	4 ¹ / ₄ x 9 ³ / ₄	21	27	3 ⁹ / ₁₆	2 ⁷ / ₈	
22249	2	2 ¹ / ₂	4 ¹ / ₄ x 9 ³ / ₄	21	29	2 ¹ / ₄ OD	2 ⁷ / ₈	2 ⁷ / ₈
21262	11	2 ¹ / ₂	4 ¹ / ₄ x 9 ³ / ₄	21	31 ¹ / ₂	2 ¹ / ₄ OD	2 ⁷ / ₈	
21204	11	2 ¹ / ₂	4 ¹ / ₄ x 9 ³ / ₄	21	32	2 ¹ / ₄ OD	2 ⁷ / ₈	
22511	6	2 ¹ / ₂ WP	4 ¹ / ₄ x 9 ³ / ₄	21	32 ¹ / ₄	2 (2)		2 ⁷ / ₈

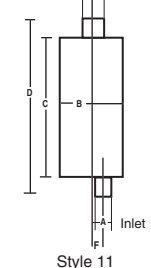
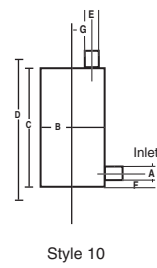
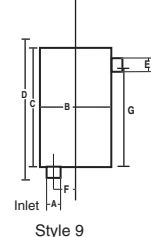
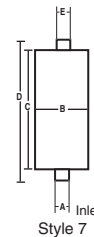
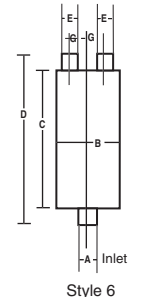
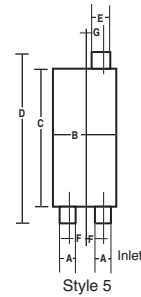
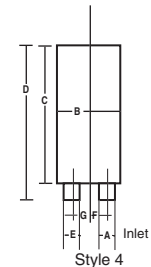
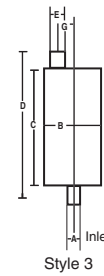
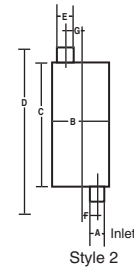
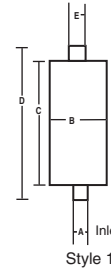

- ▲ Arc Welded.
- † Double-Wall.
- ◆ Spark Arrestor.
- Welded Heat Shield.
- ↔ Resonator.

- # Special Style, not shown.
- @ Stainless.
- ‡ Threaded.
- § Tractor.

- AS Aluminized Spout.
- CT Chrome Tip
- SB Spherical Ball.
- SF Spherical Flare Loose Flange.
- SP Spout.

- ST Stainless Tip
- WF Welded Flange.
- WP Welded Pipe.
- WS Welded Spout.

TABLE 2 - MUFFLER SPECIFICATIONS BY INLET SIZE

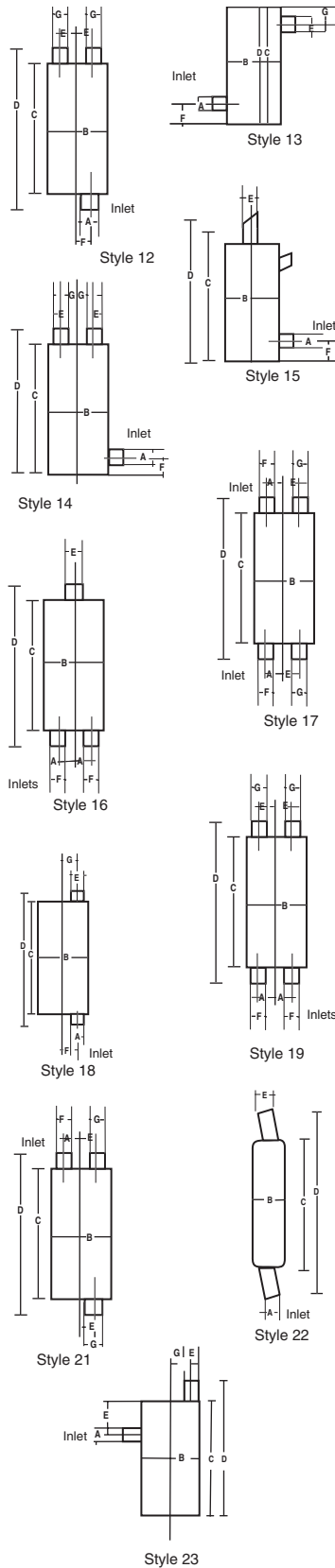

Part No.	Style	Inlet ID (A)	Shell Dia. (B)	Shell Length (C)	Overall Length (D)	Outlet ID (E)	Inlet Offset (F)	Outlet Offset (G)
21909	2	2½	4¼ x 9¾	21	35½	2¼	2⅞	2⅞
22787	11	2½	4¼ x 9¾	21		2¼ OD	2⅞	
22788	11	2½	4¼ x 9¾	21		2¼ OD	2⅞	
21063	11	2½	4¼ x 9¾	22	31	2½	2⅞	
21116	6	2½	4¼ x 9¾	23	26½	2¼		2⅞
21427	21	2½	4¼ x 9¾	23	26½	2		2⅞
22744	3	2½	4¼ x 9¾	23	26½	2		2⅞
22745	11	2½	4¼ x 9¾	23	26½	2	2⅞	
22747	11	2½	4¼ x 9¾	23	26½	2¼	2⅞	
22794	6	2½	4¼ x 9¾	23	26½	2 (2)		2⅞
21417	21	2½	4¼ x 9¾	23	27	2¼	2⅞	2⅞
21288	#	2½	4¼ x 9¾	23	27½	2 (2)	2⅞	2⅞
21416	2	2½	4¼ x 9¾	24	27	2¼	2⅞	2⅞
22499	11	2½	4¼ x 9¾	24	29	2½	2⅞	
22154	11	2½	4¼ x 9¾	25	29	2½	2⅞	
21860	11	2½	4¼ x 9¾	25	29¼	2¼	2⅞	
21999	11	2½	4¼ x 9¾	25	30½	2¼	2⅞	
22644	2	2½	4¼ x 9¾	28	32	2¼ OD	2⅞	2⅞
22576	3	2½	4¼ x 9¾	28	33	2½		2⅞
22647	12	2½	4¼ x 9¾	28	33½	2	2⅞	2⅞
22574	12	2½	4¼ x 9¾	28	35	2¼	2⅞	2⅞
22100	11	2½	4¼ x 9¾	28	36½	2½	2⅞	
22648	11	2½	4¼ x 9¾	28	36½	2½	2⅞	
21134	11	2½	4½ x 9¾	21	32⅞	2¼ OD	2⅞	
21473	1	2½	4⅞	17	27½	2⅞ OD		
22390	3	2½	4⅝ x 8⅝	19	33½	1 ²⁷ / ₃₂ OD	2¾	2¾
21610	3	2½	5	21	34 ⁵ / ₁₆	2½ AS		1¼
21426	2	2½	5½ x 11	13	20	2½ OD	3½	
21498	2	2½	5½ x 11	13	20	2½ OD	3½	
21485	2	2½	5½ x 11	16	29	2½ OD	3½	3½
21375	2	2½	5½ x 11	17	21¾	2½ OD	3½	3½
21302	11	2½	5½ x 11	20	24	2¼	3½	
21366	16	2½ SF	5½ x 11	20	31¾	2¼	3½	
21396	3	2½	5½ x 11	26	29½	2½		3½
21409	3	2½	5½ x 11	27	29	2½		3½
21544	3	2½	5½ x 11	27	32	2¼	3½	
21421	3	2½	5½ x 11	27	44⅜	2½		3½
22765	1	2½	6	14	18	2½		
22635	1	2½	6	20	26	2½		
21620	2	2½	6	20	27	1 ¹³ / ₁₆ OD	1½	1½
22138	2	2½	6	22	26¼	2½	1½	1½
22089	2	2½	6	23	28	2¼	1½	1½
21163	1	2½	6	24	30	2½		
21439	2	2½	6	25	33	2	1½	1½
22235	1	2½	6	26½	34	2½		
21259	2	2½	6	29	34¼	2½ OD	1½	1½
21540	2	2½	6	29	34½	1⅞ OD	1½	1½
21097	2	2½	6	29	35	2½	1½	1½
21723	1	2½	6	30	37	2½		
22356	1	2½	6	30	38	2½		
22103	2	2½	6	34	39½	2½	1½	1½
22628	2	2½	6½	20	26	2½	2½	2½
21151	2	2½	6½	23	27¾	2¼	1½	1½
22583	2	2½	6½	26	32	2¼	1½	1½
21475	2	2½	6½	26	35	2½	1½	1½
22563	2	2½	6½	28	37	2	1½	1½
22770	10	2½	6⅝	20¾	23½	2½	3½	1⅝
22594	2	2½	7	24	29	2	1¾	1¾
22728	2	2½	7	24	29	2¼	1¾	1¾
22398	12	2½	7	25	29	2	1¾	1¾
21377	2	2½	7	26	31	2½	1¾	1¾
22733	2	2½	7	26	31	2¼	1¾	1¾
22000	2	2½	7	27	32½	2¼	1¾	1¾
21260	5	2½	7	28	34½	2½	1⅞	1⅞
22151	2	2½	7	30	34½	2½	1¾	1¾
22933	2	2½	7	30	39	2½ OD	1⅝	1⅝
22459	2	2½	7	32	36	2¼	1¾	1¾

- ▲ Arc Welded.
- † Double-Wall.
- ◆ Spark Arrestor.
- Welded Heat Shield.
- ◇ Resonator.

- # Special Style, not shown.
- @ Stainless.
- ‡ Threaded.
- § Tractor.

- AS Aluminized Spout.
- CT Chrome Tip.
- SB Spherical Ball.
- SF Spherical Flare Loose Flange.
- SP Spout.

- ST Stainless Tip.
- WF Welded Flange.
- WP Welded Pipe.
- WS Welded Spout.

INFORMATION & BUILD TO ORDER
 TOOLS AND ACCESSORIES
 SCHOOL BUS
 MEDIUM DUTY TRUCK GVV 3-6
 HEAVY DUTY TRUCK GVV 7-8
 APPLICATION BY ENGINE
 NOISE AND BACKPRESSURE DATA
 TRACTOR
 MUFFLER SPECS
 O.E. CROSS INDEX

TABLE 2 - MUFFLER SPECIFICATIONS BY INLET SIZE

Part No.	Style	Inlet ID (A)	Shell Dia. (B)	Shell Length (C)	Overall Length (D)	Outlet ID (E)	Inlet Offset (F)	Outlet Offset (G)
22102	2	2½	7	32	37¾	2¼	1¾	1¾
22315	2	2½	7	32	37¾	2¼	1¾	1¾
21093	3	2½	7 x 9	16	21	2½	1½	2½
21336	2	2½	7 x 9	17	20¾	2½	1½	1½
21047	3	2½	7 x 9	18	22	2½		2½
21481	2	2½	7 x 9	20	24	2½ OD	1½	1½
21482	2	2½	7 x 9	21	39	2½ OD	2½	1½
21292	2	2½	7 x 9	22	26	2½	1½	1½
21347	2	2½	7 x 9	22	26	2¼	1½	1½
21373	2	2½	7 x 9	22	26¼	2½	1½	1½
21355	2	2½	7 x 9	24	28	2½	1½	1½
21431	5	2½	7 x 9	24	28	2¾ OD	2½	2½
21437	12	2½	7 x 9	24	28	2¾ OD	1½	1½
21533	5	2½	7 x 9	24	28	3	1½	1½
21400	16	2½	7 x 9	24	29	2¾ OD	2½ (2)	1½
21547	3	2½	7 x 9	24	30	2½		1¾
21092	3	2½	7 x 9	26	32	2½		2½
21539	16	2½	7 x 9	28	32	2½	1½	1½
21541	16	2½	7 x 9	28	32	2½	1½	1½
21338	2	2½	7 x 9	30	33¾	2½ OD	1½	1½
21521	2	2½	7 x 9	30	34	2½	1½	1½
21543	2	2½	7 x 9	30	36	2½	1½	1½
21351	2	2½	7 x 9	30	37½	2½	1½	1½
21579♦	7	2½	8¾	6¾	12⅞	2½		
22003▲	2	2½	8¾	26½	32½	2½	2	2
22866▲	5	2½	8¾	29½	38	2¾	2½	2
22939	5	2½	8¾	29½	38	2¾	2½	2
22865▲	5	2½	8¾	29¾	36¼	3	1½	2
22932▲	5	2½	8¾	29¾	36¼	3 OD	1½	2
22822▲	5	2½	8¾	36½	43	3	2	2½
22577▲	1	2½ WF	8½	22	28	2¼		
21308†@	5	2½	10	28	38¾	3	3	
21309†	5	2½	10	28	38¾	3	3	
22037§	1	2¾	4¾	16½	26	2½ OD		
22355▲	1	2¾	6	24	37	2¾		
22532	1	2¾	6½	17	32½	2¾ OD		
21068	12	2¾	7	26	30	2 (2)	1¾	1¾
21925	2	2¾	7	27	33¼	2½	1¾	1¾
21152▲	2	2¾	7	29¾	36¼	2¼	1¾	1¾
22852▲	2	2¾	7	33½	40	2¾	1½	1½
22101	2	2¾	7	36	41½	2½	1¾	1¾
22547	2	2¾ SF	7¾	35	45	2¾ ST	1¾	1¾
22702	3	2¾	7 x 9	14		WP		2½
22740	3	2¾	7 x 9	16	21	2½		2½
21044	3	2¾	7 x 9	18	24	2½	2½	
21523	2	2¾	7 x 9	22	26	2¾ OD		
22779	2	2¾	7 x 9	22	26½	2¾ OD	2½	2½
21046	2	2¾	7 x 9	24	29	2¾ OD	2½	2½
21065	2	2¾	7 x 9	24	29	2¾ OD	2½	2½
21356	2	2¾	7 x 9	24	29	2¾ OD	1½	1½
22741	3	2¾	7 x 9	26	32	2½		2½
22663	5	2¾	8¼ x 11½	27	32¾	4	3¾	2½
22231▲	5	2¾	8¼ x 11½	27¾	32¾	4	4¾ ₃₂	1¾
21423	3	2½	7 x 9	24	28	2½	1½	2½
21553	16	2½	7 x 9	24	28	2½	2½	1½
21058	2	2⅞	4½ x 8¾	27	34½	2½ OD	1½	2½
22033§	1	2⅞	5½	21¼	32½	3 OD		
22031	1	2⅞ SF	6½	21	26⅞	2½ OD		
22027§	1	2⅞	6½	21	27¾	2½ OD		
22039§	11	2⅞ ₃₂	6½	5½	10¾	1⅞ ₃₂ OD	1½	1⅞
24222	1	3	4	12	16½	3		
24238	1	3	4	12	18¼	3 OD		
24219	1	3	4	18	23¼	3		
24224	6	3	4	18	29	2½ (2) OD		3½ (2)
24241@	1	3	4	20	25	3		
24221	1	3 WF	4	24	30	2½		
21051	11	3	4¼ x 9¾	21	27	3⅞	2⅞	

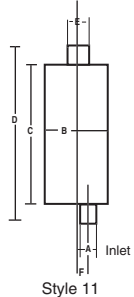
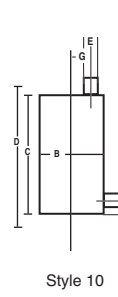
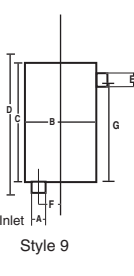
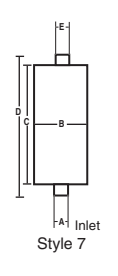
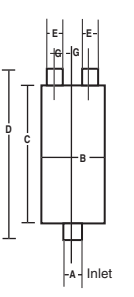
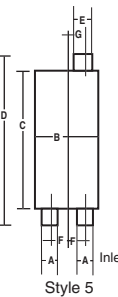
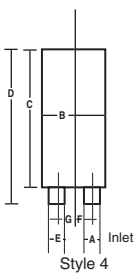
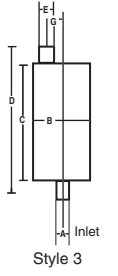
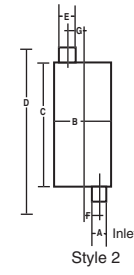
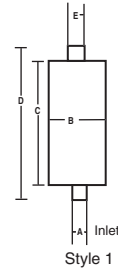

- ▲ Arc Welded.
- † Double-Wall.
- ♦ Spark Arrestor.
- Welded Heat Shield.
- ↕ Resonator.
- # Special Style, not shown.
- @ Stainless.
- ‡ Threaded.
- § Tractor.
- AS Aluminized Spout.
- CT Chrome Tip.
- SB Spherical Ball.
- SF Spherical Flare Loose Flange.
- SP Spout.
- ST Stainless Tip.
- WF Welded Flange.
- WP Welded Pipe.
- WS Welded Spout.

TABLE 2 - MUFFLER SPECIFICATIONS BY INLET SIZE

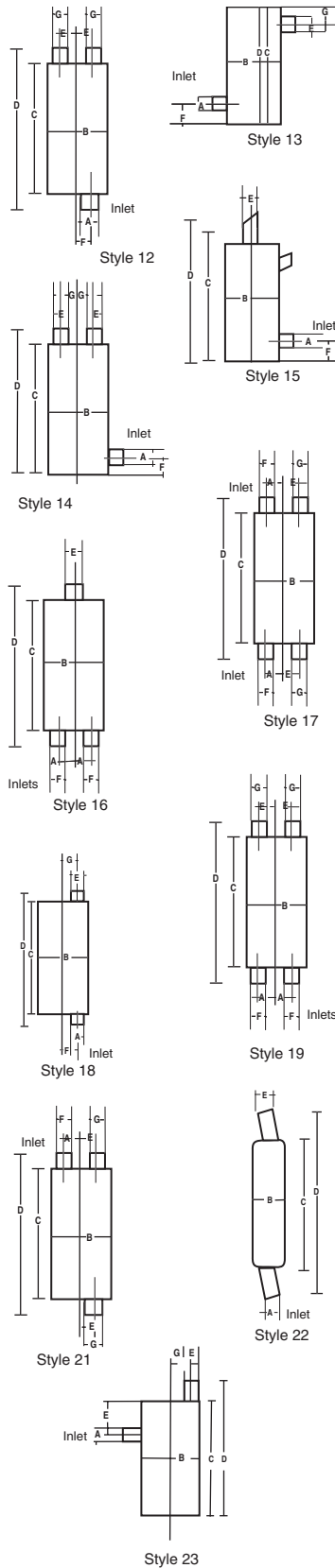

Part No.	Style	Inlet ID (A)	Shell Dia. (B)	Shell Length (C)	Overall Length (D)	Outlet ID (E)	Inlet Offset (F)	Outlet Offset (G)
22719	6	3	4¼ x 9¾	23	28	2¼		2⅞
22784	6	3	4¼ x 9¾	23	28	2¼		2⅞
22778	11	3	4¼ x 9¾	23	28½	2¾ OD		2⅞
21054	11	3	4¼ x 9¾	24	29	3		2⅞
22598	11	3	4¼ x 9¾	24	30	3		2⅞
22505	11	3	4¼ x 9¾	24	37½	2½		2⅞
22934	11	3	4¼ x 9¾	24	42¼	3 OD		2⅞
21050	1	3	5	24	36	3 OD		
21522	2	3	5½ x 11	20	27	3 OD		3½
22921§	1	3	5½	32	48	3½ OD		
21468▲	1	3	6	21	30	3		
21138	1	3	6	26	36½	3		
22541	2	3 SF	6½	29¼	38¼	2 SB	1¼	1½
22904§	1	3	6½ x 10½	32	48	3¼		
21580◆	7	3	6½	10¼	14⅞	3½ OD		
21146	1	3	7	12	20	3		
22630‡	1	3	7	14	19¾	3		
21075	12	3	7	28	32½	2 (2)	1¾	1¾
21076	12	3	7	28	35½	2 (2)	1¾	1¾
22389	1	3	7	30	38	3		
21545	2	3	7 x 9	18	24	3	1¾	1¾
22675	3	3	7 x 9	18	24	3 OD		1¾
22673	2	3	7 x 9	18	25	3 OD	1¾	1¾
22674	11	3	7 x 9	18	25½	3 OD	1¾	1¾
22776	2	3	7 x 9	18	28	3 OD	1¾	1¾
22772	2	3	7 x 9	20	24	2½	2⅞	2⅞
21507	2	3	7 x 9	20	26	3 OD	2⅞	2⅞
22679	3	3	7 x 9	20	26	3 OD		2⅞
22672	2	3	7 x 9	21	27	3 OD	1¾	1¾
22676	2	3	7 x 9	21	28¼	3 OD	2⅞	2⅞
21367	16	3 WF	7 x 9	21	39⅞	2¾ OD	2⅞	1 ¾
21406	2	3	7 x 9	22	27½	3	1 ¾	1 ¾
21384	2	3	7 x 9	24	29	2¾ OD	2⅞	2⅞
22678	2	3	7 x 9	24	29½	2¾ OD	2⅞	2⅞
22777	2	3	7 x 9	24	30	3 OD	2⅞	2⅞
21391	2	3 OD	7 x 9	24	31	2½ OD	2	2
21334	2	3	7 x 9	24	33½	2¾ OD	2⅞	2⅞
21551	16	3	7 x 9	24	34	2⅞	2⅞	1⅞
21306	2	3 OD	7 x 9	24	35⅞	2½	2	2
21447	11	3	7 x 9	26	31	3 OD	2⅞	2⅞
21542	1	3	7 x 9	26	31	3		
22677	7	3	7 x 9	27	33	3 OD		
22236	2	3	8½	29½	36½	3	2⅞	2⅞
21150	2	3	8¼ x 11½	17	23	3 OD		
22633	18	3	8¼ x 11½	26	34	3	2½	2½
21090	1	3	8¼ x 11½	31½	37¾	3½		
22636▲	2	3	8½	21	27	3	2	2
22637▲	4	3	8½	22	23½	3	1⅞	1⅞
22767▲	10	3	8½	27	29½	3	4½	2
21476▲	2	3	8½	29¾	36¼	3	2	2
22538◆	7	3	9	11½	16	3		
21312	2	3	9	26	33¾	3 OD	2	
21313	2	3	9	26	33¾	3 OD	2	
22991	2	3	11	36	42	4	2½	2½
22021§	10	3½	5½	19½	22½	2¾ OD	3¼	
21087	1	3½	9½	22¾	28¾	3½		
21061	10	3½	10½	17¼	24½	3 OD	14½	1½
21155	10	3½	8¼ x 11½	32	35½	3½	5	
22556	10	3½	8¼ x 11½	34¼	36½	3½	4¾	
22715▲	1	3½	10	23½	28½	3½		
21089	4	3½	11½	27½	30	3	3	3
21466▲	2	3¼	7	25½	32	2½	1¾	1¾
24223	1	3½ OD	4	20	34½	4 OD		
22439	2	3½ SF	4½ x 8½	19	26⅞	2½ OD	1⅞	2½
24216	1	3½	5	12	16½	3½		
22861§	1	3½	5½	28	42¼	3½ OD		
22536	2	3½	6½ x 10½	18¼	25	4½ OD	2½	2½

- ▲ Arc Welded.
- † Double-Wall.
- ◆ Spark Arrestor.
- Welded Heat Shield.
- ◆ Resonator.
- # Special Style, not shown.
- @ Stainless.
- ‡ Threaded.
- § Tractor.
- AS Aluminized Spout.
- CT Chrome Tip.
- SB Spherical Ball.
- SF Spherical Flare Loose Flange.
- SP Spout.
- ST Stainless Tip.
- WF Welded Flange.
- WP Welded Pipe.
- WS Welded Spout.

INFORMATION & BUILD TO ORDER
 TOOLS AND ACCESSORIES
 SCHOOL BUS
 MEDIUM DUTY TRUCK GVV 3-6
 HEAVY DUTY TRUCK GVV 7-8
 APPLICATION BY ENGINE
 NOISE AND BACKPRESSURE DATA
 TRACTOR
 MUFFLER SPECS
 O.E. CROSS INDEX

TABLE 2 - MUFFLER SPECIFICATIONS BY INLET SIZE

Part No.	Style	Inlet ID (A)	Shell Dia. (B)	Shell Length (C)	Overall Length (D)	Outlet ID (E)	Inlet Offset (F)	Outlet Offset (G)
21581	◆	7	3½	7	12	17⅝	3½	
21467	▲	1	3½	7	12	20	3½	
22764	‡	1	3½	7	15	19¾	3½	
21751		8	3½	7	15	22⅞	4 OD	
21101		1	3½	7	26¼	32½	3	
21470	▲	1	3½	7	30	38	3½	
22768	▲	10	3½	8¼ x 11½	26	29½	3½	2½
22214	▲	9	3½	8¼ x 11½	26	30	4	2½ 14¾
21832	▲	2	3½	8¼ x 11½	26	32¼	4	2½ 2½
22632	▲	2	3½	8¼ x 11½	26	33	3½	2½ 2½
22391	▲	9	3½	8¼ x 11½	28	31	4 OD	2½ 12
22551	▲	2	3½	8¼ x 11½	30	36	4	2¾ 2½
21074	▲	9	3½	8¼ x 11½	31½	34¾	4 OD	2½ 7⅞
21300	4	3½	8¼ x 11½	32	34¾	4 OD	2½	2½
21073	▲	9	3½	8¼ x 11½	32	34⅞	4 OD	2½ 21¼
21299	2	3½	8¼ x 11½	32	36	4	2¾	2½
21072	▲	4	3½	8¼ x 11½	32	38½	4 SP	2½ 2½
22604	▲	9	3½	8¼ x 11½	32	39⅞	4	2½ 11⅞
21168	9	3½	8¼ x 11½	32	35	4	2½	12
22808	▲	2	3½	8⅞	36½	43	3	1¾ 1¾
21173	1	3½	9	24	31	3½		
22961	1	3½	9	36	43	3½		
22844	▲	1	3½	9	45	51	3½	
22957	1	3½	9	45	51½	3½		
21143	10	3½	10	35½	39¾	3½		
21088	▲	1	3½	11	22¾	28¾	3½	
21086	4	3½	11⅞	30	36½	3½	2¾	2¾
22657	13	3¾	6⅞	27½	27½	4 OD	3½	3½
21059	2	3¾ OD	8¼ x 11½	30	37¾	5 OD	2½	2¼
24217	1	4	5	12	16½	4		
21057	2	4	6⅞ x 10⅞	18¼	26⅞	4 OD	2½	2½
21464	▲	1	4	7	12	20	4	
21471	▲	1	4	7	27¼	36	4	
21164	1	4	7	32½	39	4		
22810	▲	1	4	7	40	48	4	
22570	▲	10	4	8¼ x 11½	16	21½	4	3⅞ 2½
21153	2	4	8¼ x 11½	22	28	3½	3	3
21154	2	4	8¼ x 11½	27	32	3½	2½	2½
22004	▲	2	4	8¼ x 11½	27	33¼	4	2½ 2½
22006	▲	9	4	8¼ x 11½	28	31	4	2½ 12
21071	▲	23	4	8¼ x 11½	28½	31	4	5¼ 2½
22449	▲	2	4	8¼ x 11½	32	37¼	4	2½ 2½
22935	2	4	8¼ x 11½	39½	45	4	2½	2½
21582	◆	7	4	8⅞	14⅞	21¼	4	
21171	▲	1	4	8⅞	20	25¾	4	
21443	1	4	8⅞	25	33½	3 OD	2	1¾
22827	▲	3	4	8⅞	33	41	4	1⅞
21838	▲	1	4	8⅞	33½	40	4	
21172	1	4	9	15	22	4		
22631	‡	1	4	9	20	26	4	
22572	▲	1	4	9	20	27	4	
22571	▲	1	4	9	28	34½	4	
22959	1	4	9	40	48	4		
22948	10	4	9	44	48	5	3⅞	
22936	▲	1	4	9	44	51	4	
22960	2	4	9	44	51	4	1⅞	1⅞
22965	1	4	9	44	51	4		
22970	1	4	9	44	51	5		
22834	1	4	9	44½	51	4		
22896	1	4	9	44½	51	5		
22941	▲	1	4	9	44½	51	5	
21131	2	4	10	26½	33	3	2	1⅞
21137	4	4	10	28⅞	32⅞	4	2⅞	2⅞
21139	9	4	10	36	38½	4		3⅞
22962	1	4	10	44	51	5		
22966	1	4	10	44	51	5		
22969	1	4	10	44	51	4		

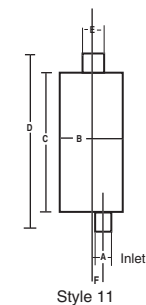
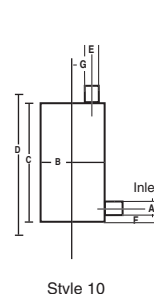
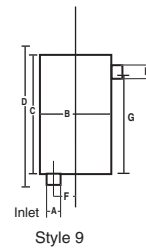
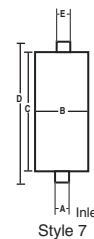
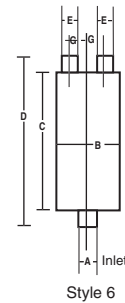
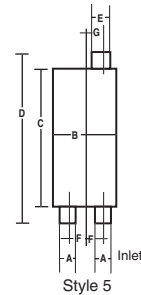
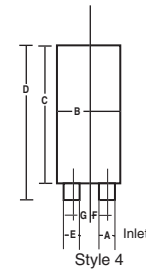
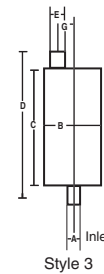
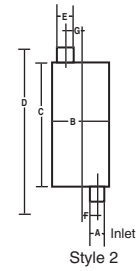
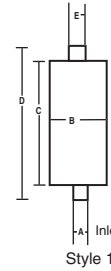

- ▲ Arc Welded.
- ‡ Double-Wall.
- ◆ Spark Arrestor.
- Welded Heat Shield.
- ⚡ Resonator.

- # Special Style, not shown.
- @ Stainless.
- ‡ Threaded.
- § Tractor.

- AS Aluminized Spout.
- CT Chrome Tip
- SB Spherical Ball.
- SF Spherical Flare Loose Flange.
- SP Spout.

- ST Stainless Tip
- WF Welded Flange.
- WP Welded Pipe.
- WS Welded Spout.

TABLE 2 - MUFFLER SPECIFICATIONS BY INLET SIZE

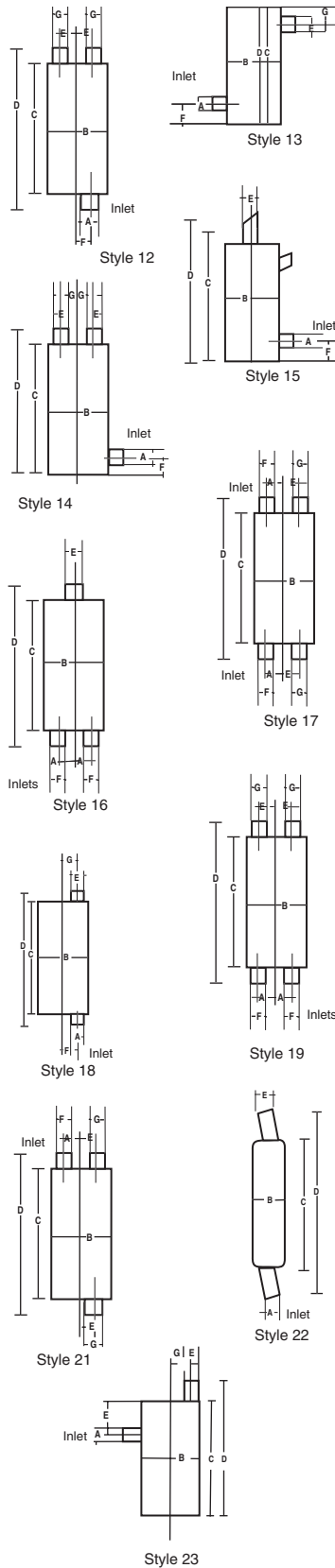

Part No.	Style	Inlet ID (A)	Shell Dia. (B)	Shell Length (C)	Overall Length (D)	Outlet ID (E)	Inlet Offset (F)	Outlet Offset (G)
22952	1	4	10	44	51 ⁷ / ₁₆	5		
22916▲	1	4	10	45	51 ¹ / ₂	4		
22949	1	4	10	45 ¹ / ₄	51 ¹ / ₂	4		
22785	9	4	10 x 15	15	19 ¹ / ₄	4	4 ¹ / ₄	4
21971▲	10	4	10 x 15	16	19 ¹ / ₂	3 ¹³ / ₁₆ OD	3	4 ³ / ₈
21161	10	4	10 x 15	21 ¹ / ₈	25 ¹ / ₄	5	3	4 ¹ / ₄
22786	9	4	10 x 15	22	25	4	4 ¹ / ₄	14 ³ / ₄
21149	9	4	10 x 15	25 ¹ / ₂	29 ¹ / ₂	4 OD	5	5
21923▲	4	4	10 x 15	26	29 ¹ / ₄	4	3 ³ / ₄	3 ³ / ₄
21174▲	2	4	10 x 15	26	33	4	4 ¹ / ₄	4 ¹ / ₄
21083	10	4	10 x 15	27	29 ³ / ₄	5	2 ² / ₈	3 ⁵ / ₈
22665▲	9	4	10 x 15	30	33	4	3 ³ / ₄	7 ¹ / ₂
21085	2	4	10 x 15	34	40 ¹ / ₂	5	4 ¹ / ₄	4 ¹ / ₄
22555	9	4	10 x 15	36	39	4	3 ³ / ₄	7 ¹ / ₂
21175	4	4	10 x 15	36	39 ¹ / ₂	4	1 ¹ / ₄	4 ¹ / ₂
22919▲	9	4	10 x 15	44	47 ³ / ₄	4	4 ¹ / ₄	5 ¹ / ₄
22943	2	4	10 x 15	44	50 ¹ / ₂	5	3 ¹ / ₈	3 ¹ / ₈
21968▲	9	4	10 ¹ / ₈	27 ³ / ₄	31	4	2 ¹ / ₂	3 ¹ / ₂
21833▲	2	4	10 ¹ / ₈	27 ³ / ₄	33 ¹ / ₂	4	2 ¹ / ₂	2 ¹ / ₂
22775▲	13	4	10 ¹ / ₈	28	28	4	4 ¹ / ₂	9 ¹ / ₂
21837▲	4	4	10 ¹ / ₈	28	31	4	2 ¹ / ₂	2 ¹ / ₂
21969▲	9	4	10 ¹ / ₈	28	31	4	2 ¹ / ₂	20 ¹ / ₂
22634▲	10	4	10 ¹ / ₈	28	32 ¹ / ₂	4	4 ¹ / ₂	2 ¹ / ₂
22717	2	4	10 ¹ / ₈	34	40	4	2 ¹ / ₂	2 ¹ / ₂
21970	9	4	10 ¹ / ₈	36	39	4	2 ¹ / ₂	30 ¹ / ₂
22842	3	4	10 ¹ / ₈	44 ¹ / ₂	51	4		2 ¹ / ₂
22835†▲	3	4	10 ¹ / ₂	44	51	4		2 ⁷ / ₁₆
22789▲	2	4	11	30	36	4	2 ¹ / ₂	2 ¹ / ₂
22967	1	4	11	35	39 ³ / ₄	4		
22958	10	4	11	36	40	4	3 ³ / ₈	2 ³ / ₈
21069▲	13	4	11 ¹ / ₈	36	36	4 OD	4 ¹ / ₄	22
22642▲	13	4	11 ¹ / ₈	36	36	4 OD	4 ¹ / ₄	6 ³ / ₄
22667	13	4	11 ¹ / ₈	36	36	4	4 ¹ / ₄	18
22643▲	10	4	11 ¹ / ₈	36	39	4	4 ¹ / ₄	2 ¹ / ₂
22664▲	9	4	11 ¹ / ₈	36	39	4	1 ¹ / ₂	7 ¹ / ₂
22668▲	9	4	11 ¹ / ₈	36	39	4	2 ¹ / ₂	3 ⁷ / ₈
22669▲	9	4	11 ¹ / ₈	36	39	4	2 ¹ / ₂	3 ⁷ / ₈
22888▲	2	4	11 ¹ / ₈	36	41 ³ / ₄	4	2 ¹ / ₂	2 ¹ / ₂
22899▲	2	4	11 ¹ / ₈	36	42 ¹ / ₄	4	2 ¹ / ₂	2 ¹ / ₂
24233	1	5	6	16	21	5		
21835▲	7	5	9	11 ¹ / ₂	20	5		
21584▲	7	5	9	12	20 ¹ / ₂	5 OD		
22771▲	1	5	9	20	26 ¹ / ₂	5		
22914▲	1	5	9	33 ¹ / ₂	40	5		
22829	1	5	9	44	51	5		
22964	1	5	9	44	51	5		
22940▲	1	5	9	44 ¹ / ₂	51	5		
22823	1	5	9	45	51	5		
22596▲	9	5	9 x 14	18 ¹ / ₂	22	5	3 ⁷ / ₈	14
22920▲	1	5	10	44	51	5		
22924▲	1	5	10	44	51	5		
22925	1	5	10	44	51	5		
22956	1	5	10	44	51 ¹ / ₂	5		
22963	1	5	10	44	51	5		
22980	1	5	10	44	51	5		
22981	1	5	10	44	51	5		
22938▲	1	5	10	60	66 ¹ / ₂	5		
21147	10	5	10 x 15	16	20 ¹ / ₂	5	4	1 ¹ / ₂
22662	10	5	10 x 15	16	20 ¹ / ₂	5	4	1 ¹ / ₂
22381▲	4	5	10 x 15	25	29	5	3	3
22452▲	13	5	10 x 15	26	26	5	4	4
22552▲	2	5	10 x 15	26	33	5	3 ³ / ₈	3 ³ / ₈
21070▲	23	5	10 x 15	27	29 ³ / ₄	5	4 ⁵ / ₈	3 ⁵ / ₈
21167	13	5	10 x 15	30	30	5	3 ¹ / ₂	4
22337▲	9	5	10 x 15	35 ¹ / ₂	35 ¹ / ₂	5	3 ³ / ₄	7 ¹ / ₂
22833▲	2	5	10 x 15	36	43	5	4	4
22917▲	10	5	10 x 15	36	40	5	6 ¹ / ₈	3 ¹ / ₈

- ▲ Arc Welded.
- † Double-Wall.
- ◆ Spark Arrestor.
- Welded Heat Shield.
- ◇ Resonator.

- # Special Style, not shown.
- @ Stainless.
- ‡ Threaded.
- § Tractor.

- AS Aluminized Spout.
- CT Chrome Tip.
- SB Spherical Ball.
- SF Spherical Flare Loose Flange.
- SP Spout.

- ST Stainless Tip.
- WF Welded Flange.
- WP Welded Pipe.
- WS Welded Spout.

INFORMATION & BUILD TO ORDER
 TOOLS AND ACCESSORIES
 SCHOOL BUS
 MEDIUM DUTY TRUCK GVV 3-6
 HEAVY DUTY TRUCK GVV 7-8
 APPLICATION BY ENGINE
 NOISE AND BACKPRESSURE DATA
 TRACTOR
 MUFFLER SPECS
 O.E. CROSS INDEX

TABLE 2 - MUFFLER SPECIFICATIONS BY INLET SIZE

Part No.	Style	Inlet ID (A)	Shell Dia. (B)	Shell Length (C)	Overall Length (D)	Outlet ID (E)	Inlet Offset (F)	Outlet Offset (G)
22944	2	5	10 x 15	44	50½	5	3⅞	3⅞
22951	2	5	10 x 15	44	50	5		
22971	4	5	10 x 15	44	47	5	3 ¹⁹ / ₃₂	3 ¹⁹ / ₃₂
22915▲	10	5	10½	44	48	5	6	
21165	9	5	11	36	39	5	2½	7½
22950	9	5 OD	12	36	40	5 OD		21½
21084▲	23	5	12¼ x 15	27	29¾	5	4½	3⅞
22907▲	2	6	10 x 15	31¾	42½	6	3½	3½
22774	7	6	10½	13¼	23½	6		
22040§	11	SF	4⅝ x 8⅜	19	32	1 ¹³ / ₁₆ OD	2¼	½
22041§	1	SF	4⅝ x 8⅜	33	38	3½ OD		
22910▲	2	SF	6	29	36	2	1⅜	1⅜
22877▲	2	SF	7	35	44	2¾	1⅞	1⅞
22878	2	SF	7	35	44	SB	1⅞	1⅞
22906@	2	SF	7⅞	35	44	SB	1¾	1¾
22566▲@	5	SF	8¾	30⅞	39	3 OD	2⅜	2⅜
22897@	5	SF	9⅞	40	50	4	1⅞	2
22028§	1	SPECIAL	3¼	17	32½	1½ OD		
22405	1	SPECIAL	3¼ x 7¾	17	22	2		
22018§	1	WF	3¼	13½	20½	1½		
21036§	1	WF	3¾	19⅞	21	2⅞		
21995	1	WF	SPECIAL	37	38	WF		
21194	11	WF	4¼ x 9¾	20	25½	2¼	2⅞	
21363	11	WF	4¼ x 9¾	20	25½	2¼	2⅞	
22392	2	WF	5	24	25¾	WF	1½	1½
22485	2	WF	5	27	29½	WF	1¼	1¼
21301	5	WF	5½ x 11	20	30	2¼	3½ (2)	
21195	11	WF	5½ x 11	27	32½	2¼	3½	
21364	11	WF	5½ x 11	27	32½	2¼	3½	
21368	11	WF	7 x 9	21	39⅞	2¾ OD	2⅞	
21091	1	WF	8⅞	25⅞	35⅞	3		
22716	1	WF	9½	24	32	3 OD		
21082	11	WP	4¼ x 9¾	19	35	2 OD	2⅞	
21053	11	WP	4¼ x 9¾	24	37½	3	2⅞	
21056	11	WP	4¼ x 9¾	24	36¾	3	2⅞	
21079	12	WP	7	28	39	2¼	1¾	1¾
22575	11	WP	4¼ x 9¾	28	41	2½	2⅞	
22792	2	WP	7 x 9	20		2	2⅞	2⅞

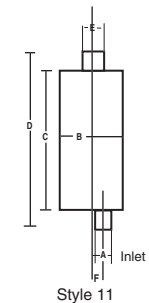
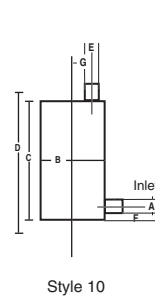
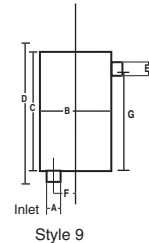
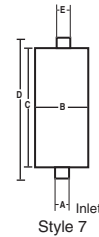
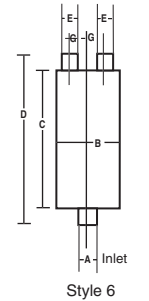
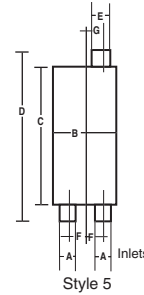
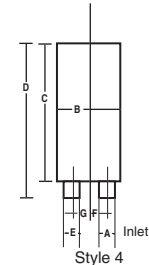
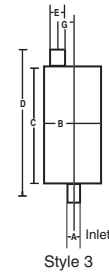
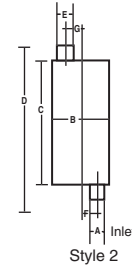
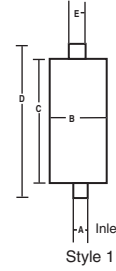

- ▲ Arc Welded.
- † Double-Wall.
- ◆ Spark Arrestor.
- Welded Heat Shield.
- ↕ Resonator.

- # Special Style, not shown.
- @ Stainless.
- ‡ Threaded.
- § Tractor.

- AS Aluminized Spout.
- CT Chrome Tip
- SB Spherical Ball.
- SF Spherical Flare Loose Flange.
- SP Spout.

- ST Stainless Tip
- WF Welded Flange.
- WP Welded Pipe.
- WS Welded Spout.