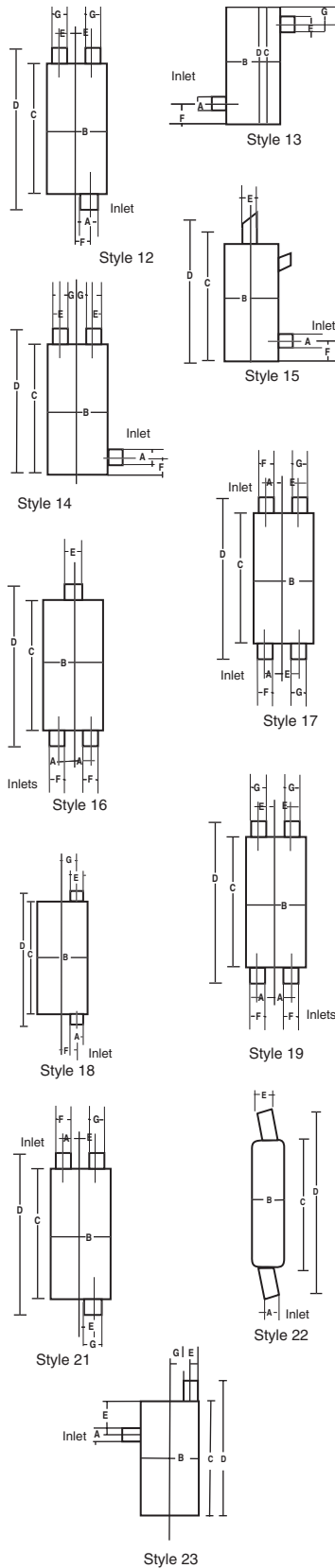

TABLE 1 - MUFFLER SPECIFICATIONS BY PART NUMBER



Part No.	Style	Inlet ID (A)	Shell Dia. (B)	Shell Length (C)	Overall Length (D)	Outlet ID (E)	Inlet Offset (F)	Outlet Offset (G)
21012	2	1 3/8	6	10	18 1/2	1 1/2	1 1/2	1 1/2
21028	1	2	5	21	25 3/4	1 3/16 OD		
21030	2	2	7	17	20 1/2	2	2 1/4	2 1/4
21031	11	2 1/4	4 1/4 x 9 3/4	13	23	1 7/8	2 7/8	
21032	1	1 3/4	4 1/4 x 9 3/4	20	24	2		
21033§	1	2 1/4	4 1/4	22 1/2	26 3/4	2 1/4		
21034	4	2 1/8	7 x 9	17	19	2		2 5/8
21035§	1	1 1/2	3 1/4	24	34 1/4	1 1/2 OD		
21036§	1	WF	3 3/4	19 7/8	21	2 3/8		
21037	11	2	4 1/4 x 9 3/4	20	24	2	2 7/8	
21038	3	2	7 x 9	18	21	1 3/4		2 5/8
21039§	1	2	4 5/8	15 1/2	28 3/8	2		
21040§	1	1 3/8	3 1/4	9 1/2	22 1/4	1 3/8		
21041§	1	2 3/8	4 1/2	11	21	2 3/8		
21042	1	2 1/4	4	18	26 3/4	2 1/4 AS		
21043	2	2 1/4	4 1/4 x 9 3/4	19	21	2	3	3
21044	3	2 3/4	7 x 9	18	24	2 1/2	2 5/8	
21045	3	2 1/4	4 1/4 x 9 3/4	21	26	2 1/4	2 7/8	
21046	2	2 3/4	7 x 9	24	29	2 3/4 OD	2 5/8	2 5/8
21047	3	2 1/2	7 x 9	18	22	2 1/2	2 5/8	
21048	2	2 1/4	3 1/4 x 7 3/4	8	12 1/2	3 SB	2 1/2	2 1/2
21049	2	2 1/4	3 1/4 x 7 3/4	8	12 1/2	2 1/4 SB	2 1/2	2 1/2
21050	1	3	5	24	36	3 OD		
21051	11	3	4 1/4 x 9 3/4	21	27	3 3/16	2 7/8	
21053	11	WP	4 1/4 x 9 3/4	24	37 1/2	3	2 7/8	
21054	11	3	4 1/4 x 9 3/4	24	29	3	2 7/8	
21056	11	WP	4 1/4 x 9 3/4	24	36 3/4	3	2 7/8	
21057	2	4	6 1/8 x 10 1/8	18 1/4	26 5/8	4 OD	2 1/2	2 1/2
21058	2	2 7/8	4 5/8 x 8 5/8	27	34 1/2	2 5/8 OD	1 3/8	2 1/2
21059	2	3 3/4 OD	8 1/4 x 11 1/2	30	37 3/4	5 OD	2 1/2	2 1/4
21060§	1	2 3/8	5 5/8	17 3/4	32	2 1/2 OD		
21061	10	3 1/8	10 1/8	17 1/4	24 1/2	3 OD	14 1/2	1 1/2
21062	12	2	7	17	30 1/2	1 7/8 AS	2 1/4	2 1/4
21063	11	2 1/2	4 1/4 x 9 3/4	22	31	2 1/2	2 7/8	
21064	3	2	4 1/4 x 8 13/16	18	21	2	1 1/2	2 5/8
21065	2	2 3/4	7 x 9	24	29	2 3/4 OD	2 5/8	2 5/8
21066	11	2 1/4	4 1/4 x 9 3/4	22	31	2 1/4 AS	3	
21068	12	2 3/4	7	26	30	2 (2)	1 3/4	1 3/4
21069▲	13	4	11 1/8	36	36	4 OD	4 1/4	22
21070▲	23	5	10 x 15	27	29 3/4	5	4 5/8	3 5/8
21071▲	23	4	8 1/4 x 11 1/2	28 1/2	31	4	5 1/4	2 1/2
21072▲	4	3 1/2	8 1/4 x 11 1/2	32	38 1/2	4 SP	2 1/2	2 1/2
21073▲	9	3 1/2	8 1/4 x 11 1/2	32	34 7/8	4 OD	2 1/2	21 1/4
21074▲	9	3 1/2	8 1/4 x 11 1/2	31 1/2	34 3/4	4 OD	2 1/2	7 5/8
21075	12	3	7	28	32 1/2	2 (2)	1 3/4	1 3/4
21076	12	3	7	28	35 1/2	2 (2)	1 3/4	1 3/4
21077	11	1 3/4	4 1/2 x 11	15	22	2 AS	3	
21078	12	2 1/4	7	25	29	2 (2)	1 3/4	1 3/4
21079	12	WP	7	28	39	2 1/4	1 3/4	1 3/4
21080	2	1 3/4	7 x 9	16	23	1 3/4 AS	2 5/8	2 5/8
21081	12	2	5 1/2 x 11	19	32	1 1/2 CT	3 3/4	3 3/4
21082	11	WP	4 1/4 x 9 3/4	19	35	2 OD	2 7/8	
21083	10	4	10 x 15	27	29 3/4	5	22 3/8	3 5/8
21084▲	23	5	12 1/4 x 15	27	29 3/4	5	4 1/2	3 5/8
21085	2	4	10 x 15	34	40 1/2	5	4 1/4	4 1/4
21086	4	3 1/2	11 1/8	30	36 1/2	3 1/2	2 3/4	2 3/4
21087	1	3 1/8	9 5/8	22 3/4	28 3/4	3 1/8		
21088▲	1	3 1/2	11	22 3/4	28 3/4	3 1/2		
21089	4	3 3/16	11 1/8	27 1/2	30	3	3	3
21090	1	3	8 1/4 x 11 1/2	31 1/2	37 3/4	3 1/8		
21091	1	WF	8 3/8	25 3/8	35 3/8	3		
21092	3	2 1/2	7 x 9	26	32	2 1/2		2 5/8
21093	3	2 1/2	7 x 9	16	21	2 1/2	1 5/8	2 5/8
21094	6	2	7 x 9	19	31 1/2	1 3/4 CT		2 5/8
21095▲	6	2 1/4	7	22	27 1/2	2 (2)	1 3/4	1 3/4
21097	2	2 1/2	6	29	35	2 1/2	1 1/2	1 1/2
21099▲	11	2 1/2	4 1/8 x 9	25	30	2 1/4	2 7/8	

▲ Arc Welded.
 † Double-Wall.
 ◆ Spark Arrestor.
 □ Welded Heat Shield.
 ◇ Resonator.

Special Style, not shown.
 @ Stainless.
 † Threaded.
 § Tractor.

AS Aluminized Spout.
 CT Chrome Tip
 SB Spherical Ball.
 SF Spherical Flare Loose Flange.
 SP Spout.

ST Stainless Tip
 WF Welded Flange.
 WP Welded Pipe.
 WS Welded Spout.

INFORMATION & BUILD TO ORDER

TOOLS AND ACCESSORIES

SCHOOL BUS

MEDIUM DUTY TRUCK GVV 3-6

HEAVY DUTY TRUCK GVV 7-8

APPLICATION BY ENGINE

NOISE AND BACKPRESSURE DATA

TRACTOR

MUFFLER SPECS

O.E. CROSS INDEX

TABLE 1 - MUFFLER SPECIFICATIONS BY PART NUMBER

Part No.	Style	Inlet ID (A)	Shell Dia. (B)	Shell Length (C)	Overall Length (D)	Outlet ID (E)	Inlet Offset (F)	Outlet Offset (G)
21101	1	3½	7	26¼	32½	3		
21102▲	11	2¼	4½ x 9	16	27¼	2¼	2⅞	
21103	3	2½	4½ x 9	28	33	2½		2⅞
21104	11	2¼	4½ x 9	19	24	2	2⅞	
21105▲	2	1¾	5½ x 11	18	27½	1⅝ OD	3¾	3¾
21106	12	2	7 x 9	19	33	1¾ CT	2⅞	2⅞
21108	11	2	7 x 9	13	21	1¾ AS	2⅞	
21109	2	2½	4¼ x 9¾	19	23	2½	3	3
21110	2	2¼	4¼ x 9¾	19	23	2	3	3
21111	2	2¼	4¼ x 9¾	19	23	2	3	3
21112	6	2	7 x 9	19	29½	1¾ AS		2⅞
21114	2	2¼	4¼ x 9¾	20	24	2¼	2⅞	2⅞
21115	11	2	4¼ x 9¾	20	32⅞	2 AS	2⅞	
21116	6	2½	4¼ x 9¾	23	26½	2¼		2⅞
21118	14	2 WF	5½ x 11	20	38	1¾ AS		3¾
21119	2	1¾	4¼ x 8⅜	16	25	1¾	2⅞	2⅞
21120	11	1¾	4¼ x 8⅜	9	24¾	2 AS	2⅞	
21121	16	2	4¼ x 9¾	20	41½	2 ST	2⅞	
21122	1	2¼	4	11¼	22½	2½ AS		
21123	11	2	4¼ x 9¾	20	33¾	1¾ AS	2⅞	
21124	2	2	7 x 9	17	21	2 AS	2⅞	2⅞
21125	2	2	7 x 9	17	21	2 AS	2⅞	2⅞
21126	12	2	5½ x 11	17	27	1½ ST	3¾	3¾
21127	2	1¾	4¼ x 9¾	21	24	1¾	2⅞	2⅞
21128	12	1⅞	5½ x 11	18	27½	1⅞ AS	3¾	3¾
21129 #		1¾	SPECIAL	20	25¼	1¾		
21130	11	1⅞ WF	4¼ x 8⅜	12	23½	1⅞		
21131	2	4	10	26½	33	3	2	1⅞
21132	1	2	4	11¼	24	2 AS		
21133	1	2	4	11¼	24	2 AS		
21134	11	2½	4½ x 9¾	21	32⅞	2¼ OD	2⅞	
21135	11	2	5½ x 11	19	30½	2 OD	3¾	1
21136	11	2	7 x 9	14	17½	1⅞	2⅞	
21137	4	4	10	28⅞	32⅞	4	2⅞	2⅞
21138	1	3	6	26	36½	3		
21139	9	4	10	36	38½	4		3⅞
21140	2	1¾	5½ x 11	12	21	1¾ OD		3½
21141	2	2	5½ x 11	12	21	2 OD		3½
21143	10	3½	10	35½	39¾	3½		
21146	1	3	7	12	20	3		
21147	10	5	10 x 15	16	20½	5	4	1½
21149	9	4	10 x 15	25½	29½	4 OD	5	5
21150	2	3	8¼ x 11½	17	23	3 OD		
21151▲	2	2½	6½	23	27¾	2¼	1½	1½
21152▲	2	2¾	7	29¾	36¼	2¼	1¾	1¾
21153	2	4	8¼ x 11½	22	28	3½	3	3
21154	2	4	8¼ x 11½	27	32	3½	2½	2½
21155	10	3⅞	8¼ x 11½	32	35½	3⅞	5	
21161	10	4	10 x 15	21⅞	25¼	5	3	4¼
21163	1	2½	6	24	30	2½		
21164	1	4	7	32½	39	4		
21165	9	5	11	36	39	5	2½	7½
21167	13	5	10 x 15	30	30	5	3½	4
21168	9	3½	8¼ x 11½	32⅞	35	4	2½	12
21169▲	2	2	6	22½	29	2	1⅞	1⅞
21171▲	1	4	8⅞	20	25¾	4		
21172	1	4	9	15	22	4		
21173	1	3½	9	24	31	3½		
21174▲	2	4	10 x 15	26	33	4	4¼	4¼
21175	4	4	10 x 15	36	39½	4	¼	4½
21179	11	2¼	5½ x 11	23	26½	2	3½	
21180 #		2¼	5½ x 11	23	26½	2	3½	3½
21181	10	2¼ OD	5½ x 11	20	36½	1¾		1½
21182	11	2	5½ x 11	19	36½	2 OD	1½	
21183 #		2⅞ WF OD	5½ x 11	19	39	SP	3¾	1
21184	11	1½ OD	7 x 9	14	28	1½ OD	2⅞	1⅞
21185	14	2¼ OD	5½ x 11	20	36½	1¾		

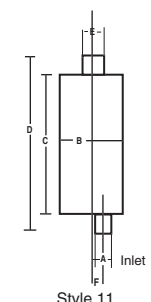
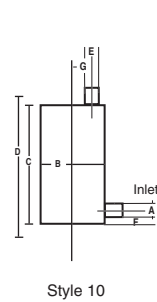
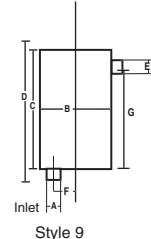
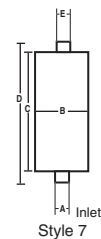
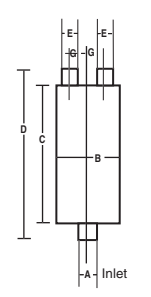
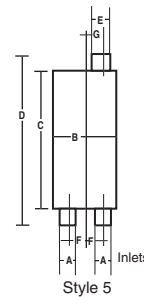
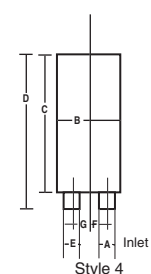
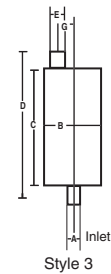
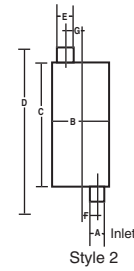
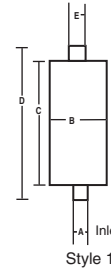

- ▲ Arc Welded.
- † Double-Wall.
- ◆ Spark Arrestor.
- Welded Heat Shield.
- ◇ Resonator.

- # Special Style, not shown.
- © Stainless.
- ‡ Threaded.
- § Tractor.

- AS Aluminized Spout.
- CT Chrome Tip
- SB Spherical Ball.
- SF Spherical Flare Loose Flange.
- SP Spout.

- ST Stainless Tip
- WF Welded Flange.
- WP Welded Pipe.
- WS Welded Spout.

TABLE 1 - MUFFLER SPECIFICATIONS BY PART NUMBER

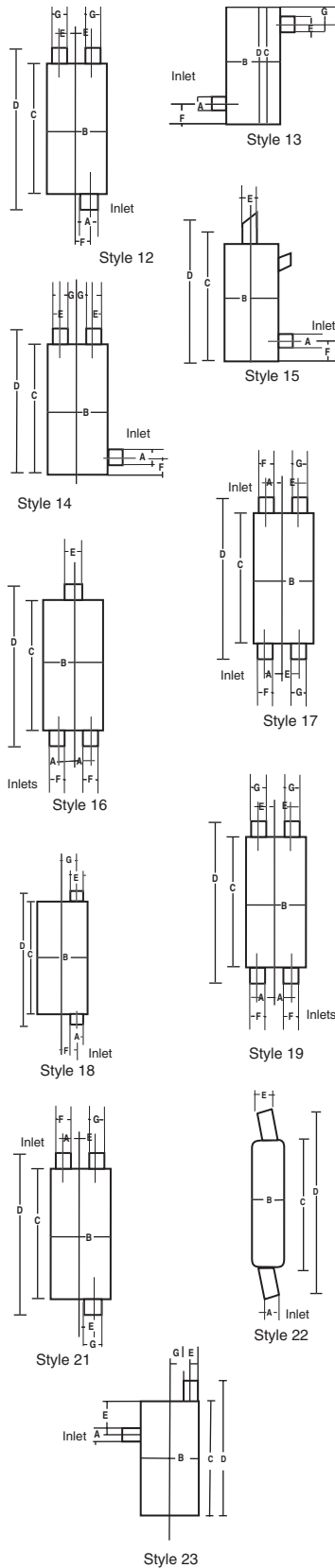

Part No.	Style	Inlet ID (A)	Shell Dia. (B)	Shell Length (C)	Overall Length (D)	Outlet ID (E)	Inlet Offset (F)	Outlet Offset (G)
21186	12	2¼	5½ x 11	19	35½	1⅝	3¾	
21188§	1	2	4¼	12¾	17	2		
21190	11	2	4¼ x 9¾	21	25½	2	2⅞	
21191 #	2¼	2¼	4¼ x 9¾	18	27½	2¼ OD		3
21192	11	2	4¼ x 9¾	21	25½	2 OD	2⅞	
21193	11	2¼	4¼ x 9¾	21	34½	2¼ OD	2⅞	
21194	11	WF	4¼ x 9¾	20	25½	2¼	2⅞	
21195	11	WF	5½ x 11	27	32½	2¼	3½	
21196	2	2	7 x 9	20	26½	2 OD	2⅝	2⅝
21197	7	1½	4¼ x 8 ¹³ / ₁₆	11	14½	1½ OD		½
21198	2	2	5½ x 11	16	26⅝	2¼ OD	3¼	1
21199	2	2	4¼ x 9¾	16	19½	2 OD	2⅞	2⅞
21200	3	2¼	4¼ x 9¾	16	19¼	2¼	⅝	2⅞
21201 #	2	2	4¼ x 9¾	20	24	2		
21203	2	2	5½ x 11	15	26⅝	2¼ OD	3¼	1
21204	11	2½	4¼ x 9¾	21	32	2¼ OD	2⅞	
21206	11	2¼	4¼ x 9¾	19	24½	2	2⅞	
21207	11	2	5½ x 11	20	34	2 OD	3	
21209	2	2	5½ x 11	15	26⅝	2¼ OD	3¼	1
21250	11	2	5½ x 11	16	27¾	2 OD	3¼	1
21252	11	2	5½ x 11	15	16½	2 OD	3¼	1
21253	10	2¼	5½ x 11	20	27 ³ / ₁₆	2 OD	1⅝	1⅝
21254	10	2¼	5½ x 11	20	27 ³ / ₁₆	2¼ OD		
21257	7	1½	4¼ x 8 ⁷ / ₈	11	27	1½ OD		½
21259	2	2½	6	29	34¼	2⅝ OD	1½	1½
21260▲	5	2½	7	28	34½	2½	1⅞	1⅞
21262	11	2½	4¼ x 9¾	21	31½	2¼ OD	2⅞	
21263	11	2	5½ x 11	20	38	WS	3½	
21264	11	2	5½ x 11	20	38	WS	3½	
21265	11	2	5½ x 11	20	38	WS	3½	
21266	11	2	5½ x 11	20	39	WS	3½	
21267	11	2	5½ x 11	20	39	WS	3½	
21268	11	2	5½ x 11	20	38	WS	3½	
21272	3	2¼	4¼ x 9¾	25	30	2		2⅞
21275	3	2¼	4¼ x 9¾	25	37	2		2⅞
21276	3	2¼	4¼ x 9¾	20	24	2¼		3
21277	2	2¼	4¼ x 8 ¹³ / ₁₆	16	18½	2¼	2⅝	2⅝
21278	2	2¼	4¼ x 8 ¹³ / ₁₆	16	18½	2¼	2⅝	2⅝
21279	2	2	4¼ x 9¾	19	27	2 OD	2⅞	2⅞
21280	2	2	4¼ x 9¾	19	29	2 OD	2⅞	2⅞
21281	1	2	3	14¼	17¾	1¾		
21282	5	2	7 x 9	24	29	2¾ OD		2⅝
21283	11	2¼	4¼ x 9¾	19	33	2¼ OD	3	
21284	11	2	5½ x 11	18	29	1¾ OD	3½	
21285	11	2	5½ x 11	18	30¼	2 (2) OD	3½	
21286	2	2¼	7 x 9	20	24	2½	2	2
21287	2	2	6	26	33	2	1½	1½
21288 #	2½	2½	4¼ x 9¾	23	27½	2 (2)	2⅞	2⅞
21289	5	2	7 x 9	22	26	2¾ OD	1⅝	1⅝
21290 #	2¼	2¼	4¼ x 9¾	18	31¼	2 OD		3
21291	5	2	7 x 9	22	26	2¾ OD	1⅝	1⅝
21292	2	2½	7 x 9	22	26	2½	1⅝	1⅝
21299	2	3½	8¼ x 11½	32	36	4	2¾	2½
21300	4	3½	8¼ x 11½	32	34¾	4 OD	2½	2½
21301	5	WF	5½ x 11	20	30	2¼	3½ (2)	
21302	11	2½	5½ x 11	20	24	2¼	3½	
21303	11	2¼	4¼ x 9¾	22	37	2 OD	3	
21304	11	2	5½ x 11	20	37	2 OD	3	
21305	11	2	5½ x 11	20	37	2 OD	3	
21306	2	3 OD	7 x 9	24	35⅝	2½	2	2
21307	10	2¼	5½ x 11	20	26	2⅝ SP OD		
21308†@	5	2½	10	28	38¾	3	3	
21309†	5	2½	10	28	38¾	3	3	
21311	12	2	4¼ x 9¾	19	21¾	1½ (2)	2⅞	0, 2⅞
21312	2	3	9	26	33¾	3 OD	2	
21313	2	3	9	26	33¾	3 OD	2	
21314	3	2	3¼ x 7¾	27	33¾	1⅜ OD		2½

▲ Arc Welded.
 † Double-Wall.
 ◆ Spark Arrestor.
 □ Welded Heat Shield.
 ✦ Resonator.

Special Style, not shown.
 @ Stainless.
 † Threaded.
 § Tractor.

AS Aluminized Spout.
 CT Chrome Tip
 SB Spherical Ball.
 SF Spherical Flare Loose Flange.
 SP Spout.

ST Stainless Tip
 WF Welded Flange.
 WP Welded Pipe.
 WS Welded Spout.

INFORMATION & BUILD TO ORDER

TOOLS AND ACCESSORIES

SCHOOL BUS

MEDIUM DUTY TRUCK GVV 3-6

HEAVY DUTY TRUCK GVV 7-8

APPLICATION BY ENGINE

NOISE AND BACKPRESSURE DATA

TRACTOR

MUFFLER SPECS

O.E. CROSS INDEX

TABLE 1 - MUFFLER SPECIFICATIONS BY PART NUMBER

Part No.	Style	Inlet ID (A)	Shell Dia. (B)	Shell Length (C)	Overall Length (D)	Outlet ID (E)	Inlet Offset (F)	Outlet Offset (G)
21315	2	2¼	7 x 9	20	24	2¼	2	2
21316	11	2	4¼ x 9¾	15	29	2 OD	3	
21317	11	2	4¼ x 9¾	16	29	2 OD	3	
21318	#	2	7 x 9	15	28	2¼ OD	2½	1½
21319	#	2	7 x 9	14	32	2¼ OD	2½	1½
21320	2	1¾	4½ x 9¾	19	26	2 OD	2⅞	2⅞
21321	2	1¾	4¼ x 9¾	19	26	2 OD	2⅞	2⅞
21322	2	1¾	4¼ x 9¾	19	29	1¾ OD	2⅞	2⅞
21323	2	1¾	4¼ x 9¾	19	29	1¾ OD	2⅞	2⅞
21324	4	2	7 x 9	22	30 ^{13/16}	2	2	2
21325	11	2¼ WF	4¼ x 8 ^{13/16}	28	33¼	2¼	2½	
21326	2	2¼	7	24	35¾	2¼	1¾	1¾
21328	11	2	5½ x 11	19	30	2 OD	3¾	1
21331	2	2	6	20	27	1 ^{13/16} OD	1½	1½
21333	11	2¼	5½ x 11	19	30 ^{9/64}	2 OD	3¾	1
21334	2	3	7 x 9	24	33½	2¾ OD	2½	2½
21335	#	1¾	5 x 8	20½	34	1¾	2½	
21336	2	2½	7 x 9	17	20¾	2½	1½	1½
21337	3	2¼	4¼ x 9¾	18	21½	2¼	¾	2⅞
21338	2	2½	7 x 9	30	33¾	2½ OD	1½	1½
21339	11	2¼	4¼ x 9¾	19	32¾	2¼	2⅞	
21341	12	2	5½ x 11	15	29	2¼ OD	3½	
21342	3	2	4¼ x 9¾	20	29	2 OD	2⅞	
21343	11	2	4¼ x 9¾	20	25¼	2	2⅞	
21344	16	2¼ SF	5½ x 11	20	39	2	3½ (2)	
21345	16	2¼ SF	4¼ x 9¾	20	29	2	2⅞ (2)	
21346	11	2¼ OD	5½ x 11	15	27¾	2¼ SP		
21347	2	2½	7 x 9	22	26	2¼	1½	1½
21348	11	1¾	4¼ x 9¾	15	22½	1¾ OD	2⅞	
21349	3	2¾ WF	4⅞ x 9¾	20	38½	2¾		
21350	3	2¾ WF	4⅞ x 9¾	20	36½	2¾		
21351	2	2½	7 x 9	30	37½	2½	1½	1½
21352	3	2¼	7 x 9	24	30	2	1½	2½
21353	11	2	4¼ x 9¾	32	25	2	2⅞	
21354	2	2	4¼ x 8 ^{13/16}	16	19	2	2½	2½
21355	2	2½	7 x 9	24	28	2½	1½	1½
21356	2	2¾	7 x 9	24	29	2¾ OD	1¾	1¾
21357	3	2¼	4½ x 11	20	24½	2¼		2⅞
21358	16	2¼	3¼ x 7¾	16	21½	2¼ OD	1½ (2)	
21360	2	2¼	5½ x 11	17	21½	2¼ OD	3½	3½
21362	11	2¼	4¼ x 9¾	14	24½	2¼ OD	2⅞	
21363	11	WF	4¼ x 9¾	20	25½	2¼	2⅞	
21364	11	WF	5½ x 11	27	32½	2¼	3½	
21366	16	2½ SF	5½ x 11	20	31¾	2¼	3½	
21367	16	3/WF	7 x 9	21	39¾	2¾ OD	2½	
21368	11	WF	7 x 9	21	39¾	2¾ OD	2½	
21372	11	2¼	4¼ x 9¾	14	25	2¼ OD	2⅞	
21373	2	2½	7 x 9	22	26¼	2½	1½	1½
21375	2	2½	5½ x 11	17	21¾	2½ OD	3½	
21377	2	2½	7	26	31	2½	1¾	1¾
21381	2	1¾	7 x 9	14	17¼	2¼	1½	1½
21382	2	1¾	7 x 9	14	17¼	2¼	1½	1½
21384	2	3	7 x 9	24	29	2¾ OD	2½	2½
21385	11	2¼	4¼ x 9¾	17	21	2¼	2⅞	
21386	2	2¼	4¼ x 9¾	19	27½	2 OD	2⅞	2⅞
21387	2	2¼	4¼ x 9¾	19	28½	2 OD	2⅞	2⅞
21389	11	2¼	5½ x 11	16	30½	2 SP OD	3½	
21391	2	3 OD	7 x 9	24	31	2½ OD	2	2
21392	2	1¾	4¼ x 9¾	10	24	2 AS OD	2½	
21393	3	1¾	4¼ x 9¾	20	37¾	2 AS OD	2⅞	
21394	4	1¾	3¼ x 7¾	24	27	1¾		2½
21395	4	2	3¼ x 7¾	28	31	2		2½
21396	3	2½	5½ x 11	26	29½	2½		3½
21398	11	2	5½ x 11	15	21¼	2¼	3½	
21399	11	2¼	5½ x 11	15	30½	2¼ OD	3¾	1
21400	16	2½	7 x 9	24	29	2¾ OD	2½ (2)	1½
21401	12	2½	4¼ x 9¾	14	17	2 OD	2⅞	2⅞ (2)

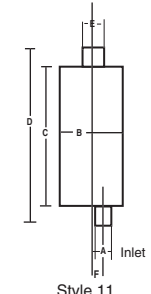
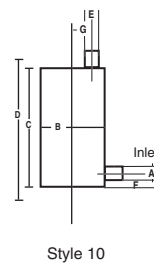
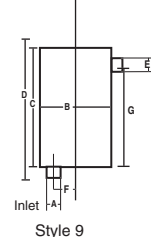
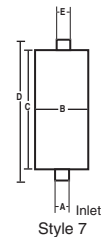
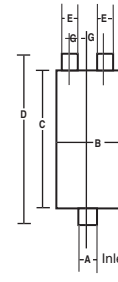
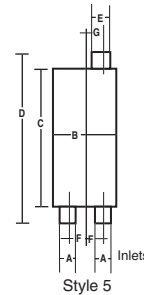
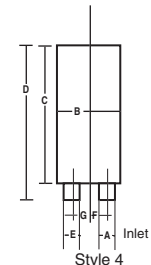
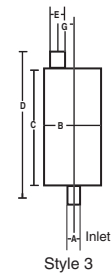
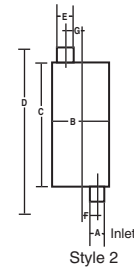
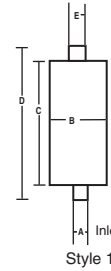

- ▲ Arc Welded.
- † Double-Wall.
- ◆ Spark Arrestor.
- Welded Heat Shield.
- ⚡ Resonator.

- # Special Style, not shown.
- © Stainless.
- ‡ Threaded.
- § Tractor.

- AS Aluminized Spout.
- CT Chrome Tip
- SB Spherical Ball.
- SF Spherical Flare Loose Flange.
- SP Spout.

- ST Stainless Tip
- WF Welded Flange.
- WP Welded Pipe.
- WS Welded Spout.

TABLE 1 - MUFFLER SPECIFICATIONS BY PART NUMBER

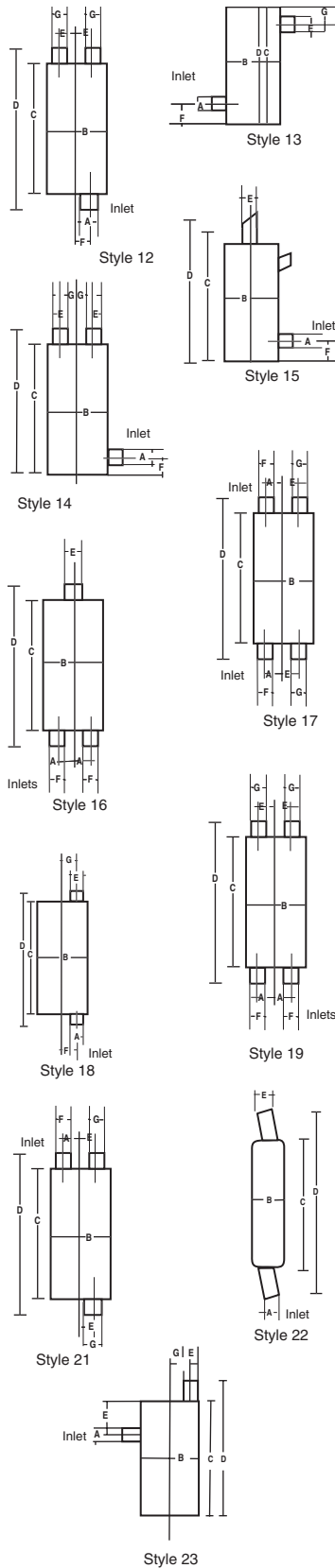

Part No.	Style	Inlet ID (A)	Shell Dia. (B)	Shell Length (C)	Overall Length (D)	Outlet ID (E)	Inlet Offset (F)	Outlet Offset (G)
21405	11	2½	4¼ x 9¾	18	21	2¼ OD	2⅞	
21406	2	3	7 x 9	22	27½	3	1¼	1¼
21407	2	2	7 x 9	14	28¾	2	1½	2⅞
21408	2	2	7 x 9	14	28 ² / ₃₂	2	2⅞	2⅞
21409	3	2½	5½ x 11	27	29	2½		3½
21410	11	2¼	4½ x 8 ¹³ / ₁₆	28	32	2¼ OD	2⅞	
21411	3	2¼	5½ x 11	29	37⅞	2¼		3½
21414	3	2¼	5½ x 11	27	33¾	2¼		3½
21415	2	2¼	4¼ x 9¾	22	25	2¼ OD	2⅞	2⅞
21416	2	2½	4¼ x 9¾	24	27	2¼	2⅞	2⅞
21417	21	2½	4¼ x 9¾	23	27	2¼	2⅞	2⅞
21418	11	1⅞	5½ x 11	15	29 ⁵ / ₁₆	2		
21419	11	1⅞	5½ x 11	15	29 ⁹ / ₃₂	2		
21421	3	2½	5½ x 11	27	44⅞	2½		3½
21422	3	2¼	7 x 9	24	28	2¼	1⅞	2⅞
21423	3	2⅞	7 x 9	24	28	2⅞	1⅞	2⅞
21424	11	2¼	4¼ x 9¾	19	223	2¼		
21426	2	2½	5½ x 11	13	20	2½ OD	3½	
21427	21	2½	4¼ x 9¾	23	26½	2		2⅞
21429	2	1¾	4¼ x 8 ¹³ / ₁₆	10	24	2	2⅞	2⅞
21430	11	2	5½ x 11	29	36⅞	2	3½	
21431	5	2½	7 x 9	24	28	2¾ OD	2⅞	2⅞
21432	3	2¼	5½ x 11	25	30⅞	2¼ OD		3½
21433	2	1⅞	7 x 9	14	28	2¼ AS	1⅞	1⅞
21434	2	1⅞	7 x 9	14	28	2¼ AS	1⅞	1⅞
21435	11	2	4¼ x 9¾	20	27¾	2 WF	2⅞	
21437	12	2½	7 x 9	24	28	2¾ OD	1⅞	1⅞
21438	11	2	4¼ x 9¾	20	24¾	2 WF	2⅞	
21439	2	2½	6	25	33	2	1½	1½
21440	11	2	4¼ x 9¾	20	27¾	2 WF	2	
21441	11	2 OD	4¼ x 9¾	20	27¾	2 WF	2	
21443	1	4	8⅞	25	33½	3 OD	2	1¾
21444	2	2	6	25	31½	2 OD	1½	1½
21447	11	3	7 x 9	26	31	3 OD	2⅞	2⅞
21456	3	2¼	4¼ x 9¾	18	22	2¼ OD		2⅞
21464▲	1	4	7	12	20	4		
21466▲	2	3¼	7	25½	32	2½	1¾	1¾
21467▲	1	3½	7	12	20	3½		
21468▲	1	3	6	21	30	3		
21470▲	1	3½	7	30	38	3½		
21471▲	1	4	7	27¼	36	4		
21473§	1	2½	4⅞	17	27½	2⅞ OD		
21475▲	2	2½	6½	26	35	2½	1½	1½
21476▲	2	3	8⅞	29¾	36¼	3	2	2
21478	1	2¼	7 x 9	25	28	2¼ OD	2⅞	1⅞
21479	11	2	4¼ x 9¾	19	23½	2 OD	2⅞	
21480	11	2	4½ x 11	13	24½	2 OD	3½	
21481	2	2½	7 x 9	20	24	2½ OD	1⅞	1⅞
21482	2	2½	7 x 9	21	39	2½ OD	2⅞	1⅞
21485	2	2½	5½ x 11	16	29	2½ OD	3½	3½
21489	3	2¼	4¼ x 9¾	20	26½	2¼ OD		2⅞
21494	2	2	5½ x 11	20	23	2 OD	3½	3½
21498	2	2½	5½ x 11	13	20	2½ OD	3½	
21500	11	2 WP	7 x 9	12	26¾	2 AS		
21501	11	2 WP	7 x 9	12	27	2 AS		
21502	2	1⅞	7 x 9	14	28⅞	2 OD	2⅞	1⅞
21503	2	1⅞	7 x 9	14	28⅞	2 OD	2⅞	1⅞
21504	5	2	7 x 9	22	26	2¾ OD	1⅞	1⅞
21505	11	2	5½ x 11	13	24½	2 OD	3½	
21507	2	3	7 x 9	20	26	3 OD	2⅞	2⅞
21512	2	1¾	6	22	30	1¾ OD	1½	1½
21521	2	2½	7 x 9	30	34	2½	1⅞	1⅞
21522	2	3	5½ x 11	20	27	3 OD	3½	3½
21523	2	2¾	7 x 9	22	26	2¾ OD		
21525	11	2	5½ x 11	15	21¼	2¼ OD	3½	
21528	2	1¾	7 x 9	18	31	2	1¾	1¾
21533	5	2½	7 x 9	24	28	3	1⅞	1⅞

▲ Arc Welded.
 † Double-Wall.
 ◆ Spark Arrestor.
 □ Welded Heat Shield.
 ✦ Resonator.

Special Style, not shown.
 @ Stainless.
 † Threaded.
 § Tractor.

AS Aluminized Spout.
 CT Chrome Tip
 SB Spherical Ball.
 SF Spherical Flare Loose Flange.
 SP Spout.

ST Stainless Tip
 WF Welded Flange.
 WP Welded Pipe.
 WS Welded Spout.

INFORMATION & BUILD TO ORDER

TOOLS AND ACCESSORIES

SCHOOL BUS

MEDIUM DUTY TRUCK GVV 3-6

HEAVY DUTY TRUCK GVV 7-8

APPLICATION BY ENGINE

NOISE AND BACKPRESSURE DATA

TRACTOR

MUFFLER SPECS

O.E. CROSS INDEX

TABLE 1 - MUFFLER SPECIFICATIONS BY PART NUMBER

Part No.	Style	Inlet ID (A)	Shell Dia. (B)	Shell Length (C)	Overall Length (D)	Outlet ID (E)	Inlet Offset (F)	Outlet Offset (G)
21535	11	2	3¼ x 7¾	15	19	2	2½	
21539	16	2½	7 x 9	28	32	2½	1¾	1¾
21540	2	2½	6	29	34½	1¾ OD	1½	1½
21541	16	2½	7 x 9	28	32	2½	1¾	1¾
21542	1	3	7 x 9	26	31	3		
21543	2	2½	7 x 9	30	36	2½	1¾	1¾
21544	3	2½	5½ x 11	27	32	2¼	3½	
21545	2	3	7 x 9	18	24	3	1¾	1¾
21546	10	2¼	5½ x 11	19	31¼	2	5	
21547	3	2½	7 x 9	24	30	2½		1¾
21548	2	2½	4¼ x 8 ¹³ / ₁₆	16	20	2½	2 ⁵ / ₈	2 ⁵ / ₈
21550	2	2½	4¼ x 9¾	19	23	2 OD	2 ⁷ / ₈	2 ⁷ / ₈
21551	16	3	7 x 9	24	34	2 ⁵ / ₈	2 ⁵ / ₈	1¾
21553	16	2 ⁵ / ₈	7 x 9	24	28	2 ⁵ / ₈	2 ⁵ / ₈	1¾
21573	#	1½ WF	SPECIAL	28	28	1½ WF		
21578♦	7	2	6	5 ¹ / ₈	11	2		
21579♦	7	2½	8 ³ / ₈	6 ³ / ₈	12 ⁷ / ₈	2½		
21580♦	7	3	6 ⁵ / ₈	10¼	14 ⁷ / ₈	3 ¹ / ₈ OD		
21581♦	7	3½	7	12	17 ⁵ / ₈	3½		
21582♦	7	4	8 ³ / ₈	14 ⁵ / ₈	21¼	4		
21584▲	7	5	9	12	20½	5 OD		
21585♦	15	1½ OD	4¼	18½	21	1¾ OD		
21598	2	2	3¼ x 7¾	11	15½	2¼	2½	2½
21610	3	2½	5	21	34 ⁵ / ₁₆	2½ AS		1¼
21620	2	2½	6	20	27	1 ¹³ / ₁₆ OD	1½	1½
21669	2	2½	4¼ x 9¾	21	25½	2½	2 ⁷ / ₈	2 ⁷ / ₈
21687	1	2¼	4	16	21	2¼		
21723	1	2½	6	30	37	2½		
21728	1	1 ²¹ / ₃₂	3	14 ⁵ / ₈	17½	1½		
21751	8	3½	7	15	22 ¹ / ₈	4 OD		
21768	11	2¼	4¼ x 9¾	21	25½	2	2 ⁷ / ₈	
21782	11	2	4¼ x 9¾	21	25½	2	2 ⁷ / ₈	
21784	2	2½	4¼ x 9¾	21	25¼	2 OD	2 ⁷ / ₈	2 ⁷ / ₈
21807	2	2¼	4¼ x 9¾	22	28	2	2 ⁷ / ₈	2 ⁷ / ₈
21832▲	2	3½	8¼ x 11½	26	32¼	4	2½	2½
21833▲	2	4	10 ¹ / ₈	27¾	33½	4	2½	2½
21835▲	7	5	9	11½	20	5		
21837▲	4	4	10 ¹ / ₈	28	31	4	2½	2½
21838▲	1	4	8 ³ / ₈	33½	40	4		
21848	11	2¼	4¼ x 9¾	21	25¼	2¼	2 ⁷ / ₈	
21849	2	1 ⁷ / ₈	6	10	14½	1¾	1½	1½
21856	11	2½	4¼ x 9¾	19	23	2½	2 ⁷ / ₈	
21860	11	2½	4¼ x 9¾	25	29¼	2¼	2 ⁷ / ₈	
21874	2	2	6	18	28	2 OD	1½	1½
21883	11	2½	4¼ x 9¾	21	25½	2	2 ⁷ / ₈	
21885	11	2	4¼ x 8 ¹³ / ₁₆	16	20¾	2	2 ⁵ / ₈	
21894	2	2¼	6	26	31	2¼	1½	1½
21896	11	1 ⁷ / ₈	4¼ x 9¾	17	20	1¾	2 ⁷ / ₈	
21899	1	1½	3½	10¼	23½	1 ³ / ₈ OD		
21903	3	2½	4¼ x 8 ¹³ / ₁₆	21	26	2¼		2 ⁵ / ₈
21907	21	2¼	4¼ x 9¾	22	28½	2	2 ⁷ / ₈	2 ⁷ / ₈
21909	2	2½	4¼ x 9¾	21	35½	2¼	2 ⁷ / ₈	2 ⁷ / ₈
21910	2	2½	4¼ x 9¾	21	26½	2¼ OD	2 ⁷ / ₈	2 ⁷ / ₈
21923▲	4	4	10 x 15	26	29¼	4	3¾	3¾
21925	2	2¾	7	27	33¼	2½	1¾	1¾
21934	11	1 ⁷ / ₈	4¼ x 8 ¹³ / ₁₆	17	22	1 ⁷ / ₈	2 ⁵ / ₈	
21949	2	1 ⁷ / ₈	6	22	26½	2 OD	1½	1½
21962	2	1 ²¹ / ₃₂	6	19	24	1 ²¹ / ₃₂	1½	1½
21968▲	9	4	10 ¹ / ₈	27¾	31	4	2½	3½
21969▲	9	4	10 ¹ / ₈	28	31	4	2½	20½
21970	9	4	10 ¹ / ₈	36	39	4	2½	30½
21971▲	10	4	10 x 15	16	19½	3 ¹³ / ₁₆ OD	3	4¾
21976	1	2¼	5	16	24½	2½ AS		
21979	2	2¼	4¼ x 9¾	21	28½	2		
21988	2	2¼	4¼ x 9¾	21	29¾	2 OD	2 ⁷ / ₈	2 ⁷ / ₈
21992	1	2¼	4	15	28½	2¼ AS		
21995	1	WF	SPECIAL	37	38	WF		

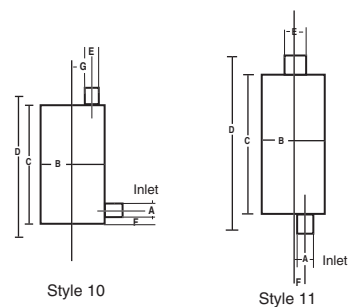
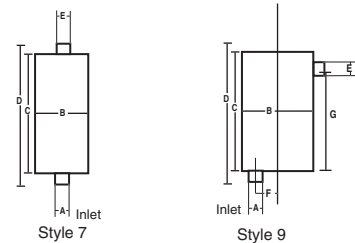
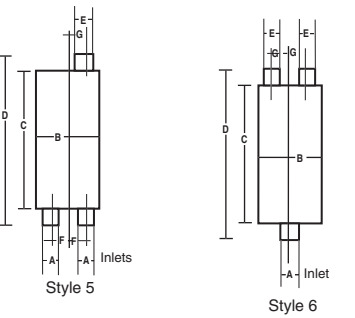
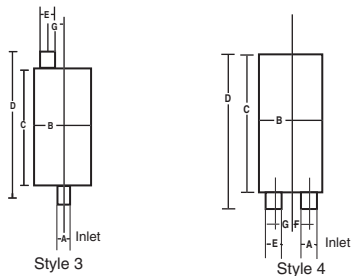
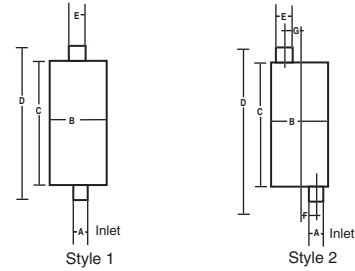

▲ Arc Welded.
 † Double-Wall.
 ♦ Spark Arrestor.
 □ Welded Heat Shield.
 ◆ Resonator.

Special Style, not shown.
 © Stainless.
 ‡ Threaded.
 § Tractor.

AS Aluminized Spout.
 CT Chrome Tip
 SB Spherical Ball.
 SF Spherical Flare Loose Flange.
 SP Spout.

ST Stainless Tip
 WF Welded Flange.
 WP Welded Pipe.
 WS Welded Spout.

TABLE 1 - MUFFLER SPECIFICATIONS BY PART NUMBER

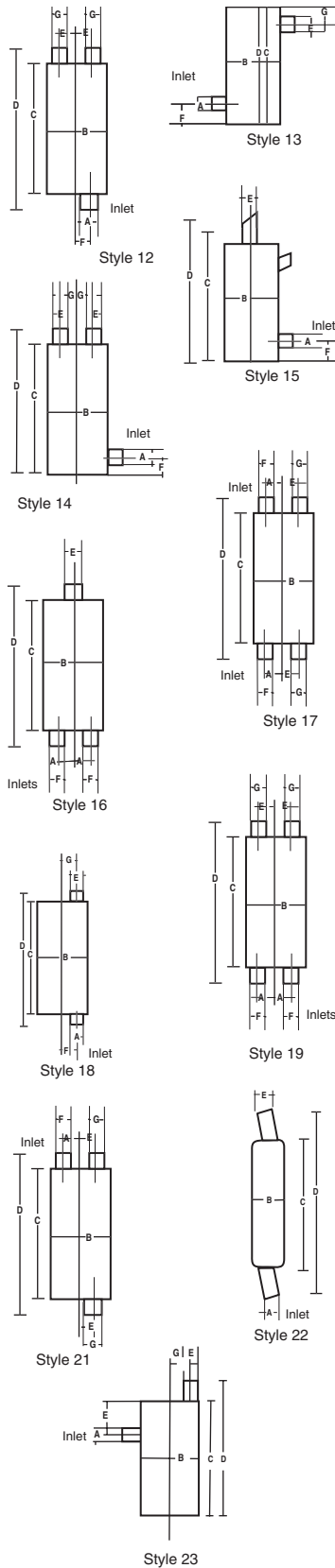

Part No.	Style	Inlet ID (A)	Shell Dia. (B)	Shell Length (C)	Overall Length (D)	Outlet ID (E)	Inlet Offset (F)	Outlet Offset (G)
21999	11	2½	4¼ x 9¾	25	30½	2¼	2⅞	
22000	2	2½	7	27	32½	2¼	1¾	1¾
22003▲	2	2½	8⅞	26½	32½	2½	2	2
22004▲	2	4	8¼ x 11½	27	33¼	4	2½	2½
22006▲	9	4	8¼ x 11½	28	31	4	2½	12
22018§	1	WF	3¼	13½	20½	1½		
22020§	13	1⅞	5	12½	12½	1⅞ OD	1½	1⅞
22021§	10	3⅞	5⅞	19½	22½	2¾ OD	3¼	
22022§	15	1⅞	3¼	11	16⅞	SP	1	
22023§	1	1⅞	4¼	12⅝	18	1½		
22024§	9	1⅞	3¼	17⅞	18½	1⅞ OD		1⅞
22027§	1	2⅞	6⅞	21	27⅞	2⅞ OD		
22028§	1	SPECIAL	3¼	17	32½	1½ OD		
22031	1	2⅞ SF	6⅞	21	26⅞	2½ OD		
22032§	10	2½	4¼	14¾	19½	2½ OD	3⅞	
22033§	1	2⅞	5⅞	21¼	32½	3 OD		
22035§	1	1⅞	3¼	15	18	1⅞ OD		
22037§	1	2¾	4⅞	16½	26	2½ OD		
22038§	1	2¼	4¼	13	17	2¼ OD		
22039§	11	2⅓ ₃₂	6⅞	5½	10⅞	1⅓ ₃₂ OD	1½	1⅞
22040§	11	SF	4⅞ x 8⅞	19	32	1⅓ ₁₆ OD	2¼	½
22041§	1	SF	4⅞ x 8⅞	33	38	3½ OD		
22042§	1	1¾ OD	3¼	15½	31½	1¾ OD		
22043§	1	1¾ OD	3¼	16¾	31¼	1¾ OD		
22046§	1	1⅞	3¼	15	17½	1½		
22047§	1	2	3¼	15	17¼	1¾		
22052	11	2	4¼ x 9¾	19	23¾	2	2⅞	
22065	2	2	6	13	19	2 OD	1½	1½
22070	11	2¼	4¼ x 9¾	19	23¾	2	2⅞	
22071	11	1⅞	4¼ x 9¾	17	20	2	2⅞	
22089	2	2½	6	23	28	2¼	1½	1½
22100	11	2½	4¼ x 9¾	28	36½	2½	2⅞	
22101	2	2¾	7	36	41½	2½	1¾	1¾
22102	2	2½	7	32	37¾	2¼	1¾	1¾
22103	2	2½	6	34	39½	2½	1½	1½
22105	2	2	4¼ x 9¾	19	24½	2	2⅞	2⅞
22109§	1	2⅞	4¼	15¼	21	1⅞ OD		
22110§	1	1⅞	4¼	17⅞	22½	1⅞		
22116	2	1¾	6	19	23	1¾	1½	1½
22129	11	2	4¼ x 9¾	18	22	2¼	2⅞	
22138	2	2½	6	22	26¼	2½	1½	1½
22140	1	2¼	5	18	33½	2¾ AS		
22143	21	2¼	4¼ x 9¾	19	24	2	2⅞	2⅞
22146	3	2¼	4¼ x 9¾	19	23	2¼		2⅞
22149□	11	2	4¼ x 8 ¹³ / ₁₆	12	18	1¾	2⅞	
22151	2	2½	7	30	34½	2½	1¾	1¾
22153	11	2½	4¼ x 9¾	21	25½	2¼	2⅞	
22154	11	2½	4¼ x 9¾	25	29	2½	2⅞	
22155	2	2¼	6	27	31	2	1½	1½
22157	2	2	4¼ x 9¾	19	23	2	2⅞	2⅞
22158	1	2	3½	18	28½	2 AS		
22160	2	2½	4¼ x 9¾	15	28½	2¼ AS	2⅞	2⅞
22161	2	2½	4¼ x 9¾	15	28½	2¼ AS	2⅞	2⅞
22171	6	2½	4¼ x 9¾	21	25½	2		2⅞
22172	6	2½	4¼ x 9¾	21	25½	2 OD		2⅞
22173	2	2¼	7	25	29¼	2¼	1¾	1¾
22177	2	2¼	7	27	31¼	2¼	1¾	1¾
22180	1	2¼	5	18	38½	2¼ AS		
22184	11	2	4¼ x 9¾	18	30	1¾ AS	2⅞	
22200	2	1¾	7	11	14	1½	2¼	2¼
22212	2	1⅞	6	15	18	1½	1½	1½
22214▲	9	3½	8¼ x 11½	26	30	4	2½	14¾
22218	2	1 ²¹ / ₃₂	5	19	27	1½	1¼	1¼
22220	11	1¾	4¼ x 8 ¹³ / ₁₆	16	20	1¾	2⅞	
22221	3	1⅞	3¼ x 7¾	16	19	1½		2½
22229	2	1½	6	10	13	1½	1½	1½
22231▲	5	2¾	8¼ x 11½	27¾	32¾	4	4 ⁵ / ₃₂	1¾

▲ Arc Welded.
 † Double-Wall.
 ◆ Spark Arrestor.
 □ Welded Heat Shield.
 ◇ Resonator.

Special Style, not shown.
 @ Stainless.
 † Threaded.
 § Tractor.

AS Aluminized Spout.
 CT Chrome Tip
 SB Spherical Ball.
 SF Spherical Flare Loose Flange.
 SP Spout.

ST Stainless Tip
 WF Welded Flange.
 WP Welded Pipe.
 WS Welded Spout.

INFORMATION & BUILD TO ORDER

TOOLS AND ACCESSORIES

SCHOOL BUS

MEDIUM DUTY TRUCK GVV 3-6

HEAVY DUTY TRUCK GVV 7-8

APPLICATION BY ENGINE

NOISE AND BACKPRESSURE DATA

TRACTOR

MUFFLER SPECS

O.E. CROSS INDEX

TABLE 1 - MUFFLER SPECIFICATIONS BY PART NUMBER

Part No.	Style	Inlet ID (A)	Shell Dia. (B)	Shell Length (C)	Overall Length (D)	Outlet ID (E)	Inlet Offset (F)	Outlet Offset (G)
22234	1	2	5	10	13	2		
22235	1	2½	6	26½	34	2½		
22236	2	3	8½	29½	36½	3	2½	2½
22239	2	1¾	4¼ x 9¾	17	20½	1⅞ OD	2⅞	2⅞
22241	11	2¼	4¼ x 9¾	21	32	2 OD	2⅞	
22242	2	2	4¼ x 8 ¹³ / ₁₆	20	24	2	2⅞	2⅞
22243	2	1¾	6	15	18	1¾	1½	1½
22245	2	2¼	6	20	24¾	2	1½	1½
22248	4	1¾	6	13	16½	1¾	1½	1½
22249	2	2½	4¼ x 9¾	21	29	2¼ OD	2⅞	2⅞
22252	2	1¾	7	12	15½	1¾	2¼	2¼
22253	21	2¼	4¼ x 9¾	19	24	2	2⅞	2⅞
22266	3	1½	3¼ x 7¾	15	18	1½		2½
22280	2	1⅞	5	19	26½	1⅞ AS	1¼	1¼
22281	1	1⅞	4	18	21	1⅞		
22282□	2	2	4¼ x 9¾	15	18	2	2⅞	2⅞
22283□	2	2	4¼ x 9¾	19	23	2	2⅞	2⅞
22285	2	2 WF	6	15	20¾	1¾	1½	1½
22286	2	2	7	18	21	2	1¾	1¾
22288	3	2½	4¼ x 8 ¹³ / ₁₆	13	17½	2⅞		2⅞
22297	3	2¼	4¼ x 9¾	19	23	2½		2⅞
22298□	2	2¼	4¼ x 9¾	16	19½	2	2⅞	2⅞
22299	4	2	4¼ x 9¾	22	24	2	2⅞	2⅞
22301	2	1⅞	5	21	27½	1⅞ OD	1¼	1¼
22302	1	1⅞	4	18	23	1⅞		
22305□	2	1½	6	11	14	1½	1½	1½
22308	2	1¾	7	16	26½	1⅞ OD	1½	1½
22311	2	1½	3¼ x 7¾	12	20	1⅞	2½	2½
22313	11	2¼	4¼ x 9¾	19	26¼	2	2⅞	
22314	12	2¼	7	18	29¼	2¼ AS	2¼	2¼
22315	2	2½	7	32	37¾	2¼	1¾	1¾
22316	2	2¼	4¼ x 9¾	19	23	2	2⅞	2⅞
22317	2	2¼	4¼ x 9¾	19	23	2¼	2⅞	2⅞
22318	2	2	4¼ x 9¾	19	23	2	2⅞	2⅞
22321	2	1⅞	6	16	19½	2	1½	1½
22323	2	2	6	16	19½	2	1½	1½
22324	6	2¼	4¼ x 9¾	14	20¾	2¼ AS		2⅞
22325	11	2	4¼ x 9¾	17	20½	2	2⅞	
22326	12	2	4¼ x 9¾	17	20¼	2	2⅞	2⅞
22327	3	1⅞	3¼ x 7¾	16	19¼	1½		2½
22328□	3	2	7 x 9	13	22½	1⅞ AS		2⅞
22329	2	2½	4¼ x 9¾	21	25½	2¼ OD	2⅞	2⅞
22331	2	1¾	6	19	30	2 AS	1½	1½
22332	4	1⅞	4¼ x 9¾	13	15	1¾		2⅞
22334	3	1¾ WF	4¼ x 8 ¹³ / ₁₆	13	17⅞	1½		2⅞
22335	12	2¼	7	17	28½	2¼ AS	2¼	2¼
22336	2	2	6	19	32¾	2 AS	1½	1½
22337▲	9	5	10 x 15	35½	35½	5	3¼	7½
22338	2	2¼	6	25	33½	2¼	1½	1½
22339	3	2	4¼ x 8 ¹³ / ₁₆	13	17½	2⅞		2⅞
22340	1	1 ²¹ / ₃₂	3½	15	34	1 ²¹ / ₃₂		
22341	1	1⅞	4¼ x 8 ¹³ / ₁₆	17	19¼	1⅞		
22342	2	2	7	16	23½	1⅞ AS	2¼	2¼
22343	11	1⅞	4¼ x 9¾	18	22¼	2¼	2⅞	
22346	2	2	5	18	21	2	1¼	1¼
22347	2	1½	4¼ x 8 ¹³ / ₁₆	13	16	1½	2⅞	2⅞
22348□	2	2¼	4¼ x 8 ¹³ / ₁₆	13	16	2¼	2⅞	2⅞
22349□	2	2¼	4¼ x 9¾	17	20½	2¼	2⅞	2⅞
22352	2	2	4¼ x 9¾	19	22	2	2⅞	2⅞
22353□	3	1¾	4¼ x 9¾	14	16½	1¾		2⅞
22354	21	2½	4¼ x 9¾	19	24	2¼	2⅞	2⅞
22355▲	1	2¾	6	24	37	2¾		
22356▲	1	2½	6	30	38	2½		
22358	2	2	7	25	28	1¾	2¼	2¼
22359	11	2	4¼ x 9¾	19	24½	2	2⅞	
22360	2	2	4¼ x 8 ¹³ / ₁₆	14	17¼	2	2⅞	2⅞
22361	2	2	6	25	29	2	1½	1½

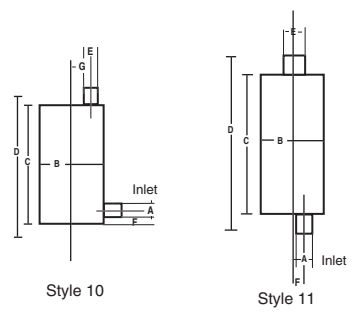
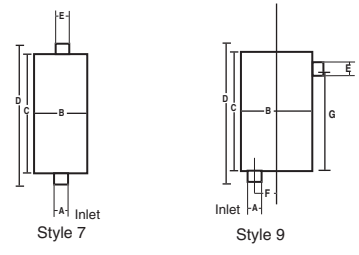
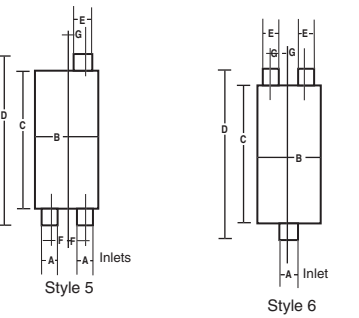
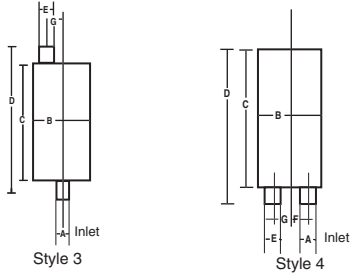
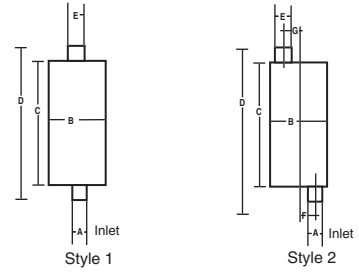

- ▲ Arc Welded.
- † Double-Wall.
- ◆ Spark Arrestor.
- Welded Heat Shield.
- ⋄ Resonator.
- # Special Style, not shown.
- © Stainless.
- ‡ Threaded.
- § Tractor.
- AS Aluminized Spout.
- CT Chrome Tip
- SB Spherical Ball.
- SF Spherical Flare Loose Flange.
- SP Spout.
- ST Stainless Tip
- WF Welded Flange.
- WP Welded Pipe.
- WS Welded Spout.

TABLE 1 - MUFFLER SPECIFICATIONS BY PART NUMBER

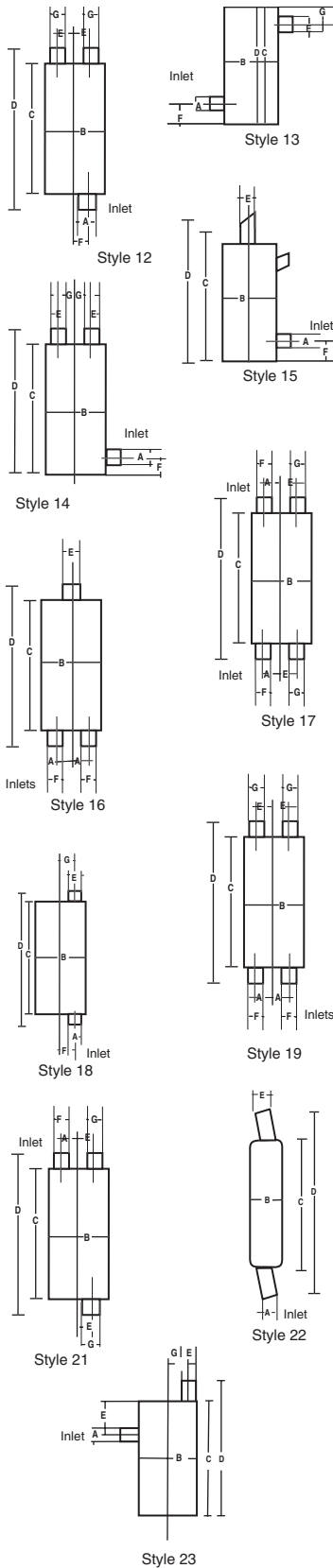

Part No.	Style	Inlet ID (A)	Shell Dia. (B)	Shell Length (C)	Overall Length (D)	Outlet ID (E)	Inlet Offset (F)	Outlet Offset (G)
22362	11	2	4 1/4 x 9 3/4	21	32 1/4	2 AS	2 7/8	
22363	11	2 1/4	4 1/4 x 9 3/4	18	30 3/4	2 AS	2 7/8	
22364	12	2 1/4	4 1/4 x 9 3/4	18	30 3/4	2 AS	2 7/8	2 7/8
22369	2	1 7/8	4 x 8	11	17 1/2	1 7/8 SF	2 1/2	2 1/2
22370	2	1 7/8	4 x 8	11	17 1/2	1 7/8 SF	2 1/2	2 1/2
22371	1	1 7/8	5	16 3/4	29 1/2	1 7/8 OD		
22372	1	1 7/8	5	16 3/4	29 1/2	1 7/8 OD		
22379	2	1 3/4	4 1/4 x 8 13/16	15	23	1 3/4 AS	2 5/8	2 5/8
22380	2	2 1/4	4 1/4 x 9 3/4	21	25	2 1/4	2 7/8	2 7/8
22381▲	4	5	10 x 15	25	29	5	3	3
22382▲	2	2 1/4	6	24	30	2 1/4	1 3/8	1 3/8
22384	2	2	7	20	24	2	1 3/4	1 3/4
22385□	11	2	3 1/4 x 7 3/4	9	12	2	2 1/2	
22386□	2	2	4 1/4 x 9 3/4	16	19 1/2	2	2 7/8	2 7/8
22387	6	1 3/4	4 1/4 x 8 13/16	16	19 1/2	1 1/2		2 5/8
22389	1	3	7	30	38	3		
22390§	3	2 1/2	4 5/8 x 8 5/8	19	33 1/2	1 27/32 OD	2 3/4	2 3/4
22391▲	9	3 1/2	8 1/4 x 11 1/2	28	31	4 OD	2 1/2	12
22392	2	WF	5	24	25 3/4	WF	1 1/2	1 1/2
22393	2	2 1/2	4 1/4 x 9 3/4	19	23	2 1/2	2 7/8	2 7/8
22394	2	2 1/4	4 1/4 x 9 3/4	19	23	2 1/4	2 7/8	2 7/8
22395	17	2 1/4	4 1/4 x 9 3/4	16	20 1/2	2 1/4	2 7/8	2 7/8
22396	12	2 1/4	4 1/4 x 9 3/4	14	29 1/4	2 1/2 AS	2 7/8	2 7/8
22397	12	2 1/4	4 1/4 x 9 3/4	14	29 1/4	2 1/2 AS	2 7/8	2 7/8
22398	12	2 1/2	7	25	29	2	1 3/4	1 3/4
22399	12	2 1/4	7	25	29	2	1 3/4	1 3/4
22400	2	1 7/8	6	18	26	2 AS	1 1/2	1 1/2
22401	12	2 1/4	4 1/4 x 9 3/4	19	23	2	2 7/8	2 7/8
22402	6	2 1/4	7	25	29	2		1 3/4
22404	11	1 3/4	5 1/2 x 11	18	21	2	3 3/4	
22405	1	SPECIAL	3 1/4 x 7 3/4	17	22	2		
22406	11	1 3/4	5 1/2 x 11	16	21 1/2	2 AS	3 3/4	
22407	6	1 3/4	5 1/2 x 11	16	20 1/2	1 3/4 AS		3 3/4
22408	6	2	5 1/2 x 11	16	22 1/2	1 3/8 AS		3 3/4
22409	11	2	5 1/2 x 11	16	24	1 3/4 AS	3 3/4	
22410	11	1 3/4	4 1/4 x 8 13/16	13	17	1 1/2 AS	2 5/8	
22411	11	1 3/4	4 1/4 x 8 13/16	13	25	1 1/2 AS	2 5/8	
22415□	1	1 7/8 WF	3 1/2	12	18 1/2	1 1/2		
22416	11	1 5/8	4 1/4 x 8 13/16	19	29	1 3/4 AS	2 5/8	
22417	11	2	4 1/4 x 9 3/4	18	33 1/2	2 AS	2 7/8	
22418	12	2	4 1/4 x 9 3/4	18	33 1/2	2 AS	2 7/8	2 7/8
22419	2	1 3/4	4 1/4 x 9 3/4	14	22 1/4	1 3/4 AS	2 5/8	2 5/8
22420	11	1 3/4	4 1/4 x 8 13/16	16	24	1 3/4 AS	2 5/8	
22421	12	1 3/4	4 1/4 x 8 13/16	14	26	1 1/2 AS		2 5/8
22422	3	1 3/4	3 1/4 x 7 3/4	19	27	1 3/4 AS		2 1/2
22423	2	1 3/4	4 1/4 x 8 13/16	15	22 1/2	1 3/4 OD	2 5/8	2 5/8
22424	11	1 3/4	3 1/4 x 7 3/4	17	30	1 5/8 OD	2 1/2	
22425	12	2	4 1/4 x 9 3/4	18	26	1 1/2 AS	2 7/8	2 7/8
22426	6	2	5 1/2 x 11	16	27 1/2	1 1/4 AS		3 3/4
22427	11	2 1/2	4 1/4 x 8 13/16	19	23	2 3/8 OD	2 7/8	
22428	11	1 3/4 WF	3 1/4 x 7 3/4	13	27	1 1/2 AS	2 1/2	
22429	3	1 3/4	4 1/4 x 8 13/16	19	23	1 3/4		2 5/8
22430	11	2	4 1/4 x 8 13/16	16	21	2 OD	2 5/8	
22431	11	2 1/4	4 1/4 x 8 13/16	16	21	2 1/4 OD	2 5/8	
22432	3	1 7/8	4 1/4 x 8 13/16	19	23	1 15/16 OD		2 5/8
22433□	2	1 1/2	4 1/4 x 9 3/4	17	20	1 1/2	2 7/8	2 7/8
22434□	2	2 1/8 WF	4 1/4 x 8 13/16	18	21 1/4	1 3/4	2 5/8	2 5/8
22435	3	2	4 1/4 x 9 3/4	13	16 1/4	2 1/4		2 7/8
22436	2	2	5	21	24	2	1 1/4	1 1/4
22437	#	2 1/4	6	26 1/2	32 1/2	2 1/4	1 1/2	1 1/2
22438§	1	1 7/8	4 5/8	17 1/2	22 1/2	1 7/8		
22439	2	3 1/2 SF	4 5/8 x 8 5/8	19	26 7/8	2 1/8 OD	1 3/8	2 1/2
22440□	2	2 1/4	4 1/4 x 8 13/16	15	18	2 1/4	2 5/8	2 5/8
22441	11	1 3/4	5 1/2 x 11	13	15 1/2	1 5/8	3 3/4	
22443	2	2	5	18	21	2	1 1/4	1 1/4
22444§	1	1 7/8	5 5/8	17	28 3/4	2 OD		
22445	2	2	5	18	21	2	1 1/4	1 1/4

▲ Arc Welded.
 † Double-Wall.
 ◆ Spark Arrestor.
 □ Welded Heat Shield.
 ✦ Resonator.

Special Style, not shown.
 @ Stainless.
 † Threaded.
 § Tractor.

AS Aluminized Spout.
 CT Chrome Tip
 SB Spherical Ball.
 SF Spherical Flare Loose Flange.
 SP Spout.

ST Stainless Tip
 WF Welded Flange.
 WP Welded Pipe.
 WS Welded Spout.

INFORMATION & BUILD TO ORDER

TOOLS AND ACCESSORIES

SCHOOL BUS

MEDIUM DUTY TRUCK GVV 3-6

HEAVY DUTY TRUCK GVV 7-8

APPLICATION BY ENGINE

NOISE AND BACKPRESSURE DATA

TRACTOR

MUFFLER SPECS

O.E. CROSS INDEX

TABLE 1 - MUFFLER SPECIFICATIONS BY PART NUMBER

Part No.	Style	Inlet ID (A)	Shell Dia. (B)	Shell Length (C)	Overall Length (D)	Outlet ID (E)	Inlet Offset (F)	Outlet Offset (G)
22446	11	1 3/4	4 1/4 x 8 13/16	13	14 1/2	1 1/2	2 5/8	
22447	12	2 1/4	4 1/4 x 9 3/4	17	28 1/2	2 AS	2 7/8	2 7/8
22448	2	1 3/4	4 1/4 x 8 13/16	13	16	1 3/4 OD	2 5/8	2 5/8
22449▲	2	4	8 1/4 x 11 1/2	32	37 1/4	4	2 1/2	2 1/2
22450	2	2	5	21	24	2	1 1/4	1 1/4
22451	11	1 7/8	4 1/4 x 9 3/4	14	16 1/2	1 7/8	2 7/8	
22452▲	13	5	10 x 15	26	26	5	4	4
22453	2	1 3/4	5	18	23	1 3/4 OD	1 1/4	1 1/4
22454	2	1 3/4 WF	6	18	33 1/2	2 1/2 CT	1 1/2	1 1/2
22455	2	1 3/4 WF	6	18	33 1/2	2 1/2 CT	1 1/2	1 1/2
22456	12	2	7	13	17 1/2	1 1/2 AS	2 1/4	2 1/4
22457	2	2 1/2	4 1/4 x 9 3/4	21	24	2 1/4	2 7/8	2 7/8
22458□	2	2 1/4	4 1/4 x 9 3/4	16	19 1/2	2	2 7/8	2 7/8
22459	2	2 1/2	7	32	36	2 1/4	1 3/4	1 3/4
22460	2	2 1/4	7	25	29 1/4	2 1/4	1 3/4	1 3/4
22461	11	2	5 1/2 x 11	16	27	2 OD	3	
22462	12	2 1/4	4 1/4 x 9 3/4	17	26	1 3/4 AS	2 7/8	2 7/8
22463□	2	2	4 1/4 x 9 3/4	15	18 1/2	1 3/4	2 7/8	2 7/8
22464□	2	2	4 1/4 x 9 3/4	17	20 1/2	1 7/8	2 7/8	2 7/8
22465	2	2 1/4	6	25	29 1/4	2	1 1/2	1 1/2
22466	2	2 1/4	7	25	29 1/4	2 1/4	1 3/4	1 3/4
22467@	2	2 3/8	7 9/16	22	26	2 1/4	1 3/4	1 3/4
22471	11	1 1/2	4 1/4 x 8 13/16	15	28	1 3/4 AS	2 5/8	
22472	11	1 3/4	5 1/2 x 11	18	21	2	3 3/4	
22473	12	1 3/4	5 1/2 x 11	15	24	1 7/8 AS	3 3/4	3 3/4
22474	12	1 3/4	5 1/2 x 11	18	24	1 3/4	3 3/4	3 3/4
22476	11	2	5 1/2 x 11	18	21	2	3 3/4	
22477	2	1 1/2	6	13	16 1/2	1 1/2	1 1/2	1 1/2
22478	2	1 7/8	4 1/4 x 8 13/16	16	19 1/2	1 7/8	2 5/8	2 5/8
22479	12	2	4 1/4 x 9 3/4	17	27	2 AS	2 7/8	2 7/8
22480	12	2 1/4	4 1/4 x 9 3/4	19	23	2	2 7/8	2 7/8
22482	12	1 3/4	4 1/4 x 9 3/4	19	22	1 1/2	2 7/8	2 7/8
22483	2	2	7	21	24	2	1 3/4	1 3/4
22484	2	1 3/4	6	20	25 1/2	1 3/4	1 1/2	1 1/2
22485	2	WF	5	27	29 1/2	WF	1 1/4	1 1/4
22486	1	2	3 1/2	18	27 1/2	2 AS		
22487	12	1 3/4	7	16	23 3/4	1 1/2 AS	2 1/4	2 1/4
22488	11	1 3/4	4 1/4 x 9 3/4	18	21	1 3/4	2 7/8	
22489	2	1 3/4	7	16	23 1/2	1 7/8 AS	2 1/4	2 1/4
22490□	11	2 1/4	4 1/4 x 9 3/4	19	26 1/4	2	2 7/8	
22491	1	1 7/8	5	17	22	1 7/8 OD		
22492	1	2	3 1/4 x 7 3/4	9	11 1/2	2	2 1/2	2 1/2
22493	6	2	5 1/2 x 11	14	20	1 1/2 AS		3 3/4
22494	2	2	7	21	24	2	1 3/4	1 3/4
22495	12	1 3/4	7	16	24 1/2	1 1/2 (2) OD	1 1/2	1 1/2
22496	2	2	4 1/4 x 9 3/4	18	21 3/4	1 7/8	2 7/8	2 7/8
22497	2	2	4 1/4 x 9 3/4	14	17 1/2	1 7/8	2 7/8	2 7/8
22499	11	2 1/2	4 1/4 x 9 3/4	24	29	2 1/2	2 7/8	
22500	11	2 1/4	4 1/4 x 9 3/4	21	31 7/8	2 OD	2 7/8	
22501	3	2 1/4	4 1/4 x 9 3/4	17	20 1/2	2 1/4	5/8	2 7/8
22502	3	2 1/4	4 1/4 x 9 3/4	20	24	2 1/4		2 7/8
22503	3	2 1/4	4 1/4 x 9 3/4	20	33	2 1/4 AS		2 7/8
22504	3	2 1/2	4 1/4 x 9 3/4	21	27	3 3/16		2 7/8
22505	11	3	4 1/4 x 9 3/4	24	37 1/2	2 1/2	2 7/8	
22506	2	2	6	21	24	2	1 1/2	1 1/2
22507	2	2	4 1/2 x 11	20	23 1/2	2	3	3
22508	11	2 1/4	4 1/4 x 9 3/4	20	24	2 1/4	2 7/8	
22509	11	2 1/2	4 1/4 x 9 3/4	21	27	3 3/16	2 7/8	
22510	11	2	4 1/4 x 9 3/4	17	26	1 3/4 AS	2 7/8	
22511	6	2 1/2 WP	4 1/4 x 9 3/4	21	32 1/4	2 (2)		2 7/8
22512	2	2 1/2	4 1/4 x 9 3/4	21	25 1/2	2 1/4	2 7/8	2 7/8
22513	11	2 1/2	4 1/4 x 9 3/4	21	24	2 1/4	2 7/8	
22514	3	2 1/2	4 1/4 x 9 3/4	21	25	2 1/2		2 7/8
22516	3	2	7 x 9	13	21 1/4	2 AS		2 5/8
22517	2	2 1/4	4 1/4 x 9 3/4	19	22 3/4	2 1/4	2 7/8	2 7/8
22518	3	1 3/4	4 1/4 x 9 3/4	19	26 3/4	1 3/4 AS		2 7/8
22519	2	1 3/4	4 1/4 x 9 3/4	21	24	1 3/4	2 7/8	2 7/8

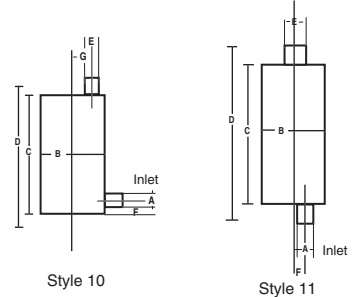
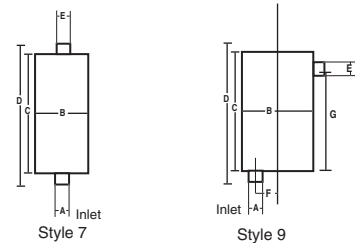
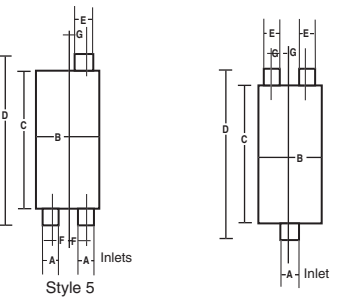
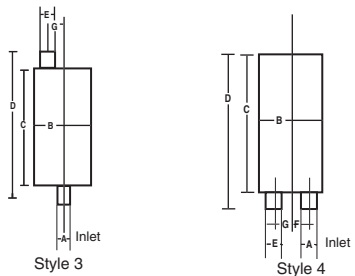
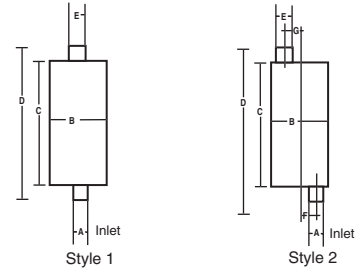

- ▲ Arc Welded.
- † Double-Wall.
- ◆ Spark Arrestor.
- Welded Heat Shield.
- ◇ Resonator.

- # Special Style, not shown.
- @ Stainless.
- ‡ Threaded.
- § Tractor.

- AS Aluminized Spout.
- CT Chrome Tip
- SB Spherical Ball.
- SF Spherical Flare Loose Flange.
- SP Spout.

- ST Stainless Tip
- WF Welded Flange.
- WP Welded Pipe.
- WS Welded Spout.

TABLE 1 - MUFFLER SPECIFICATIONS BY PART NUMBER

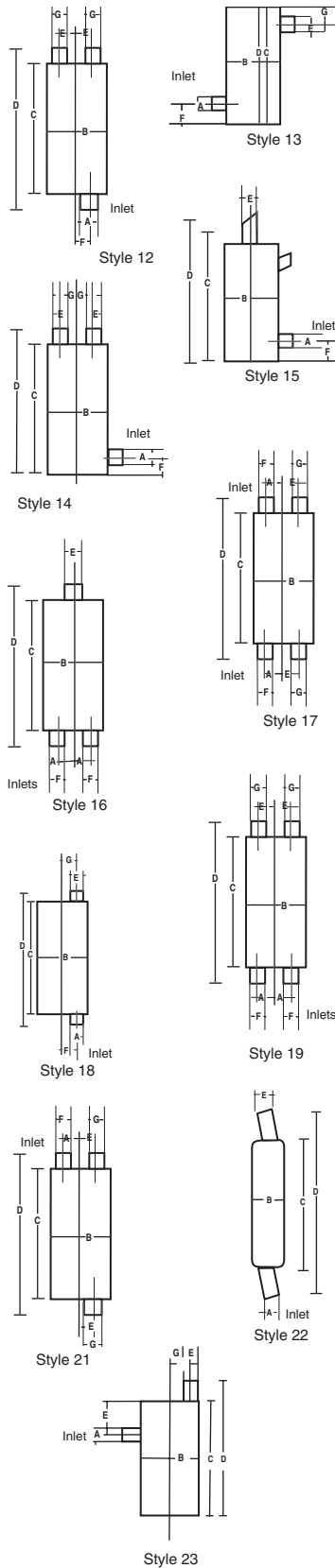

Part No.	Style	Inlet ID (A)	Shell Dia. (B)	Shell Length (C)	Overall Length (D)	Outlet ID (E)	Inlet Offset (F)	Outlet Offset (G)
22520	12	1 7/8	7 x 9	18	27 1/2	1 1/2 AS	2 5/8	2 5/8
22521	6	2	5 1/2 x 11	18	25	1 3/8 AS		3 3/4
22522	11	2	4 1/2 x 11	16	27	2 AS	3	
22523	3	2 1/4	4 1/4 x 9 3/4	20	32	2 1/4 AS		2 7/8
22524	11	1 1/2	4 1/4 x 8 13/16	12	17 1/2	1 1/2 AS	2 5/8	
22525	11	1 3/4	4 1/4 x 9 3/4	18	21	1 3/4	3	
22526	21	2	4 1/4 x 9 3/4	14	19 1/2	1 7/8	2 7/8	
22527	1	1 3/4	3 3/4 x 7 3/4	12	15	1 7/8		
22528	2	2 1/8 WF	4 1/4 x 8 13/16	18	22 3/8	2	2 5/8	2 5/8
22529	2	1 7/8	7 x 9	18	27 1/2	1 1/2 AS	2 5/8	2 5/8
22530	1	2	3 1/4 x 7 3/4	8	11	2		
22531	2	2	7	25	29	2 OD	1 3/4	1 3/4
22532	1	2 3/4	6 1/8	17	32 1/2	2 3/4 OD		
22535	12	2	4 1/4 x 9 3/4	17	26	1 7/8 AS	2 7/8	2 7/8
22536	2	3 1/2	6 1/8 x 10 1/8	18 1/4	25	4 1/8 OD	2 1/2	2 1/2
22537	2	2 1/4	4 1/4 x 9 3/4	20	24	2 1/4	2 7/8	2 7/8
22538	7	3	9	11 1/2	16	3		
22539	3	1 3/4	4 1/4 x 8 13/16	17	20	1 3/4		2 5/8
22540	12	2	5 1/2 x 11	15	26	2 AS	3	3
22541	2	3 SF	6 1/2	29 1/4	38 1/4	2 SB	1 1/4	1 1/2
22542	18	2	4 1/4 x 9 3/4	11	13	2	2 7/8	2 7/8
22543	18	2	4 1/4 x 8 13/16	12	15	2	2 5/8	2 5/8
22544	12	1 3/4	5 1/2 x 11	14	19 1/2	1 1/2 AS	3 3/4	3 3/4
22545	1	2 1/4	4	14	25	2 1/4 AS		
22546	12	1 3/4	5 1/2 x 11	13	15 1/2	1 3/8	3 3/4	3 3/4
22547	2	2 3/4 SF	7 3/8	35	45	2 3/4 ST	1 3/4	1 3/4
22548	1	1 3/4 WF	4	8	16	1 3/4 WF		
22549	2	1 1/2 WF	SPECIAL	19	32	2 1/2 CT		
22550	2	1 1/2 WF	SPECIAL	19	32	2 1/2 CT		
22551	2	3 1/2	8 1/4 x 11 1/2	30	36	4	2 3/4	2 1/2
22552	2	5	10 x 15	26	33	5	3 3/8	3 3/8
22553	12	2	7 x 9	15	23	1 1/2 AS	2 5/8	2 5/8
22554	2	2	6	18	21	2	1 1/2	1 1/2
22555	9	4	10 x 15	36	39	4	3 3/4	7 1/2
22556	10	3 3/16	8 1/4 x 11 1/2	34 1/4	36 1/2	3 3/16	4 3/4	
22557	1	2	4 1/4 x 9 3/4	21	29 1/2	2		
22558	11	2 1/2	4 1/4 x 9 3/4	16	24 1/2	2 1/4	2 7/8	
22559	2	2	4 1/4 x 9 3/4	19	24 1/2	2	2 7/8	2 7/8
22560	2	2	4 1/4 x 9 3/4	19	24 1/2	2	2 7/8	2 7/8
22561	2	2	4 1/4 x 9 3/4	12	18	2 1/8 WF	3	3
22562	2	2	7 x 9	20	29 1/2	2 1/8 AS	2 5/8	2 5/8
22563	2	2 1/2	6 1/2	28	37	2	1 1/2	1 1/2
22564	11	2 1/4	4 1/4 x 9 3/4	16	27 3/4	2 1/4	2 7/8	
22565	2	1 7/8	7 x 9	14	17	1 7/8	2 5/8	2 5/8
22566	5	SF	8 3/4	30 1/8	39	3 OD	2 3/8	2 3/8
22567	12	2 1/4	4 1/4 x 9 3/4	14 1/2	21 1/2	2 1/4 AS	2 7/8	2 7/8
22568	11	1 7/8	4 1/4 x 9 3/4	13	21 1/2	1 7/8 AS	2 7/8	
22569	11	1 3/4	7	14	17	1 1/2	1 1/2	2 1/4
22570	10	4	8 1/4 x 11 1/2	16	21 1/2	4	3 5/16	2 1/2
22571	1	4	9	28	34 1/2	4		
22572	1	4	9	20	27	4		
22574	12	2 1/2	4 1/4 x 9 3/4	28	35	2 1/4	2 7/8	2 7/8
22575	11	WP	4 1/4 x 9 3/4	28	41	2 1/2	2 7/8	
22576	3	2 1/2	4 1/4 x 9 3/4	28	33	2 1/2		2 7/8
22577	1	2 1/2 WF	8 1/2	22	28	2 1/4		
22579	2	2 1/4	4 1/4 x 9 3/4	14	17 1/2	1 7/8	2 7/8	2 7/8
22580	2	2 1/4	4 1/4 x 9 3/4	18	21 3/4	1 7/8	2 7/8	
22581	2	2 1/4	6	19	26	2	1 3/8	1 3/8
22582	2	2 1/4	6	25	31	2	1 3/8	1 3/8
22583	2	2 1/2	6 1/2	26	32	2 1/4	1 1/2	1 1/2
22584	11	2 1/2	4 1/4 x 9 3/4	16	29	2 1/4	2 7/8	
22585	2	2	6	18	21	2	1 1/2	1 1/2
22588	1	1 11/16 WF	5	14	21 1/2	1 3/4		
22589	11	2 1/2	4 1/4 x 9 3/4	16	23	2 1/2	2 7/8	
22590	11	2 1/2	4 1/4 x 9 3/4	16	20	2 1/4	2 7/8	
22591	12	1 3/4	7 x 9	16	23 3/4	1 1/2 AS	2 5/8	2 5/8
22592	11	2 1/4	4 1/4 x 9 3/4	22	26 1/2	2 1/4	2 7/8	

▲ Arc Welded.
 † Double-Wall.
 ◆ Spark Arrestor.
 □ Welded Heat Shield.
 ✦ Resonator.

Special Style, not shown.
 @ Stainless.
 ‡ Threaded.
 § Tractor.

AS Aluminized Spout.
 CT Chrome Tip
 SB Spherical Ball.
 SF Spherical Flare Loose Flange.
 SP Spout.

ST Stainless Tip
 WF Welded Flange.
 WP Welded Pipe.
 WS Welded Spout.

INFORMATION & BUILD TO ORDER

TOOLS AND ACCESSORIES

SCHOOL BUS

MEDIUM DUTY TRUCK GVV 3-6

HEAVY DUTY TRUCK GVV 7-8

APPLICATION BY ENGINE

NOISE AND BACKPRESSURE DATA

TRACTOR

MUFFLER SPECS

O.E. CROSS INDEX

TABLE 1 - MUFFLER SPECIFICATIONS BY PART NUMBER

Part No.	Style	Inlet ID (A)	Shell Dia. (B)	Shell Length (C)	Overall Length (D)	Outlet ID (E)	Inlet Offset (F)	Outlet Offset (G)
22593	11	1 3/4	5 1/2 x 11	13	15 1/2	1 3/4	3 3/4	
22594	2	2 1/2	7	24	29	2	1 3/4	1 3/4
22595	11	2 1/4	4 1/4 x 9 3/4	16	27	2 AS	3	
22596▲	9	5	9 x 14	18 1/2	22	5	3 7/8	14
22597	11	1 3/4	5 1/2 x 11	18	25	1 7/8 AS	3 3/4	
22598	11	3	4 1/4 x 9 3/4	24	30	3	2 7/8	
22599	16	2	3 1/4 x 7 3/4	15	19	2 1/4	2 1/2	2 1/2
22600	11	2	7 x 9	15	23	1 7/8 AS	2 5/8	
22601	1	1 7/8	4 1/4 x 8 13/16	16	19	1 7/8		
22602	2	2	4 1/4 x 9 3/4	16	19	1 3/4	2 7/8	2 7/8
22603▲	2	2	7	20	24 1/2	2	1 5/8	1 5/8
22604▲	9	3 1/2	8 1/4 x 11 1/2	32	39 7/8	4	2 1/2	11 7/8
22605	11	2	4 1/4 x 9 3/4	18	33 9/16	2 AS	2 7/8	
22606	12	2 1/4	4 1/4 x 9 3/4	14	25	2 1/4 AS	2 7/8	2 7/8
22607	6	2	4 1/4 x 8 13/16	16	19	1 3/4		2 5/8
22608	12	2	4 1/4 x 9 3/4	17	20 1/4	2	2 7/8	2 7/8
22609	6	2 1/4	7 x 9	15	30	2 1/4 AS		2 5/8
22610	6	2 1/4	7 x 9	15	30	2 1/4 AS		2 5/8
22611	12	2	4 1/4 x 9 3/4	17	20 1/4	2	2 7/8	2 7/8
22612	11	1 3/4	4 1/4 x 8 13/16	13	25	1 1/2 AS	2 5/8	
22613	12	1 3/4	4 1/4 x 8 13/16	9	16 3/4	2 ST	2 5/8	2 5/8
22614	19	2	4 1/4 x 9 3/4	18	32 3/4	2 ST	2 7/8	2 7/8
22615	12	1 1/2	7 x 9	12	17 1/4	1 1/2 AS	2 5/8	2 5/8
22616	3	2	7 x 9	13	21 1/8	2 AS		2 5/8
22617	3	2	7 x 9	13	21 1/8	2 AS		2 5/8
22618	2	1 7/8	4 1/4 x 9 3/4	17	20 1/4	1 3/4	3	3
22619	6	2	5 1/2 x 11	12	18 1/2	1 1/2 AS		3 3/4
22620	6	2	5 1/2 x 11	12	18	1 1/2 AS		3 3/4
22621	2	2	4 1/4 x 9 3/4	19	24 1/2	2	2 7/8	2 7/8
22622	2	2	4 1/4 x 9 3/4	19	24 1/2	2	2 7/8	2 7/8
22623	1	2 1/4	3 1/4 x 7 3/4	11	16 1/4	2 1/4		
22624	2	2 1/2	4 1/4 x 9 3/4	21	24	2 1/4	2 7/8	2 7/8
22625	2	2	6	21	24	2	1 1/2	1 1/2
22627	12	2	4 1/4 x 8 13/16	15	19 3/4	1 1/2 AS	2 5/8	2 5/8
22628▲	2	2 1/2	6 1/2	20	26	2 1/2	2 1/2	2 1/2
22630†▲	1	3	7	14	19 3/4	3		
22631†▲	1	4	9	20	26	4		
22632▲	2	3 1/2	8 1/4 x 11 1/2	26	33	3 1/2	2 1/2	2 1/2
22633	18	3	8 1/4 x 11 1/2	26	34	3	2 1/2	2 1/2
22634▲	10	4	10 1/8	28	32 1/2	4	4 1/2	2 1/2
22635▲	1	2 1/2	6	20	26	2 1/2		
22636▲	2	3	8 3/8	21	27	3	2	2
22637▲	4	3	8 3/8	22	23 1/2	3	1 7/8	1 7/8
22638	11	2 1/4	4 1/4 x 9 3/4	19	25	2 OD	2 7/8	
22639	11	1 3/4	4 1/4 x 9 3/4	20	24	2	2 7/8	
22640	11	1 3/4	4 1/4 x 8 13/16	18	21	1 3/4	1 3/4	
22641	12	2	6	17	28	2 AS	1 1/2	1 1/2
22642▲	13	4	11 1/8	36	36	4 OD	4 1/4	6 3/4
22643▲	10	4	11 1/8	36	39	4	4 1/4	2 1/2
22644	2	2 1/2	4 1/4 x 9 3/4	28	32	2 1/4 OD	2 7/8	2 7/8
22645	#	2	4 1/4 x 9 3/4	26	27 1/2	1 1/2		
22646	1	2	7 x 9	21	25	2		
22647	12	2 1/2	4 1/4 x 9 3/4	28	33 1/2	2	2 7/8	2 7/8
22648	11	2 1/2	4 1/4 x 9 3/4	28	36 1/2	2 1/2	2 7/8	
22649	12	1 7/8	4 1/4 x 9 3/4	20	23	1 1/2	2 7/8	2 7/8
22650	2	1 3/4	7 x 9	15	18	1 7/8	1 3/4	1 3/4
22651	2	2	5 1/2 x 11	14	17	2	3 3/4	3 3/4
22652	1	2	4	8	16 1/2	2		
22657	13	3 3/4	6 5/8	27 1/2	27 1/2	4 OD	3 1/2	3 1/2
22658§	10	2	5 5/8	22 1/2	26	2 1/8 OD	2	
22659	2	1 7/8	6	16	19	1 7/8	1 1/2	1 1/2
22660	2	2	6	17	20	2	1 1/2	1 1/2
22661	10	2 WF	5 1/2 x 11	20	22	2		
22662	10	5	10 x 15	16	20 1/2	5	4	1 1/2
22663	5	2 3/4	8 1/4 x 11 1/2	27	32 3/4	4	3 3/4	2 1/2
22664▲	9	4	11 1/8	36	39	4	1 1/2	7 1/2
22665▲	9	4	10 x 15	30	33	4	3 3/4	7 1/2

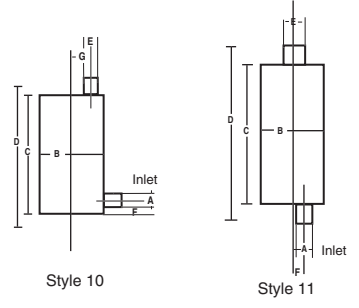
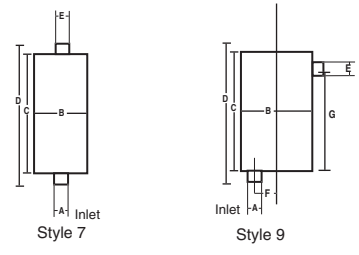
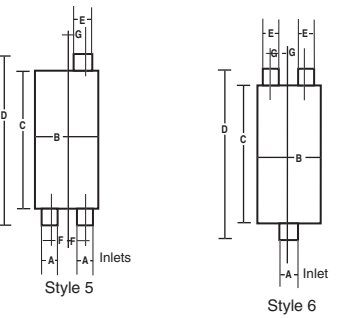
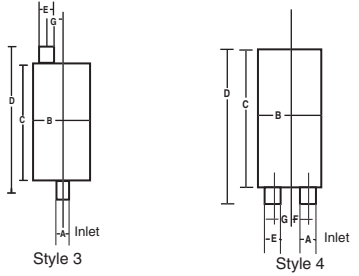
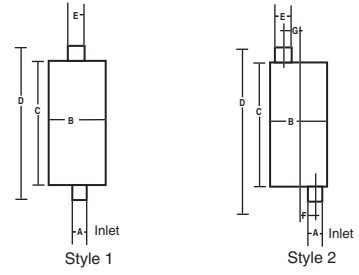

- ▲ Arc Welded.
- † Double-Wall.
- ◆ Spark Arrestor.
- Welded Heat Shield.
- ◇ Resonator.
- # Special Style, not shown.
- © Stainless.
- ‡ Threaded.
- § Tractor.
- AS Aluminized Spout.
- CT Chrome Tip
- SB Spherical Ball.
- SF Spherical Flare Loose Flange.
- SP Spout.
- ST Stainless Tip
- WF Welded Flange.
- WP Welded Pipe.
- WS Welded Spout.

TABLE 1 - MUFFLER SPECIFICATIONS BY PART NUMBER

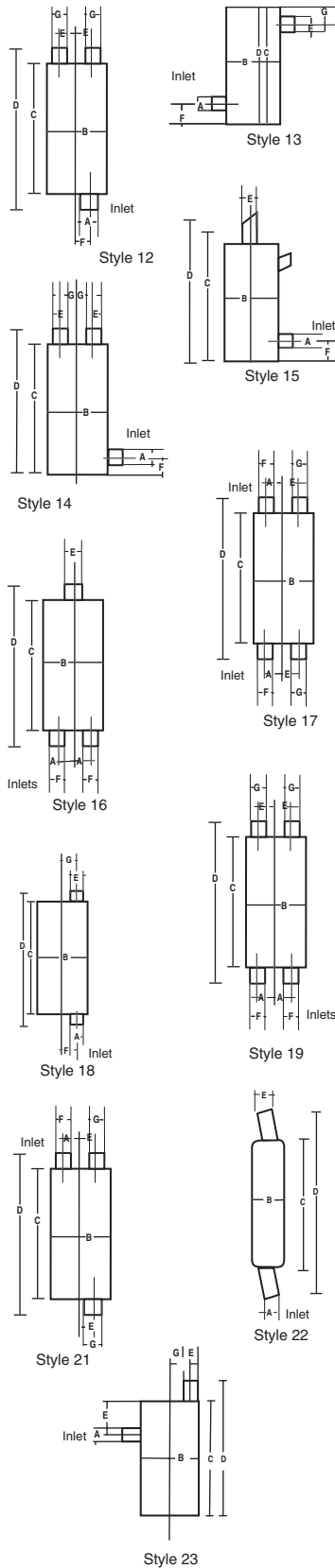

Part No.	Style	Inlet ID (A)	Shell Dia. (B)	Shell Length (C)	Overall Length (D)	Outlet ID (E)	Inlet Offset (F)	Outlet Offset (G)
22667	13	4	11 1/8	36	36	4	4 1/4	18
22668▲	9	4	11 1/8	36	39	4	2 1/2	3 7/8
22669▲	9	4	11 1/8	36	39	4	2 1/2	3 7/8
22670	2	2	7	20	25	2	1 3/4	1 3/4
22672	2	3	7 x 9	21	27	3 OD	1 3/4	1 3/4
22673	2	3	7 x 9	18	25	3 OD	1 3/4	1 3/4
22674	11	3	7 x 9	18	25 1/2	3 OD	1 3/4	1 3/4
22675	3	3	7 x 9	18	24	3 OD		1 3/4
22676	2	3	7 x 9	21	28 1/4	3 OD	2 5/8	2 5/8
22677	7	3	7 x 9	27	33	3 OD		
22678	2	3	7 x 9	24	29 1/2	2 3/4 OD	2 5/8	2 5/8
22679	3	3	7 x 9	20	26	3 OD		2 5/8
22702	3	2 3/4	7 x 9	14		WP		2 5/8
22703	12	2 1/4	4 1/4 x 9 3/4	13	24	1 1/2 CT	2 7/8	2 7/8
22704	6	2	5 1/2 x 11	18	25	1 3/8 AS		3 3/4
22705	2	1 3/4	7 x 9	14	26 1/2	1 3/4 AS	2 5/8	2 5/8
22706	11	2 WF	5 1/2 x 11	17	30 1/4	2 AS	3 3/4	
22707	2	1 3/4	4 1/4 x 8 13/16	15	26 1/2	1 3/4 AS	2 5/8	2 5/8
22708	3	2	7 x 9	13	19 3/4	2 AS		2 5/8
22709	3	2	7 x 9	13	19 3/4	2 AS		2 5/8
22710	11	1 3/4	7 x 9	15	28 1/4	1 5/8 AS	2 5/8	
22711	3	2	7 x 9	13	21	1 7/8 AS		2 5/8
22712	3	2	7 x 9	13	21	1 7/8 AS		2 5/8
22714	11	2 1/4	4 1/4 x 9 3/4	19	24 1/2	2 1/4 OD	2 7/8	
22715▲	1	3 3/16	10	23 1/2	28 1/2	3 3/16		
22716	1	WF	9 1/2	24	32	3 OD		
22717	2	4	10 1/8	34	40	4	2 1/2	2 1/2
22718	18	1 3/4	7 x 9	13	22 7/8	1 3/4	2 5/8	
22719	6	3	4 1/4 x 9 3/4	23	28	2 1/4		2 7/8
22720	11	1 3/4	4 1/2 x 11	15	22	1 3/4 AS	3	
22721	11	1 3/4	4 1/2 x 11	15	22	1 7/8	3	
22724	11	2 1/4	4 1/4 x 9 3/4	21	33	2 OD	2 7/8	
22725	11	2 1/2	4 1/4 x 9 3/4	21	26	2 1/4 OD	2 7/8	
22726	11	2 1/2	4 1/4 x 9 3/4	21	26	2 1/4 OD	2 7/8	
22727	11	2 1/4	4 1/4 x 9 3/4	21	33	2 OD	2 7/8	
22728	2	2 1/2	7	24	29	2 1/4	1 3/4	1 3/4
22729	2	1 3/4	7 x 9	12	15	1 1/2	2	2
22730▲	2	2 1/2	4 1/8 x 9	19	26	2 OD	2 7/8	2 7/8
22731▲	2	2 1/2	4 1/8 x 9	19	26	2 1/4 OD	2 7/8	2 7/8
22732▲	6	2 1/2	4 1/8 x 9	19	26	2		2 7/8
22733	2	2 1/2	7	26	31	2 1/4	1 3/4	1 3/4
22734	12	2	5 1/2 x 11	19	29 3/4	1 1/2	3 3/4	1 1/2
22735	11	1 3/4	4 1/4 x 8 13/16	12	15	1 1/2	2 5/8	
22736	11	2	4 1/4 x 9 3/4	18	27 1/2	1 3/4	2 7/8	
22737	12	1 3/4	5 1/2 x 11	18	30 1/2	1 1/2	3 3/4	1 1/2
22738	11	2 1/4	4 1/4 x 9 3/4	24	31	2 OD	2 7/8	
22739	11	2 1/4	4 1/4 x 9 3/4	24	38	2 OD	2 7/8	
22740	3	2 3/4	7 x 9	16	21	2 1/2		2 5/8
22741	3	2 3/4	7 x 9	26	32	2 1/2		2 5/8
22742	11	2	4 1/4 x 9 3/4	14	17	1 7/8 OD	2 7/8	
22744	3	2 1/2	4 1/4 x 9 3/4	23	26 1/2	2		2 7/8
22745	11	2 1/2	4 1/4 x 9 3/4	23	26 1/2	2	2 7/8	
22746	2	1 7/8	7 x 9	16	18	1 3/4	2	1 5/8
22747	11	2 1/2	4 1/4 x 9 3/4	23	26 1/2	2 1/4	2 7/8	
22748	12	1 7/8	7	16	29 1/8	1 3/4 (2)	1 3/4	1 3/4
22749	2	1 3/4	7	19	22	1 3/4	1 3/4	1 3/4
22750	12	1 3/4	7	14	29	1 1/2 (2) OD	2	1 1/8, 1 3/4
22751	#	2	5 1/2 x 11	12	21 3/8	2 (2) OD	1 1/2	
22752	12	1 3/4	5 1/2 x 11	16	19 1/2	1 3/4 (2) OD	1 1/2	1 1/2
22753	12	1 7/8	7 x 9	18	19 1/2	1 1/2 (2)	1 5/8	1 5/8
22754	2	1 7/8	7 x 9	15	18	1 3/4	1 5/8	1 5/8
22755	14	2 WF	5 1/2 x 11	20	21 1/4	1 3/4 (2) OD	1 1/2	
22756□	1	1 3/4	7 x 9	12	17 1/2	1 1/2	1 1/2	
22757	2	2	5 1/2 x 11	18	24 1/2	2 AS	3 3/4	3 3/4
22758	3	2 1/4	7 x 9	17	26 3/4	1 3/4 AS		2 5/8
22760	3	1 3/4	4 1/4 x 9 3/4	16	26	1 3/4 AS		2 7/8
22761	3	1 3/4	4 1/4 x 9 3/4	16	26	1 3/4 AS		2 7/8

- ▲ Arc Welded.
- † Double-Wall.
- ◆ Spark Arrestor.
- Welded Heat Shield.
- ◇ Resonator.

- # Special Style, not shown.
- @ Stainless.
- ± Threaded.
- § Tractor.

- AS Aluminized Spout.
- CT Chrome Tip
- SB Spherical Ball.
- SF Spherical Flare Loose Flange.
- SP Spout.

- ST Stainless Tip
- WF Welded Flange.
- WP Welded Pipe.
- WS Welded Spout.

INFORMATION & BUILD TO ORDER

TOOLS AND ACCESSORIES

SCHOOL BUS

MEDIUM DUTY TRUCK GVV 3-6

HEAVY DUTY TRUCK GVV 7-8

APPLICATION BY ENGINE

NOISE AND BACKPRESSURE DATA

TRACTOR

MUFFLER SPECS

O.E. CROSS INDEX

TABLE 1 - MUFFLER SPECIFICATIONS BY PART NUMBER

Part No.	Style	Inlet ID (A)	Shell Dia. (B)	Shell Length (C)	Overall Length (D)	Outlet ID (E)	Inlet Offset (F)	Outlet Offset (G)
22762	10	1 3/4	4 1/4 x 8 13/16	15	18 5/8	1 3/4		
22763	10	1 3/4	4 1/4 x 8 13/16	15	18 5/8	1 3/4		
22764	†▲	3 1/2	7	15	19 3/4	3 1/2		
22765	†▲	2 1/2	6	14	18	2 1/2		
22766	†▲	2	6	15	20 1/4	2		
22767	▲	3	8 3/8	27	29 1/2	3	4 1/2	2
22768	▲	3 1/2	8 1/4 x 11 1/2	26	29 1/2	3 1/2	3 1/2	2 1/2
22769	▲	1 5/8	4 1/4	12 3/4	15	1 5/8	2 1/4	
22770	▲	2 1/2	6 5/8	20 3/4	23 1/2	2 1/2	3 1/2	1 5/8
22771	▲	5	9	20	26 1/2	5		
22772	2	3	7 x 9	20	24	2 1/2	2 5/8	2 5/8
22773	#	2 3/8 OD	6 x 7	36 1/2	42 1/2	2 1/4 OD		
22774	7	6	10 1/8	13 1/4	23 1/2	6		
22775	▲	13	4	10 1/8	28	4	4 1/2	9 1/2
22776	2	3	7 x 9	18	28	3 OD	1 3/4	1 3/4
22777	2	3	7 x 9	24	30	3 OD	2 5/8	2 5/8
22778	11	3	4 1/4 x 9 3/4	23	28 1/2	2 3/4 OD	2 7/8	
22779	2	2 3/4	7 x 9	22	26 1/2	2 3/4 OD	2 5/8	2 5/8
22780	#	2 3/8	4 7/8 x 9 3/4	20	36 1/2	2 AS		
22781	#	2 3/8	4 7/8 x 9 3/4	20	40 1/2	2 AS		
22782	3	2 3/8 WF	4 7/8 x 9 3/4	20	36 1/4	2 3/8 AS		
22783	11	1 3/4 WF	5 1/2 x 11	13	32 3/8	1 3/4 AS	3 3/4	
22784	6	3	4 1/4 x 9 3/4	23	28	2 1/4		2 7/8
22785	9	4	10 x 15	15	19 1/4	4	4 1/4	4
22786	9	4	10 x 15	22	25	4	4 1/4	14 3/4
22787	11	2 1/2	4 1/4 x 9 3/4	21		2 1/4 OD	2 7/8	
22788	11	2 1/2	4 1/4 x 9 3/4	21		2 1/4 OD	2 7/8	
22789	▲	2	11	30	36	4	2 1/2	2 1/2
22790	11	2	4 1/4 x 9 3/4	22	26	2	2 7/8	
22791	3	2 3/8 WF	4 7/8 x 9 3/4	20	39 3/4	2 3/8 AS		
22792	2	WP	7 x 9	20		2	2 5/8	2 5/8
22793	11	2	4 1/4 x 9 3/4	22	25	2	2 7/8	
22794	6	2 1/2	4 1/4 x 9 3/4	23	26 1/2	2 (2)		2 7/8
22795	3	2	7 x 9	18	21	1 3/4		2 5/8
22796	1	2 1/4	4	18	22	2 1/4		
22797	12	1 7/8	7	15	24 3/8	1 1/2 AS	2 1/4	2 1/4
22798	2	2 1/4	7	25	30	2 1/2	1 3/4	1 3/4
22799	3	2 1/4	4 1/4 x 9 3/4	21	25 1/2	2		2 7/8
22808	▲	2	3 1/2	8 3/8	36 1/2	43	3	1 3/4
22810	▲	1	4	7	40	48	4	
22822	▲	5	2 1/2	8 3/8	36 1/2	43	3	2
22823	1	5	9	45	51	5		2 3/8
22827	▲	3	4	8 3/8	33	41	4	1 7/8
22829	1	5	9	44	51	5		
22833	▲	2	5	10 x 15	36	43	5	4
22834	1	4	9	44 1/2	51	4		
22835	†▲	3	4	10 1/2	44	51	4	2 7/16
22839	1	2 1/2	4	21	36 1/2	2 1/2 OD		
22842	3	4	10 1/8	44 1/2	51	4		2 1/2
22844	▲	1	3 1/2	9	45	51	3 1/2	
22852	▲	2	2 3/4	7	33 1/2	40	2 3/4	1 5/8
22861	§	1	3 1/2	5 5/8	28	42 1/4	3 5/8 OD	
22865	▲	5	2 1/2	8 3/8	29 3/4	36 1/4	3	1 5/8
22866	▲	5	2 1/2	8 3/8	29 1/2	38	2 3/4	2 3/8
22877	▲	2	SF	7	35	44	2 3/4	1 5/8
22878	2	SF	7	35	44	SB	1 5/8	1 5/8
22888	▲	2	4	11 1/8	36	41 3/4	4	2 1/2
22890	§	1	2 3/8	4 1/8 x 9	26	29	2 1/2	
22896	1	4	9	44 1/2	51	5		
22897	@	5	SF	9 7/8	40	50	4	1 5/8
22899	▲	2	4	11 1/8	36	42 1/4	4	2 1/2
22904	§	1	3	6 1/8 x 10 1/8	32	48	3 1/4	
22906	@	2	SF	7 1/8	35	44	SB	1 3/4
22907	▲	2	6	10 x 15	31 3/4	42 1/2	6	3 1/2
22910	▲	2	SF	6	29	36	2	1 3/8
22914	▲	1	5	9	33 1/2	40	5	
22915	▲	10	5	10 1/8	44	48	5	6

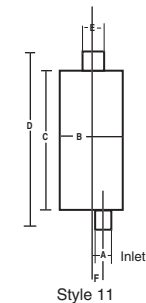
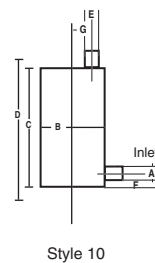
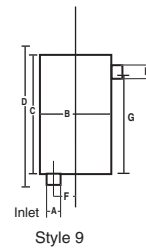
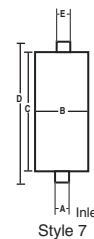
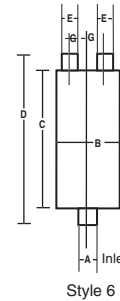
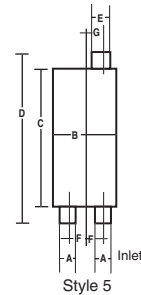
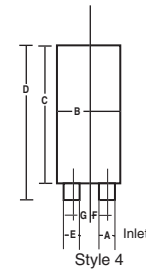
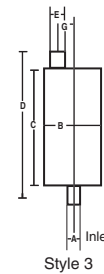
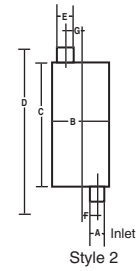
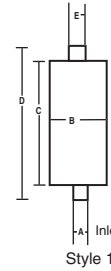

▲ Arc Welded.
 † Double-Wall.
 ◆ Spark Arrestor.
 □ Welded Heat Shield.
 ⚡ Resonator.

Special Style, not shown.
 @ Stainless.
 ‡ Threaded.
 § Tractor.

AS Aluminized Spout.
 CT Chrome Tip
 SB Spherical Ball.
 SF Spherical Flare Loose Flange.
 SP Spout.

ST Stainless Tip
 WF Welded Flange.
 WP Welded Pipe.
 WS Welded Spout.

TABLE 1 - MUFFLER SPECIFICATIONS BY PART NUMBER

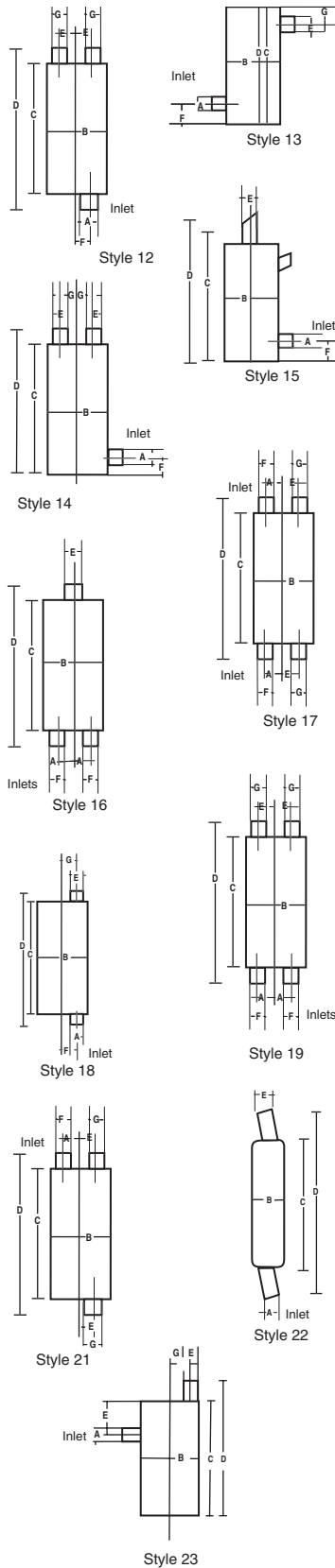

Part No.	Style	Inlet ID (A)	Shell Dia. (B)	Shell Length (C)	Overall Length (D)	Outlet ID (E)	Inlet Offset (F)	Outlet Offset (G)
22916▲	1	4	10	45	51½	4		
22917▲	10	5	10 x 15	36	40	5	6½	3½
22919▲	9	4	10 x 15	44	47¾	4	4¼	5¼
22920▲	1	5	10	44	51	5		
22921§	1	3	5½	32	48	3½ OD		
22922§	1	1⅞	4½ x 9	26	41	2 OD		
22923§	1	1⅞	4½ x 9	18	48½	2 OD		
22924▲	1	5	10	44	51	5		
22925	1	5	10	44	51	5		
22932▲	5	2½	8½	29¾	36¼	3 OD	1½	2
22933	2	2½	7	30	39	2½ OD	1½	1½
22934	11	3	4¼ x 9¾	24	42¼	3 OD	2½	
22935	2	4	8¼ x 11½	39½	45	4	2½	2½
22936▲	1	4	9	44	51	4		
22938▲	1	5	10	60	66½	5		
22939	5	2½	8½	29½	38	2¾	2¾	2
22940▲	1	5	9	44½	51	5		
22941▲	1	4	9	44½	51	5		
22943	2	4	10 x 15	44	50½	5	3½	3½
22944	2	5	10 x 15	44	50½	5	3½	3½
22948	10	4	9	44	48	5	3⅞	
22949	1	4	10	45¼	51½	4		
22950	9	5 OD	12	36	40	5 OD		21½
22951	2	5	10 x 15	44	50	5		
22952	1	4	10	44	51⅞	5		
22956	1	5	10	44	51½	5		
22957	1	3½	9	45	51½	3½		
22958	10	4	11	36	40	4	3½	2½
22959	1	4	9	40	48	4		
22960	2	4	9	44	51	4	1½⅞	1½⅞
22961	1	3½	9	36	43	3½		
22962	1	4	10	44	51	5		
22963	1	5	10	44	51	5		
22964	1	5	9	44	51	5		
22965	1	4	9	44	51	4		
22966	1	4	10	44	51	5		
22967	1	4	11	35	39¾	4		
22969	1	4	10	44	51	4		
22970	1	4	9	44	51	5		
22971	4	5	10 x 15	44	47	5	3⅞⅓	3⅞⅓
22980	1	5	10	44	51	5		
22981	1	5	10	44	51	5		
22990	11	2¼ WF	4¼ x 8⅓⅞	28	41¼	2¼	2½	
22991	2	3	11	36	42	4	2½	2½
24016	22	2½	3½	30	34	2	1½	1½
24030	22	2¼	3½	30	34	2	1½	1½
24038	22	2	3½	14	22	1¾		
24041	22	2	3½	14	20	2	1¼	1¼
24042	22	2	3½	30	34	2	1½	1½
24047	22	2¼	3½	20	25	2	2½	2½
24049	22	2¼	3½	18	24½	2	1¼	1¼
24051	22	2¼	3½	20	27¾	2		
24057	22	2¼	3½	18	23½	2		
24065	22	2	3½	18	24	1⅞		
24069	1	2¼	3½	18	23	2¼		
24079	22	2½	3½	20	25	2 OD	2½	2½
24081	22	2	3½	20	25	2	1½	1½
24090	22	2¼	3½	24	29¾	2¼	1¼	1¼
24091	22	2½	3½	20	26	2¼	1½	1½
24095	22	2¼	3½	20	26	2¼	1½	1½
24098	22	2¼	3½	14	21¾	2¼	1¼	1¼
24099	22	2	3½	18	23¼	2	1¼	1¼
24100	22	2¼	3½	14	21	2	1	1
24102	22	2	3½	20	25	2	2½	2½
24103	22	2½	3½	20	26	2	1½	1½
24104	22	2½	3½	24	29	2¼	1¼	1¼
24117	22	2½	3½	20	25	2¼ OD	2½	2½

- ▲ Arc Welded.
- † Double-Wall.
- ◆ Spark Arrestor.
- Welded Heat Shield.
- ◇ Resonator.

- # Special Style, not shown.
- @ Stainless.
- ± Threaded.
- § Tractor.

- AS Aluminized Spout.
- CT Chrome Tip
- SB Spherical Ball.
- SF Spherical Flare Loose Flange.
- SP Spout.

- ST Stainless Tip
- WF Welded Flange.
- WP Welded Pipe.
- WS Welded Spout.

INFORMATION & BUILD TO ORDER

TOOLS AND ACCESSORIES

SCHOOL BUS

MEDIUM DUTY TRUCK GVV 3-6

HEAVY DUTY TRUCK GVV 7-8

APPLICATION BY ENGINE

NOISE AND BACKPRESSURE DATA

TRACTOR

MUFFLER SPECS

O.E. CROSS INDEX

TABLE 1 - MUFFLER SPECIFICATIONS BY PART NUMBER

Part No.	Style	Inlet ID (A)	Shell Dia. (B)	Shell Length (C)	Overall Length (D)	Outlet ID (E)	Inlet Offset (F)	Outlet Offset (G)
24120	22	2½	3½	18	23	2¼	2⅝	2⅝
24200	1	2	3½	20	25	2		
24201	1	2¼	3½	20	25	2¼		
24202	1	2	3½	22	27	2		
24203	1	2¼	3½	22	27	2¼		
24204	1	2	3½	26	31	2		
24205	1	2¼	3½	26	31	2¼		
24210	1	1¾	3	12	17	1¾		
24211	1	2¼	4	30	35	2¼		
24212	1	2¼	4	40	45	2¼		
24213	1	2½	4	40	45	2½		
24214	1	2½	4	23	28	2½		
24215	1	2½	4	12	16½	2½		
24216	1	3½	5	12	16½	3½		
24217	1	4	5	12	16½	4		
24218	6	2½	4	23	33½	2¼ (2) OD		2¼ (2)
24219	1	3	4	18	23¼	3		
24220	1	2½	4	24	30	2½		
24221	1	3 WF	4	24	30	2½		
24222	1	3	4	12	16½	3		
24223	1	3½ OD	4	20	34½	4 OD		
24224	6	3	4	18	29	2½ (2) OD		3½ (2)
24225	1	2½	4	12	25½	2½ OD		
24226	1	2½	4	12	25½	2½ OD		
24227	4	1¾	4	12	16	3 OD		
24228	4	1⅞	4	12	16	3 OD		
24229	4	2	4½	12	16	3½ OD		
24230	4	2⅛	4½	12	16	3½ OD		
24231	4	2¼	5	12	16	4 OD		
24232	4	2⅜	5	12	16	4 OD		
24233	1	5	6	16	21	5		
24234	1	2¼	4	12	16½	2¼		
24235	1	2¼	4	18	23¼	2¼		
24236	1	2½	4	18	23¼	2½		
24238	1	3	4	12	18¼	3 OD		
24239@	1	2¼	3½	20	25	2¼		
24240@	1	2½	3½	20	25	2½		
24241@	1	3	4	20	25	3		

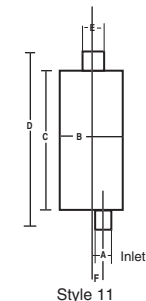
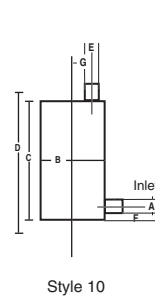
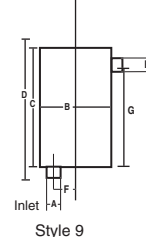
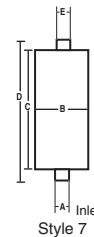
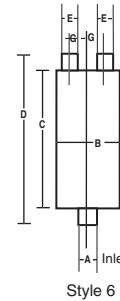
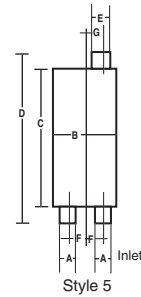
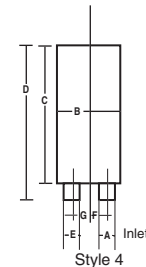
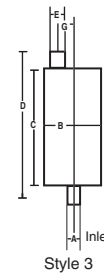
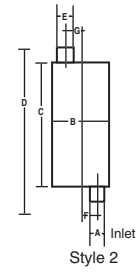
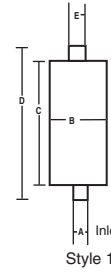

- ▲ Arc Welded.
- † Double-Wall.
- ◆ Spark Arrestor.
- Welded Heat Shield.
- ◇ Resonator.

- # Special Style, not shown.
- @ Stainless.
- ‡ Threaded.
- § Tractor.

- AS Aluminized Spout.
- CT Chrome Tip
- SB Spherical Ball.
- SF Spherical Flare Loose Flange.
- SP Spout.

- ST Stainless Tip
- WF Welded Flange.
- WP Welded Pipe.
- WS Welded Spout.