

ACCESSORIES

90° ELBOWS

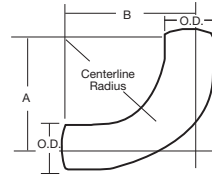
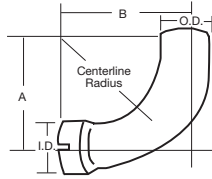

Style ID-OD						
Dia.	Centerline Length A-B	Rad.	ALZ.	Chrome	Stain-less	
1½	6¾-6¾	4	41231	-	-	
1¾	6¾-6¾	4	41000	-	-	
1⅞	6¾-6¾	4	41230	-	-	
2	6¾-6¾	4	41001	-	-	
	7⅞-6¾	4	41154	-	-	
	9-9	4½	41558+	-	-	
2¼	6-6	4	41098+	-	-	
2½	6¼-6¼	4	41002	-	-	
	12-12	5	41441	-	-	
2¾	6¾-6¾	5	41099	-	-	
	12-12	5	41442+	-	-	
3	8-8	6	41365+	-	-	
	10-12	5	41535+	-	-	
	12-12	5	41534+	-	-	
	14-14	8	42759+	-	-	
	14-14	6	42445+	-	-	
3½	6½-6½	3½	41633+	-	-	
	10¼-10¼	5	41768	-	-	
	9-9	7	41366+	-	-	
	16-16	5	42185+	-	-	
4	6-6	4	41630+	-	-	
	8½-13	5	42085	-	-	
	10-10	5	41378+	29146+	-	
	10-10	8	41367+	-	-	
	12-12	6	41472	29109	-	
	15-9	4	52415+	-	-	
	16-16	8	53094+	29211+	52059	
	18-18	8	42937+	-	-	
	22-36	6	44449+	-	-	
	25-32	8	43168+	-	-	
4½	13-13	6	42356+	-	-	
	8½-8½	6	41769	-	-	
	9½-9½	5½	42763+	29108+	-	
	10-10	8	-	29212+	-	
	11½-26¾	5½	43613	-	-	
5	12-12	6	41532+	29210+	-	
	13-16	8	-	29152+	-	
	15-15	5½	42272+	-	-	
	15-15	8	42858+	29147+	-	
	16½-16½	10	43348+	-	-	
	18-18	10	42938+	-	-	
	32-25	8	43438+	-	-	
	6	12-12	10	52058	-	-
		15-15	10	42944+	-	-
26-26		10	44569+	-	-	

Style OD-OD				
Dia.	Centerline Length A-B	Rad.	ALZ.	Chrome
2	9-9	4½	41631+	-
2¼	12-12	5	41762	-
2½	12-12	5	41432+	-
2¾	12-12	5	41433+	-
3	3-3	3	41221+	-
	6-6	3	41685+	-
	7-7	3	41536+	-
	10-10	6	41434+	-
	14-14	8	42344+	-
3½	3½-3½	3½	41222+	-
	6-6	3½	41537+	-
	6½-6½	3½	41637+	-
	12-12	7	41435	-
	16-16	8	42288+	-
4	4-4	4	41223+	-
	7-7	5	41256+	29103+
	7½-7½	6	51039+	-
	8-5	4	41778+	-
	8-8	4	41474+	-
	8-8	5	51059+	-
	8¼-10½	4	52138+	-
	9-9	6	52413+	-
	9-16	5	42936+	-
	10-10	5	51060+	-
5	10-10	6	52119+	29127
	10-13½	6	42407+	-
	10-31	4	53603+	-
	12-12	5	41638+	-
	12-12	6	41473+	-
	16-16	8	43698+	-
	18-18	8	42857	-
	22½-30	8	44112+	-
	5-5	5½	41224+	-
	7½-13½	5½	42253+	-
	8-9	5	52375+	-
	8¼-12½	6	-	29252+
	8⅜-8½	6	42081	-
	8½-8½	6	41538+	-
	8½-11	6	52429+X	29257+X
8¾-14¼	5½	42186	-	
9-9	5½	51056+	-	
9-11½	5½	53095	-	
9½-9½	6	41832+	29151+	
10-16	6	42147+	-	
10½-8½	6	-	29254+	
11-9	6	51057+	-	
11-16	5½	42125+	-	
12-12	6	41436+	-	
15-15	5½	42274+	-	
12-12	8	-	29121+	
15-15	8	42939+	-	
17½-17½	10	43699+	-	
18-18	10	42940+	-	
6	6½-6½	6½	41583+	-
	10-10	10	41559+	-
	12-12	10	41560+	-
	15-15	10	42562+	-

ACCESSORIES

TECH-FIT

HEAVY DUTY TRUCK GVV 7-8

APPLICATION BY ENGINE

MEDIUM DUTY TRUCK GVV 3-6

SCHOOL BUS

AGRICULTURAL

MUFFLER SPECS

O.E. CROSS REFERENCE

ACCESSORIES

45° ELBOWS

Style ID-OD						
Diameter	Bend Angle	Style	Length A-B	Radius	ALZ. Part No.	Chrome Part No.
1½	45	ID-OD	6-6	4	41733	-
1¾	45	ID-OD	6-6	4	41734	-
1⅞	45	ID-OD	6-6	4	41735	-
2	45	ID-OD	6-6	4	41187	-
2¼	45	ID-OD	6-6	4½	41188	-
2½	45	ID-OD	6-6	5	41189	-
2¾	45	ID-OD	6-6	5	41439	-
3	45	ID-OD	7-7	6	42760+	-
3½	45	ID-OD	8-8	7	42761+	-
4	45	ID-OD	5-5	4	41639+	-
	45	ID-OD	6-6	6	41686+	-
	45	ID-OD	9¼-9¼	5	-	29113+
	45	ID-OD	9⅝-9⅝	8	42758+	-
	45	ID-OD	12-12	6	42246+	29143+
5	45	ID-OD	6-6	5½	41640+	-
	45	ID-OD	7-7	8	42355+	-
	45	ID-OD	8-8	10	41477+	29220+
	45	ID-OD	12-12	8	42855+	-
	45	ID-OD	12-12	10	42453+	29200+
6	45	ID-OD	7-7	10	42053+	-

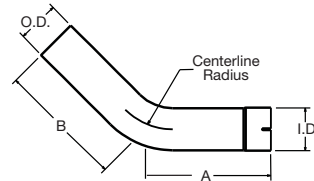

Style OD-OD						
Diameter	Bend Angle	Style	Length A-B	Radius	ALZ. Part No.	Chrome Part No.
2½	45	OD-OD	6-6	4	41438+	-
2¾	45	OD-OD	6-6	5	41440	-
3	45	OD-OD	4-4	3	41641+	-
	45	OD-OD	7-7	6	41428+	-
3½	45	OD-OD	8-8	7	41429+	-
4	45	OD-OD	6-6	6	41632+	-
	45	OD-OD	8-8	5	41430+	-
	45	OD-OD	8-8	8	41475+	-
	45	OD-OD	12-12	6	42247+	-
5	45	OD-OD	8 - 13	6	52406+	-
	45	OD-OD	8-8	5½	41612+	-
	45	OD-OD	8-8	8	41431+	-
	45	OD-OD	8-8	10	41476+	-
	45	OD-OD	15-15	8	42249+	-
6	45	OD-OD	7-7	10	52134+	-
6	45	OD-OD	6-12	6	52406+	-

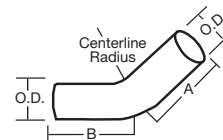

ALZ Aluminized + Mandrel Bent

MISCELLEANEOUS ELBOWS

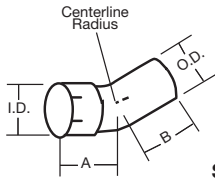

Style ID-OD

Style ID-OD						
Diameter	Bend Angle	Style	Length A-B	Radius	ALZ. Part No.	Chrome Part No.
1½	20	ID-OD	6-6	4	41813	-
1¾	20	ID-OD	6-6	4	41814	-
1⅞	20	ID-OD	6-6	4	41815	-
2	20	ID-OD	6-6	4	41816	-
2¼	20	ID-OD	6-6	4	41817	-
2½	20	ID-OD	6-6	4	41437+	-
3½	30	ID-OD	4-4	5	41618+	-
	60	ID-OD	8-8	5	41626+	-
4	30	ID-OD	4-4	5	41619+	-
	30	ID-OD	5-4	6	51049+	-
	60	ID-OD	8-8	5	41627+	-
	85	ID-OD	20-13	6	52393+	-
5	30	ID-OD	4-4	6	41620+	-
	30	ID-OD	5-5	6	51050+	-
	35	ID-OD	4½-3	6	41833+	-
	35	ID-OD	7-4	6	51046+	-
	60	ID-OD	6-5	6	51037+	-
	60	ID-OD	8-8	6	41628+	-
	85	ID-OD	12-14½	8	-	29253+

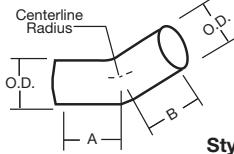

Style OD-OD

Style OD-OD						
Diameter	Bend Angle	Style	Length A-B	Radius	ALZ. Part No.	Chrome Part No.
3½	30	OD-OD	4-4	5	41614	-
	60	OD-OD	8-8	5	41622+	-
4	15	OD-OD	2-2	8	41204+	-
	30	OD-OD	4-4	5	41615+	-
	60	OD-OD	8-8	5	41623+	-
	80	OD-OD	7½-27	5	53199+	-
	80	OD-OD	8-13	5	52391+	-
	80	OD-OD	8-13	6	52392+	-
	92	OD-OD	13-12	6	52414+	-
5	15	OD-OD	4-4	8	41217+	-
	28	OD-OD	26-11	8	53594+	-
	30	OD-OD	4-4	6	41616+	-
	57	OD-OD	7-10	8	-	29261+
	60	OD-OD	8-8	6	41624+	-
	67	OD-OD	7½-11	8	42856+	29209+

ALZ Aluminized + Mandrel Bent

ACCESSORIES

TECH-FIT

HEAVY DUTY TRUCK
GVW 7-8

APPLICATION BY ENGINE

MEDIUM DUTY TRUCK
GVW 3-6

SCHOOL BUS

AGRICULTURAL

MUFFLER SPECS

O.E. CROSS REFERENCE

ACCESSORIES

CLAMPS

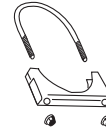
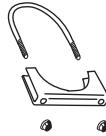
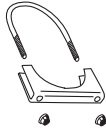

STANDARD DUTY CLAMP
5/16" U-Bolt

Size	Indiv. Pkg. (50)	Bulk Pkg. (50)
1 1/8	35322	35599▲
1 1/4	35323	—
1 3/8	35324	—
1 1/2	35325	34112
1 5/8	35405	34158
1 3/4	35406	34134
1 7/8	35407	34178
2	35408	34200
2 1/8	35334	34218
2 1/4	35413	34214
2 1/2	35414	34212

HEAVY DUTY CLAMP
3/8" U-Bolt

Size	Indiv. Pkg. (50)	Bulk Pkg. (50)
1 1/2	36509	33112
1 5/8	36510	—
1 3/4	35343	33134
1 7/8	35344	33178
2	35335	33200
2 1/8	35364	33218
2 1/4	35336	33214
2 1/2	35337, 35354✓	33212
2 3/4	35793	—
3	35794	33300
3 1/2	35753	—
4	35752+	33304▲+
4 1/2	35424	—
5	35775 ✓+	33305▲+

HEAVY DUTY CLAMP w/WELDED SADDLE
3/8" U-Bolt

Size	Indiv. Pkg. (50)
2 1/2	36248+
3	35772, 36249+
3 1/4	35760
3 1/2	35773, 36482+
4	35774
4 7/16	35758
5	35757
6	35795



GUILLOTINE CLAMP
3/8" U-Bolt

Size	Non-Chrome Indiv. Pkg. (50)	Chrome Indiv. Pkg.
2	36145	—
2 1/2	35304	—
2 3/4	36147	—
3	35786	—
3 1/4	35445	—
3 1/2	35787	—
4	35788+	35456
4 7/16	35410	—
4 1/2	35373‡	—
5	35789+‡	35457‡
5 1/2	35447‡	—
6	35409	35497‡



FLAT STRAP - BOLT CLAMP
3/8" U-Bolt

Size	Non-Chrome Indiv. Pkg.	Chrome Indiv. Pkg.
3	35624	35444‡
3 1/2	35696‡	35694‡
4	35799‡	35776
5	35800‡	35777
5 1/2	35446	—
6	35693‡	35692‡

CLAMPS

Size	HEAVY DUTY	STAINLESS STEEL U-CLAMPS
	w/Slotted U-Bolt Holes 11 Gauge Saddle $\frac{3}{8}$ " U-Bolt	T-304 Stainless Steel 11 Gauge Saddle $\frac{3}{8}$ " U-Bolt
1½	32112#	-
1¾	32134#	32215‡
1⅞	32178#	-
2	32200#	32216‡
2¼	32214#	32217‡
2½	32212#	32218‡
3	32300#	32219‡

Order in Qty. of 50. ‡ Order in Qty. of 10.



Narrow Band Clamp

Size	Aluminized Steel Part No.	430 Bright Stainless Steel Part No.
2¼	36433	36437
2½	36434	36438
2¾	36460	36461
3	36435	36439
3½	36436	36440
4	35227‡	36441
5	35228‡	36442

‡ Order in Qty. of 10.



Heavy Duty ¼" Wire Ring Clamp Zinc Plated

Size Range	Part No.
2⅝ to to 2½	35723
2⅞ to to 2¾	35510

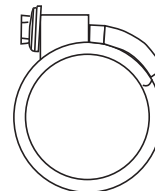

ACCESSORIES

TECH-FIT

HEAVY DUTY TRUCK GVV 7-8

APPLICATION BY ENGINE

MEDIUM DUTY TRUCK GVV 3-6

SCHOOL BUS

AGRICULTURAL

MUFFLER SPECS

O.E. CROSS REFERENCE

ACCESSORIES

BAND CLAMPS

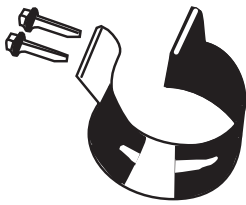

Lap Joint Connects OD to ID Pipes

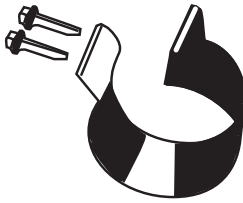

Butt Joint Connects
OD to OD or ID to ID Pipes

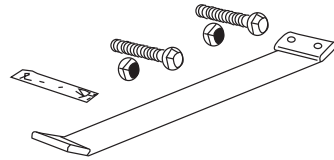

Size	Walker MEGA Clamps	
	Aluminized	Stainless
2	33974‡	33230‡
2¼	33975‡	33231‡
2½	33976‡	33226‡
2¾	33977‡	33227‡
3	33284‡	33272‡
3½	33285‡	33273‡
4	33286‡	33274‡
4	33319‡□	33260‡□
4½	33287‡	33275‡
5	33288‡	33276‡
5	33321‡□	33262‡□
6	33289‡	33277‡

Size	Walker MEGA Clamps	
	Aluminized	Stainless
2	33978‡	33228‡
2¼	33979‡	33229‡
2½	36148‡	33240‡
2¾	36149‡	33241‡
3	33310‡	33278‡
3½	33311‡	33279‡
4	33312‡	33280‡
4½	–	33281‡
5	33314‡	33282‡
6	33315‡	33283‡

ECONOMY FLAT BAND CLAMPS		
Size	Aluminized	Stainless
3	–	35934‡
3½	35291‡	35936‡
4	35292‡	35937‡
5	35293‡	35938‡
6	–	35939‡

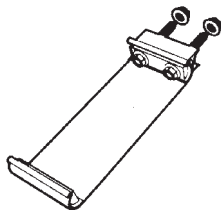

PREMIUM FLAT BAND CLAMP	
Size	Stainless
2	35620‡
2¼	35621‡
2½	35979‡
2¾	35622‡
3	35978‡
3¼	35415‡
3½	35977‡
3¾	35416‡
4	35976‡
4½	35423‡
5	35975‡
6	35980‡

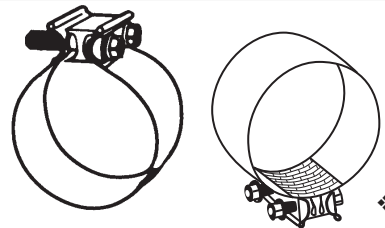

TORCTITE® PREFORMED CLAMPS		
Size	Aluminized Lap Joint	Stainless Lap Joint
2½	–	33220‡
3	33967‡	33222‡
3¼	–	–
3½	33968‡	33223‡
3¾	–	–
4	33969‡	33224‡
4	33980❖X	33981❖X
5	33970‡	33225‡
5	–	33983❖X
6	–	33271X

❖ With Fiberglass Gasket.

TorcTite® is a registered trademark of Torca, Auburn Hills, MI

V BAND CLAMPS

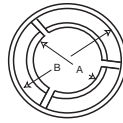
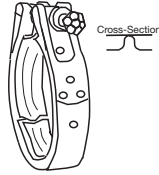

Manufacturer	Part	Tube	A	B	C	Application
	35449	3.13	3.40	3.96	0.21	Fits - OEM Mufflers
	35805	4.00	4.25	4.81	0.21	Fits - Flared Connectors.
	35500	5.00	5.25	5.81	0.21	Fits - Flared Connectors.
Airesearch	35449	3.00	3.40	3.96	0.21	Replaces #154977
	35449	3.00	3.40	3.96	0.21	4LF-TE0699
	35500	5.00	5.25	5.81	0.21	T-1899, TH08A64
Bluebird	35636	2.75	2.92	3.20	0.26	Replaces Bluebird #1334226
	35636	2.75	2.92	3.20	0.26	1994-88 Bluebird TC2000 School Bus w/5.9L
	35131	4.00	4.12	4.69	0.40	Replaces Bluebird #1250646
	35131	4.00	4.12	4.69	0.40	Bluebird All American w/Cat 3116 /Turbo
	35805	4.00	4.25	4.81	0.21	Replaces Bluebird #0997791
	35805	4.00	4.25	4.81	0.21	1990-80 Bluebird School Bus w/8.2LT
Caterpillar	35520	3.50	3.63	4.19	0.40	3208T
	35804	3.50	3.94	4.50	0.21	3208T
	35131	4.00	4.12	4.69	0.40	3208T
	35036	4.25	4.12	4.81	0.40	3176T
	35290	4.00	4.19	4.75	0.40	3176T
	35806	5.00	5.32	5.88	0.40	3406, 3406B, 3176
Cummins	35636	2.75	2.92	3.20	0.26	6BT5.9L, 6BTA5.9L
	35690	3.00	3.32	3.88	0.40	V555, V902, V903
	35496	3.50	3.69	4.25	0.40	VT555, VT-555 Manifold
	35804	3.50	3.94	4.50	0.21	VT555
	35036	4.25	4.12	4.81	0.40	L10
	35290	4.00	4.19	4.75	0.40	L10
	35806	5.00	5.32	5.88	0.40	750, N, 88NT, NTC, VT
Detroit Diesel	35695	3.00	3.26	3.82	0.21	6V53, 6V71
	36225	2.75	3.82	4.10	0.26	
	35495	3.00	3.47	4.06	0.24	
	35494	3.50	3.75	4.31	0.21	Unknown
	35804	3.50	3.94	4.50	0.21	4-53, 8V71, 8V92
	35499	4.00	4.12	4.75	0.16	8.2LT
	35805	4.00	4.25	4.81	0.21	6-71T, 8.2N, 8.2T, 12V71
	35641	4.00	4.32	4.91	0.29	6-71N
	35746	4.00	4.97	5.25	0.26	8V-71T, 16V-71, 6V-92T, 8V-92, 8V-92T, 16V-92T
	35500	5.00	5.25	5.81	0.21	8V-71T
	35806	5.00	5.25	5.88	0.40	Series 60, 6-71T
	36213	5.00	5.33	5.92	0.29	8V-71T (End away from Turbo)
Ford	36210	2.50	3.26	3.90	0.40	Ford # E5HZ5A231B
	35636	2.75	2.92	3.20	0.26	1995-93 B600/700 w/5.9LT
	35636	2.75	2.92	3.20	0.26	Replaces Ford #F3HZ5A281A
	36225	2.75	3.82	4.10	0.26	Ford #E0HZ5A231B
	35950	3.00	Spec	3.62	0.29	Replaces Ford #F1HZ5C210A, E9HZ5A231B
	35950	3.00	Spec	3.62	0.29	1995-89 Med/Truck/Bus w/370, 429 gas
	35695	3.00	3.26	3.82	0.21	All Models w/DD 6V53, 6V71
	35695	3.00	3.26	3.82	0.21	All Models w/Cummins V555, V902
	35401	3.00	3.26	3.88	0.43	Ford D9HT-51210-DA
	35401	3.00	3.26	3.88	0.43	1988-79 Ford Med Truck/Bus w/370, 429 gas
	35495	3.00	3.47	4.06	0.24	8.2L NA
	35520	3.50	3.63	4.19	0.40	Replaces Ford #E2HZ5A231A
	35520	3.50	3.63	4.19	0.40	1990-87 B600/700 School bus CF600/800 w/6.6LT
	35520	3.50	3.63	4.19	0.40	Replaces Ford #E8HZ5A231E
	35496	3.50	3.69	4.25	0.40	1994-87 CF600/800, F600/800 w/7.8LT
	35496	3.50	3.69	4.25	0.40	Replaces Ford #E7HZ5A231C
	35499	4.00	4.12	4.75	0.16	Replaces Ford #E0HZ5A231C
	35805	4.00	4.25	4.81	0.21	All Models w/DD 6-71T, 8.2N, 8.2T, 12V71

ACCESSORIES

TECH-FIT

HEAVY DUTY TRUCK
GVW 7-8

APPLICATION BY ENGINE

MEDIUM DUTY TRUCK
GVW 3-6

SCHOOL BUS

AGRICULTURAL

MUFFLER SPECS

O.E. CROSS REFERENCE

ACCESSORIES

V BAND CLAMPS (Cont.)

Manufacturer	Part	Tube	A	B	C	Application
Freightliner	35806	5.00	5.32	5.88	0.40	FLD Models w/DD Series 60, CAT 3406
	35806	5.00	5.32	5.88	0.40	FLD Models w/Cummins NTC, VT diesel
	35806	5.00	5.32	5.88	0.40	Replaces Freightliner #0114596000
GM	36225	2.75	3.82	4.10	0.26	
	35495	3.00	3.47	4.06	0.24	1980-90 GM Med Truck/Bus w/8.2L NA
	35495	3.00	3.47	4.06	0.24	Replaces GM #2069773
	35036	4.25	4.12	4.81	0.40	Topkick/Kodiak w/6.6L
	35036	4.25	4.12	4.81	0.40	Replaces GM# 15647159
35805	4.00	4.25	4.81	0.21	All Models w/DD6-71T, 8.2N, 8.2T, 12V71	
Mack	35804	3.50	3.94	4.50	0.21	All Models w/DD 4-53, 8V71, 8V92, CAT 3208T
	35804	3.50	3.94	4.50	0.21	All Models w/Cummins VT-555
	35498	4.00	4.17	4.61	0.16	Replaces Mack #48RU2341
	35498	4.00	4.17	4.61	0.16	DM/MR Models
	35805	4.00	4.25	4.81	0.21	All Models w/DD 6-71T, 8.2N, 8.2T, 12V71
	35806	5.00	5.32	5.88	0.40	Replaces Mack #11ME241
International/ Navistar	35695	3.00	3.26	3.82	0.21	Replaces Navistar #425624R91
	36212	3.00	3.28	3.84	0.21	Replaces Navistar #2033978C1
	35496	3.50	3.69	4.25	0.40	1986-89 Series S Truck/Bus w/DT360
	35496	3.50	3.69	4.25	0.40	Replaces Navistar #893944R92
	35496	3.50	3.69	4.25	0.40	Replaces International #3553803C2
	35494	3.50	3.75	4.31	0.21	Replaces Navistar #338614C1
	35494	3.50	3.75	4.31	0.21	1988-94 Series S Truck/Bus w/DT466
	136374	3.50	3.86	4.38	0.19	2001 Int'l Bus 3800 Series w/T444E
	35804	3.50	3.94	4.50	0.21	Replaces Navistar #434252R91
	35804	3.50	3.94	4.50	0.21	All Models w/DD 4-53, 8V71, 8V92, CAT 3208T
	35804	3.50	3.94	4.50	0.21	All Models w/Cummins VT-555
	35290	4.00	4.19	4.75	0.40	Replaces Navistar #893945R92
	35290	4.00	4.19	4.75	0.40	7.3L, DT-DTA 360, DT-DTA 466
	35641	4.00	4.32	4.91	0.29	Replaces Navistar #433192R91
	35641	4.00	4.32	4.91	0.29	All Models w/6-71N
	35746	4.00	4.97	5.25	0.26	9300 Series w/DD 8V71, 8V92
	35746	4.00	4.97	5.25	0.26	Replaces Navistar #5132650
35746	4.00	4.97	5.25	0.26	Replaces Navistar #780067C91	
35806	5.00	5.25	5.88	0.40	2500/2600 Series w/Detroit 6-71T, Series 60, Cat 3406	
35806	5.00	5.25	5.88	0.40	Replaces Navistar #1672105C91	
35806	5.00	5.25	5.88	0.40	Replaces Navistar #390226C91	
Peterbilt	35500	5.00	5.25	5.81	0.21	Peterbilt #14-11039
Thomas	35520	3.50	3.63	4.19	0.40	1990-84 Saf-t-liner Models w/3208T
	35520	3.50	3.63	4.19	0.40	Replaces Thomas #61240207
	35131	4.00	4.12	4.69	0.40	1989-84 Thomas School Bus w/3208T
	35131	4.00	4.12	4.69	0.40	Replaces Thomas #61240208

FLARED ADAPTERS

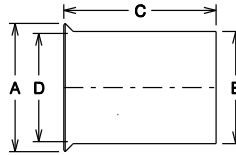

Part No.	A Dia	B Dia	C Dia	D Dia	Flare Angle	Application	V-Band No.	
41960	5.69 OD	5.00 OD	6.00	5.00 OD	-	Cummins	35806	
35110	4.25 OD	3.69 OD	1.50	3.75 OD	20	Navistar	35804	
35747	5.15 OD	4.81 OD	1.94	4.54 OD		Detroit Diesel 8V-71T, 16V-71, 6V-92T, 8V-92T, 16V-92T	35746	
41645	3.78 OD	3.00 ID	3.00	3.00 ID		Ford, Detroit Diesel 6V-71, 6V-73, Cummins V555, V902	35449	
41647	4.30 OD	3.50 OD	4.00	3.58 ID		Detroit Diesel 8V-71	35804	
41648	4.30 OD	3.50 OD	3.00	3.50 OD		Detroit Diesel 8V-92, 4-53	35520	
41651	4.25 OD	4.00 OD	4.00	3.50 ID		Detroit Diesel 8.2N, Cummins VT225	35496	
41652	4.80 OD	4.00 OD	3.00	4.00 OD		Detroit Diesel 6-71, 8.2N, 8.2T, Mack	35499	
41655	5.72 OD	5.00 OD	3.00	5.00 OD		CAT, Cummins, Navistar	35806	
41662	3.90 OD	3.00 ID	2.50	3.00 ID		GMC Truck / Bus 8.2N	35495	
41688	5.15 OD	5.00 OD	4.50	4.50 OD		Detroit Diesel 8V-71T, 16V-71T, 6V-92T, 8V-92T	35746	
41689	5.87 OD	5.00 OD	6.25	5.00 OD		T-50 Turbocharger	35806	
41696	5.75 OD	5.00 OD	5.50	5.00 OD		Navistar	35806	
51048	5.62 OD	5.00 OD	5.00	5.00 OD		Kenworth Turbo w/ EGT Fitting	35806	
41646	3.62 OD	3.00 OD	4.00	3.00 ID		22	Detroit Diesel 6V-71	35695
41650	4.75 OD	4.00 OD	4.00	4.00 ID			Detroit Diesel 12V-71	35641
41860	4.25 OD	4.00 OD	4.00	3.75 OD			Detroit Diesel 8V-71	35804
41864	4.25 OD	3.50 OD	4.00	3.625 ID	Detroit Diesel 8V-71		35804	
41865	4.00 OD	3.50 OD	3.50	3.50 OD	CAT 3208T		35520	
41872	4.25 OD	3.50 OD	4.00	3.625 ID	Detroit Diesel 8V-71		35804	
41875	5.75 OD	5.00 ID	5.00	5.00 OD	-		35806	
41649	4.00 OD	3.50 OD	3.00	3.50 OD	45		Detroit Diesel	35494
41653	4.50 OD	4.00 OD	5.00	4.00 OD			Cummins	35805
41654	5.50 OD	5.00 OD	5.00	5.00 OD			Cummins	35500
41656	3.62 OD	3.00 OD	4.75	3.125 ID		-	35449	
41657	4.00 OD	3.50 OD	4.75	3.50 ID		-	35494	
41658	5.50 OD	5.00 OD	4.75	5.00 ID		-	35500	
41659	3.50 OD	3.00 OD	3.50	3.00 OD		-	35695	
41862	4.00 OD	3.50 OD	5.00	3.50 OD		Detroit Diesel 6V-71	35494	
41863	4.50 OD	4.00 OD	4.75	4.00 ID	-	35805		

ACCESSORIES

TECH-FIT

HEAVY DUTY TRUCK
GVW 7-8

APPLICATION BY ENGINE

MEDIUM DUTY TRUCK
GVW 3-6

SCHOOL BUS

AGRICULTURAL

MUFFLER SPECS

O.E. CROSS REFERENCE

ACCESSORIES

GASKET IDENTIFICATION CHARTS

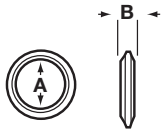

Figure 1

Gasket No.	A	B
31400†	2 ¹ / ₃₂	1 ⁹ / ₃₂
31405†	2 ³ / ₈	9 ¹ / ₁₆
31508 ¹	2 ⁹ / ₁₆	1 ¹ / ₂
31821	2 ³ / ₄	5 ⁵ / ₈

† Shipped in lots of 10 - Std. Carton

1 Sintered Iron Material

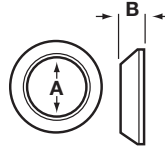

Figure 2

Gasket No.	A	B
31417 ¹	2 ¹ / ₈	Z ⁷ / ₃₂

1 Sintered Iron Material

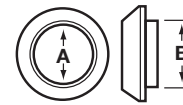

Figure 3

Gasket No.	A	B
31394	2 ¹ / ₄	2 ¹ / ₂

FLANGE IDENTIFICATION CHARTS

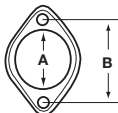

Figure 1

Flange No.	A	B
31887	2 ¹⁹ / ₃₂	3 ³ / ₄

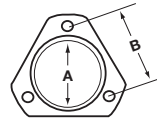
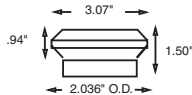

Figure 2

Flange No.	A	B
31803	2 ¹ / ₈	2 ³ / ₄
31850	2 ³ / ₈	3
31875	2 ⁷ / ₁₆	3 ¹¹ / ₁₆
31883	2 ⁵ / ₈	3 ¹ / ₁₆

Flange No.	A	B
31891	2 ¹ / ₈	2 ⁵ / ₈
31923	2 ¹¹ / ₁₆	3
31952	2 ⁵ / ₈	3 ¹ / ₄

SINGLE PIECE INSERTS



35490
Chevrolet/GMC
Medium Truck/Bus
w/366, 427 engine.

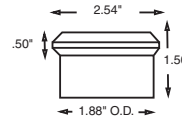

35597
Chevrolet/GMC
Medium Truck/Bus
w/350 engine.

ALUMINIZED TILT CAB CONNECTORS

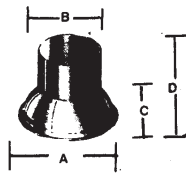

Top

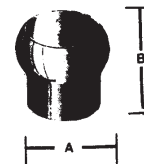

Bottom

Part No.	A	B	C	D
41479	5 ³ / ₄ OD	4 OD	2 ¹ / ₂	7
41539	6 ³ / ₄ OD	5 OD	3 ¹ / ₂	7 ³ / ₄

Part No.	A	B
41480	4 ID	4 ¹ / ₂
41540	5 ID	5 ¹ / ₄

CONNECTORS – REDUCERS

I.D. - I.D. CONNECTOR

Connects O.D. pipes and/or tubing of the same size.

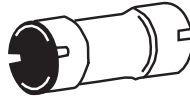

Part No.	I.D. - I.D.	Lgth.
41919	1½-1½	4
41921	1⅝-1⅝	4
41926	1¾-1¾	4
41933	1⅞-1⅞	4
41940	2-2	4
41948	2⅛-2⅛	4
41951	2¼-2¼	4
41957	2½-2½	4
41967	2¾-2¾	4
41812	3-3	4
41892	3-3	6
41893	3½-3½	6
51064	4-4	5
41895	4-4	8
41899	5-5	8
41557	6-6	8

O.D. - O.D. CONNECTOR

Connects I.D. pipes and/or tubing of the same size. Also used on manifold outlet.



Part No.	O.D. - O.D.	Lgth.
41945	2-2	4½
41964	2½-2½	4½
41971	3-3	6
41979	3½-3½	6
41987	4-4	8
41992	5-5	8

I.D. - O.D. CONNECTOR

Connects O.D. & I.D. pipes and/or tubing of the same size.

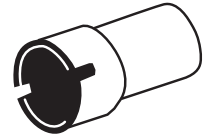

Part No.	I.D. - O.D.	Lgth.
41810	1½-1½	4
41920	1½-1½	12
41882	1¾-1¾	5
41931	1¾-1¾	12
41759	1⅞-1⅞	4
41944	2-2	4½
41902	2-2	10
41947	2-2	12
41954	2¼-2¼	4½
41956	2¼-2¼	12
41965	2½-2½	4½
41966	2½-2½	12
42596	2½-2½	18
41811	3-3	4
41970	3-3	6
41976	3-3	12
42606	3-3	18
41978	3½-3½	6
41983	3½-3½	12
42127	3½-3½	18
41896	4-4	8
42891	4-4	18
42531	4-4	24
41780	4½-4½	4¾
41897	5-5	8
42126	5-5	18
42530	5-5	24
41889	6-6	8

REDUCING BUSHINGS

Reduces the I.D. of a muffler inlet or outlet without increasing the muffler overall length.



Part No.	O.D. - I.D.
36275	1½-1⅝
35253†	2-1⅞
35254†	2⅞-2

† Packed 6 bushings per carton.

ACCESSORIES

TECH-FIT

HEAVY DUTY TRUCK
GVW 7-8

APPLICATION BY ENGINE

MEDIUM DUTY TRUCK
GVW 3-6

SCHOOL BUS

AGRICULTURAL

MUFFLER SPECS

O.E. CROSS REFERENCE

ACCESSORIES

CONNECTORS – REDUCERS

I.D. - I.D. REDUCER

Reduces O.D. pipe and/or tubing of different sizes.

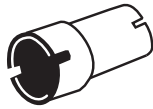

Part No.	I.D. - I.D.	Lgth.
41922	1 $\frac{5}{8}$ -1 $\frac{1}{2}$	4 $\frac{1}{2}$
41927	1 $\frac{3}{4}$ -1 $\frac{1}{2}$	4 $\frac{1}{2}$
41929	1 $\frac{3}{4}$ -1 $\frac{5}{8}$	4 $\frac{1}{2}$
41934	1 $\frac{7}{8}$ -1 $\frac{3}{4}$	4 $\frac{1}{2}$
41886	2-1 $\frac{1}{2}$	4
41941	2-1 $\frac{3}{4}$	4 $\frac{1}{2}$
41943	2-1 $\frac{7}{8}$	4 $\frac{1}{2}$
41952	2 $\frac{1}{4}$ -2	4 $\frac{1}{2}$
41958	2 $\frac{1}{2}$ -2	4 $\frac{1}{2}$
41961	2 $\frac{1}{2}$ -2 $\frac{1}{4}$	4 $\frac{1}{2}$
41973	3-2 $\frac{1}{2}$	6
41687	3-2 $\frac{3}{4}$	6
41981	3 $\frac{1}{2}$ -3	6
41989	4-3	6
41894	4-3 $\frac{1}{2}$	6
41898	5-4	8
41879	5-4 $\frac{1}{2}$	6
41998	6-5	6

I.D. - O.D. REDUCER

Reduces larger O.D. pipes and/or tubing to smaller I.D. pipe. Also used as muffler bushing or manifold outlet.

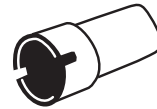

Part No.	I.D. - O.D.	Lgth.
41855	1 $\frac{1}{2}$ -1 $\frac{3}{8}$	4
41923	1 $\frac{5}{8}$ -1 $\frac{1}{2}$	4 $\frac{1}{2}$
41928	1 $\frac{3}{4}$ -1 $\frac{1}{2}$	4 $\frac{1}{2}$
41930	1 $\frac{3}{4}$ -1 $\frac{5}{8}$	4 $\frac{1}{2}$
41932	1 $\frac{7}{8}$ -1 $\frac{3}{4}$	2 $\frac{5}{8}$
41939	2-1 $\frac{3}{4}$	2 $\frac{5}{8}$
41942	2-1 $\frac{7}{8}$	4 $\frac{1}{2}$
41949	2 $\frac{1}{8}$ -2	4 $\frac{1}{2}$
41888	2 $\frac{1}{4}$ -1 $\frac{7}{8}$	4
41955	2 $\frac{1}{4}$ -2	4 $\frac{1}{2}$
41854	2 $\frac{1}{4}$ -2 $\frac{1}{8}$	4
41959	2 $\frac{1}{2}$ -2	4 $\frac{1}{2}$
51065	2 $\frac{1}{2}$ -2 $\frac{1}{32}$	4
41962	2 $\frac{1}{2}$ -2 $\frac{1}{4}$	4 $\frac{1}{2}$
41999	2 $\frac{3}{4}$ -2 $\frac{1}{2}$	8
41974	3-2 $\frac{1}{2}$	6
41982	3 $\frac{1}{2}$ -3	6
41563	4-3	6
41984	4-3 $\frac{1}{2}$	6
41909	5-4	6
41997	6-5	6

O.D. - O.D. REDUCER

Reduces I.D. pipe and/or tubing of different sizes.

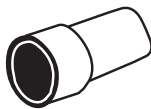

Part No.	O.D. - O.D.	Lgth.
41908	2-1 $\frac{1}{8}$	5 $\frac{1}{4}$
41937	2-1 $\frac{1}{16}$	4 $\frac{1}{2}$
41700	2 $\frac{1}{4}$ -2	4 $\frac{1}{2}$
41917	2 $\frac{1}{2}$ -2	4 $\frac{1}{2}$
41918	2 $\frac{1}{2}$ -2 $\frac{1}{4}$	4 $\frac{1}{2}$
41890	4-3	8
41891	5-4	8
41845	5-4 $\frac{1}{2}$	6
41844	6-4	6
41515	6-5	8

O.D. - I.D. REDUCER

Reduces larger I.D. pipe and/or tubing to smaller O.D. pipe. Also used as Muffler busing or manifold outlet.



Part No.	O.D. - I.D.	Lgth.
41883	1 $\frac{1}{2}$ -1 $\frac{3}{8}$	4
41924	1 $\frac{5}{8}$ -1 $\frac{1}{2}$	4 $\frac{1}{2}$
41925	1 $\frac{3}{4}$ -1 $\frac{5}{8}$	2 $\frac{5}{8}$
41885	1 $\frac{7}{8}$ -1 $\frac{1}{2}$	4 $\frac{1}{2}$
41935	1 $\frac{7}{8}$ -1 $\frac{3}{4}$	4 $\frac{1}{2}$
41946	2-1 $\frac{3}{4}$	5 $\frac{3}{8}$
41950	2 $\frac{1}{8}$ -2	4 $\frac{1}{2}$
41400	2 $\frac{1}{4}$ -1 $\frac{3}{4}$	4 $\frac{1}{2}$
41953	2 $\frac{1}{4}$ -2	4 $\frac{1}{2}$
41960	2 $\frac{1}{2}$ -2	4 $\frac{1}{2}$
41963	2 $\frac{1}{2}$ -2 $\frac{1}{4}$	4 $\frac{1}{2}$
41968	2 $\frac{3}{4}$ -2 $\frac{1}{2}$	4 $\frac{1}{2}$
41972	3-2 $\frac{1}{2}$	6
41975	3-2 $\frac{3}{4}$	6
41980	3 $\frac{1}{2}$ -3	6
41988	4-3	6
42956	4-3	13
41991	4-3 $\frac{1}{2}$	6
41994	5-4	6
41786	5-4 $\frac{1}{2}$	6
41514	6-5	8

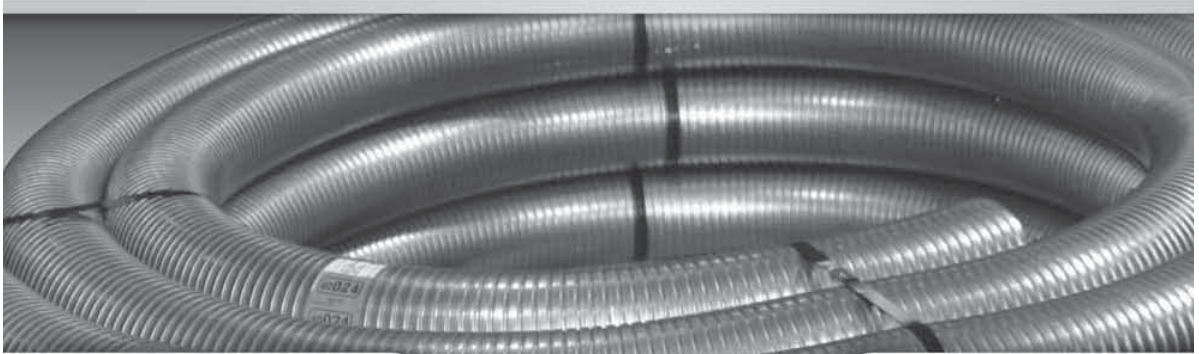

How to Measure:

When you are ready to put Flex Pipe to use, follow these instructions for determining the length to cut the pipe. NOTE: All flexible metal tubing is measured fully extended.

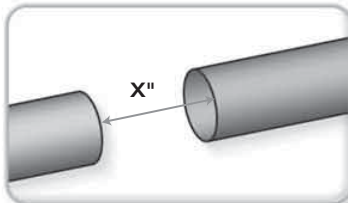

Determine the length (X") of pipe needed for your application by measuring the gap between the two pipes you intend to connect.

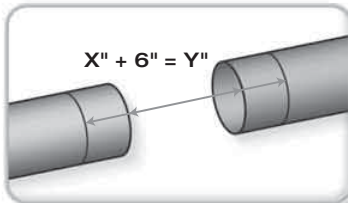

Allow a 3" overlap for each end (add 6" to the measurement from above). This is the length (Y") of Flex Pipe needed.

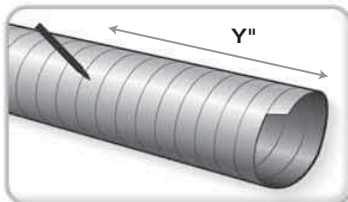

Measure distance needed from the far right side inward. Wrap area to be cut with duct tape. Use a marker to draw a cut guide on the tape. Flex Pipe is now ready to be cut. Cut through the tape. Remove tape from Flex Pipe before using.

How to Order:

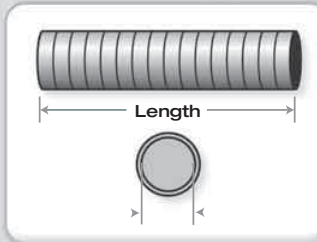

Determine your usage needs. Flex Pipe is sold in a variety of lengths, including precut lengths. All lengths range from 1" to 6" in diameter. Refer to the chart on the reverse side to determine your desired part number. Order by part number, not by the foot.

IMPORTANT:

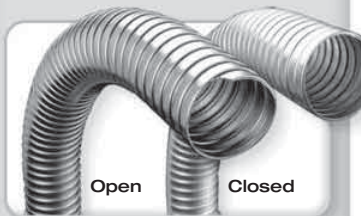

When measuring and cutting, keep the open side of the Flex Pipe to your right. To determine the open end, turn the end of the pipe toward you and look for the rings to wrap on top.

How to Cut:

There are three ways to cut Flex Pipe. Select a method that suits your equipment.

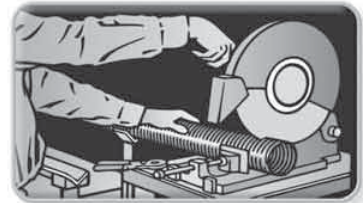

CHOP SAW: For best results, use a 1/16" wide blade. Make sure the Flex Pipe has the open side facing to the right. Align and secure pipe so the cut guide lines up with the Chop Saw blade, and cut.



BAND SAW: For best results, use a no-set blade with 24/32 teeth/inch. Make sure Flex Pipe has the open side facing to the right. Align and secure pipe so the cut guide lines up with the Band Saw blade, and cut.

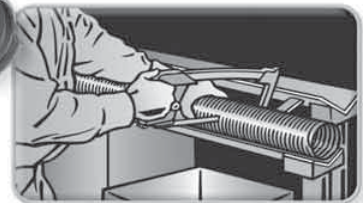

HACK SAW: For best results, use a no-set blade with 24/32 teeth/inch. Make sure Flex Pipe has the open side facing to the right. Align and secure pipe, and cut on the guide line.

ACCESSORIES

FLEX TUBING

I.D.	6 FOOT LENGTHS§			
	Stain.	Alz.	Galv.	
	.012" Thickness	.018" Thickness	.015" Thickness	.018" Thickness
1½	-	-	46971†	-
1¾	-	-	46972†	-
2	-	-	46973†	-
2⅝	-	-	56026†	-
2¼	-	-	46974†	-
2½	-	-	46975†	-
4	46917	46915	46911	46913
5	46918	46916	46912	46914

I.D.	25 FOOT LENGTHS§			
	Stain.	Alz.	Galv.	
	.012" Thickness	.018" Thickness	.015" Thickness	.018" Thickness
1	-	-	40000	-
1¼	-	-	40001	-
1½	-	-	40002	50003
1⅝	-	-	40013	-
1¾	-	-	40003	50004
2	-	-	40005	50005
2⅝	-	-	40014	-
2¼	-	-	40006	50006
2½	40031	-	40007	40030
3	40020	50010	40008	40009
3½	40021	50011	40024	40010
4	40022	50012	40025	40011
5	40023	50013	40026	40012
6	50015	-	50009	50008

I.D.	10 FOOT LENGTHS§			
	Stain.	Alz.	Galv.	
	.012" Thickness	.018" Thickness	.015" Thickness	.018" Thickness
2	49060	-	49042	49077
2¼	49061	-	49074	-
2½	49044	49081	49075	49078
2¾	-	-	49076	49037
3	49032	49105	49089	49028
3½	49033	49106	49090	49029
4	49034	49070	49091	49030
5	49035	49071	49092	49031
6	49063	-	-	49036

§ Fully Extended
† Packed - 6 per carton, individually labeled.

PRE-CUT FLEX HOSE

Style ID - ID

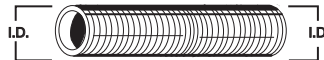

Length	3" Dia.			3½" Dia.		
	Galv.	Alz.	Stain.	Galv.	Alz.	Stain.
18	42065	-	42492	42066	-	42455
24	53089	-	-	53090	-	52435
36	54047	-	-	54048	-	53679
Length	4" Dia.			4½" Dia.		
	Galv.	Alz.	Stain.	Galv.	Alz.	Stain.
12	41692	-	41691	41694	-	41693
18	42067	52123	42423	42068	52124	42424
24	42069	52128	42338	42070	52129	42339
36	43381	-	43202	43382	-	43203
48	55006	-	54049	55007	-	54050

Style ID - OD

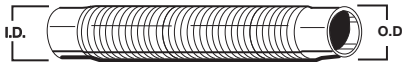

Length	3" Dia.			3½" Dia.		
	Galv.	Alz.	Stain.	Galv.	Alz.	Stain.
18	42175	-	-	42176	-	-
Length	4" Dia.			5" Dia.		
	Galv.	Alz.	Stain.	Galv.	Alz.	Stain.
18	42177	52068	-	42317	-	-

FLEX CONNECTOR

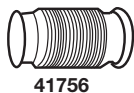

Part No.	OAL	Inlet Dia.	Outlet Dia.	Use Clamp No.
41756	12	4 ID	4 ID	35976 (2)

NON BENDABLE STANDARD STRAIGHT TUBING

Length	Low Carbon Steel 10'		
	18	17	15
Gauge	18	17	15
Thickness	0.042"	0.054"	0.065"
OD			
1½	49002	-	-
1⅝	49003	-	-
1¾	49004	-	-
1⅞	49005	-	-
2	49006	-	-
2⅛	49013	-	-
3¼	-	49058	-
4½	-	49056	-
5	-	-	49015
6	-	49027	-

Comparison of Gauge to Decimal	
Gauge	Decimal
13	0.082
14	0.069/0.075
15	0.065
16	0.055/0.060
17	0.050/0.054
18	0.042

ALUMINIZED STEEL TUBING

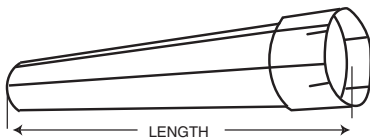

ONE END SWAGED
& SLOTTED
OTHER END - O.D.

Size	Part No.	Length
4	49214	10
5	49215	10

ACCESSORIES

TECH-FIT

HEAVY DUTY TRUCK
GWW 7-8

APPLICATION
BY ENGINE

MEDIUM
DUTY TRUCK
GWW 3-6

SCHOOL
BUS

AGRICULTURAL

MUFFLER
SPECS

O.E. CROSS
REFERENCE

ACCESSORIES

STRAIGHT TUBING



Bendable Aluminum Killed Draw Quality (AKDQ) Steel Tubing																	
OD	Low Carbon								Aluminized								
Length	7'		7' 6"		10'				7' 6"				10'				13'
Gauge	16	14	16	14	17	16	14	13	17	16	14	13	17	16	14	13	14
Thick-ness	0.060"	0.069"	0.060"	0.069"	0.050"	0.060"	0.075"	0.082"	0.050"	0.060"	0.069"	0.082"	0.050"	0.060"	0.069"	0.082"	0.069"
1½	-	-	47980	-	-	49021	-	-	47968	-	-	-	49045	49243	-	-	-
1¾	-	-	47982	-	-	49022	-	-	47971	-	-	-	49046	49241	-	-	-
1⅞	-	-	47983	-	-	49023	-	-	47969	-	-	-	49057	49242	-	-	-
2	47993	-	47984	47989	49016	49024	49043	-	-	47972	-	47960	-	49047	-	49069	-
2¼	-	-	-	47986	49007	-	49025	-	-	-	47973	47961	-	-	49048	49068	-
2½	-	47996	-	47987	49008	-	49026	-	-	-	47974	47962	-	-	49049	49067	-
2¾	-	-	-	-	49009	-	49040	-	-	-	-	-	-	-	49195	-	49050
3	-	-	-	-	-	49010	49041	49066	-	-	47963	47967	-	-	49159	49065	49051
3½	-	-	-	-	-	49011	-	-	-	-	-	-	-	49098	49160	-	-
4	-	-	-	-	-	49012	-	-	-	-	-	-	-	49099	49161	-	49052
5	-	-	-	-	-	-	-	-	-	-	-	-	-	49064	49162	-	-
6	-	-	-	-	-	-	-	-	-	-	-	-	-	-	49062	-	-

STAINLESS STEEL STRAIGHT TUBING

Bendable 409 Stainless Steel Tubing			Aluminized Stainless Steel Tubing	
Length	10' Length		4' Length	10' Length
Gauge	14	15	17	17
Thickness	0.071"	0.065"	0.054"	0.054"
OD				
2	-	-	-	49184
2¼	-	-	-	49185
2½	-	-	54762	49186
3	49095	-	54763	-
3½	49096	-	-	-
4	49097	-	-	-
5	-	49263	-	-

Note: Bending characteristics of stainless steel tubing are substantially different than low carbon steel tubing. Listed below are important factors in successfully bending stainless steel tubing.

1. Wing die (back) pressure may need to be increased to prevent backwall collapse.
2. The tube weld seam should be located 90° from the inside and outside of any severe bends.
3. Wing dies must be in good condition and in alignment throughout the entire bending arc.
4. Bends should be made in one continuous operation at a slow rate of speed.
5. Bends should not be made tighter than two times pipe diameter.
6. Equipment must be in proper operating condition.

STACK PIPES

Angled (ID)

Inlet Dia.	Length	ALZ.	Chrome
3 ID	18	42262	29120
3½ ID	18	-	29100
	36	53053	-
4 ID	18	42715	29111
	24	42071	29206
	36	43320	29305
	48	44299	29408
	60	45233	-
5 ID	18	42716	29112
	24	42072	29207
	36	43321	29306
	48	44300	-
	60	45246	29509
	72	-	29603
6 ID	84	-	29701
	18	42128	-



Angle ID

Angled (OD)

Inlet Dia.	Length	ALZ.	Chrome
3 OD	48	44302	-
4 OD	18	42129	-
	24	42544	-
	36	43718	29307
	48	44637	-
	60	45726	-
5 OD	18	42130	29102
	24	42543	29202
	36	43719	29308
	48	44638	29403
	60	45727	29503
	69½	46954	-
6 OD	18	42594	-

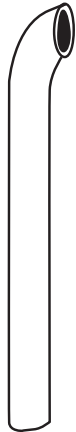

Angle OD

ACCESSORIES
TECH-FIT
HEAVY DUTY TRUCK GVW 7-8
APPLICATION BY ENGINE
MEDIUM DUTY TRUCK GVW 3-6
SCHOOL BUS
AGRICULTURAL
MUFFLER SPECS
O.E. CROSS REFERENCE

ACCESSORIES

STACK PIPES (Cont.)

Square Cut (ID)

Inlet Dia.	Length	ALZ.	Chrome
2½ ID	18	42596	–
3 ID	18	42606	–
	24	42178	–
	36	43606	–
	48	44301	–
3½ ID	18	42127	–
	36	43366	–
	48	44308	–
4 ID	18	42891	–
	24	42531	–
	36	43319	–
	48	44126	29414
	72	46892	–
5 ID	18	42126	–
	24	42530	–
	36	43582	–
	48	44127	–
6 ID	60	46778	–
	48	44303	–



Square Cut ID

Square Cut (OD) *

Inlet Dia.	Length	ALZ.
4 OD	48	44456
5 OD	36	53049
	42	53633
	48	44457
	58	55473
	60	45340



Square Cut OD

* For additional OD sizes and lengths use Straight Tubing.

OTHER STACK PIPES

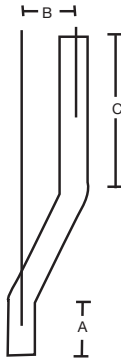

1

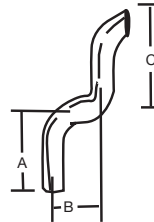

2

Inlet Dia.	Style	A	B	C	Length	ALZ.	Replaces OE No.
4 ID	1	6¾	1½	30½	48½	45320	532395C1
4 OD	1	11	10	29	51	45758	–
5 OD	1	11	10	30	60	45800	–
5 OD	2	8	11	21½	29½	43588	–

TAIL SPOUTS



Style A (OD)



Style B (ID)

Dia.	Length	Alumunized Steel		Chrome	
		Style A	Style B	Style A	Style B
3	12	41095	42448	-	-
3	18	-	-	-	29120
3½	12	-	42449	-	29138
3½	18	-	-	-	29100
4	12	41097	42447	29139	29140
4	18	42129	42715	-	29111
5	18	42130	42716	-	29112
5	20	-	42377	-	-
6	18	42594	42128	-	-

RAIN CAPS

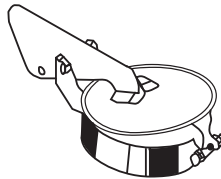

Size	Standard	Chrome
1¼	35608	-
1½	35225	-
1¾	35226	-
2	35512	-
2¼	35513	-
2½	35514	-
2¾	35617	-
3	35618	-
3½	35619	-
4	35907	35931
4½	35909	-
5	35910	35932
5½	35164	-
5¾	35393	-

SILENT RAIN CAPS

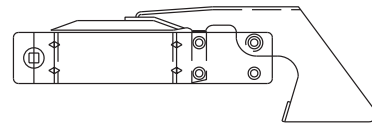

Size	Chrome
4	36158
5	36160

ACCESSORIES

TECH-FIT

HEAVY DUTY TRUCK
GVW 7-8

APPLICATION BY ENGINE

MEDIUM DUTY TRUCK
GVW 3-6

SCHOOL BUS

AGRICULTURAL

MUFFLER SPECS

O.E. CROSS REFERENCE

ACCESSORIES

UNIVERSAL HEAVY DUTY HANGERS & BRACKET

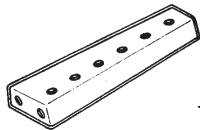

35357
Frame Mount Bracket

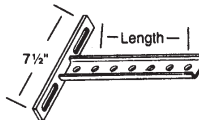

For use on 4" - 5" OD Applications

Part No.	Length
35530	9¼
35556	14

SWIVEL HANGERS

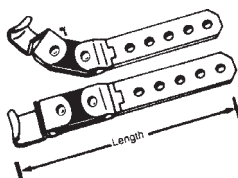

Specially designed hanger, engineered to solve essentially any hanger problem. Hanger swings from 0° to ± 45° and also has complete 360° rotation.

Part No.	Length
35103	9½
35898	17

SPLITTER "T" ADAPTER PIPE

Converts a single system into a dual system on popular diesel engines.

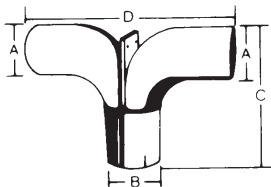

Part No. w/o Bracket	Part No. w/Bracket	A	B	C	D
—	40247	4 OD	4 ID	11¼	18¾
—	40364	5 OD	5 ID	15	24¾
40220	—	5 OD	5 OD	11	19
40223	—	5 OD	5 ID	13½	22

CONVENTIONAL "Y" PIPE

O.E. replacement on various models of trucks.
Can be used to convert dual to single exhaust

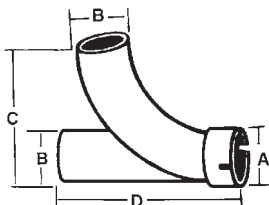

Part No.	A	B	C	D
40256	4 ID	4 OD	11	16
40257	5 ID	5 OD	11½	16

ALUMINIZED AND STAINLESS STEEL MUFFLER AND PIPE SHIELDS

180° PIPE SHIELDS AND CLAMP KITS

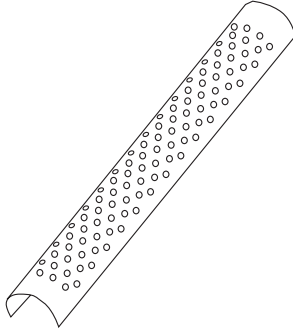

PIPE SHIELDS	
Part No.	Specifications
29039	Aluminized 4"-5" x 48" Pipe Shield w/o Mtng. Clamps, Round Holes
29041	Stainless Steel 4"-5" x 48" Pipe Shield w/o Mtng. Clamps, Round Holes
29045	Stainless Steel 3½"-5" x 48" Pipe Shield w/o Mtng. Clamps w/Horizontal Slots
29047	Stainless Steel 6" x 48" Pipe Shield w/o Mtng. Clamps, Round Holes

PIPE SHIELD CLAMP KIT (2 Clamps)	
Part No.	Specifications
35884☆	Chrome Clamp Kit for 4" Diameter Pipe
35885☆	Chrome Clamp Kit for 5" Diameter Pipe
35348☆	Chrome Clamp Kit for 6" Diameter Pipe
35441☆	Zinc Plated Clamp Kit for 4" Diameter Pipe
35442☆	Zinc Plated Clamp Kit for 5" Diameter Pipe
35372☆	Zinc Plated Clamp Kit for 6" Diameter Pipe

☆ Clamps (2) included in box.

CHROME GRAB HANDLE

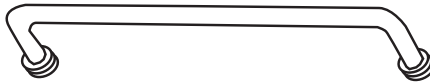

Part No.	Specifications
29110	18" Length
29219	24" Length

360° ALUMINIZED PIPE SHIELD



Part No.	Fits Diameter	Length of Guard
29030☆	3" Pipe	36"
29031☆	4" Pipe	36"

☆ Clamps (2) included in box.

No. 35796 UNIVERSAL MOUNTING BRACKET

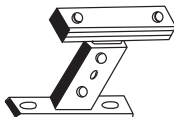

Use for either cab or mast mount. Fits 4"–5" piping.

ACCESSORIES

TECH-FIT

HEAVY DUTY TRUCK
GWW 7-8

APPLICATION BY ENGINE

MEDIUM DUTY TRUCK
GWW 3-6

SCHOOL BUS

AGRICULTURAL

MUFFLER SPECS

O.E. CROSS REFERENCE

ACCESSORIES

ALUMINIZED AND STAINLESS STEEL MUFFLER AND PIPE SHIELDS (Cont.)

180° MUFFLER SHIELDS AND CLAMP KITS

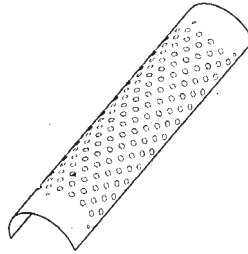

180° MUFFLER SHIELDS

MUFFLER SHIELDS	
Part No.	Specifications
29029	Aluminized 8"-10" x 42" Muffler Shield w/o Mtng. Clamps, Round Holes
29052	Aluminized 8"-10" x 51" Muffler Shield w/o Mtng. Clamps, Round Holes
29043	Aluminized 8"-10" x 51¼" Muffler Shield w/o Mtng. Clamps, Round Holes
29036	Stainless Steel 8"-10" x 42" Muffler Shield w/o Mtng. Clamps, Round Holes
29042	Stainless Steel 8"-10½" x 51" Muffler Shield w/o Mtng. Clamps, Round Holes
29044	Stainless Steel 8"-10" x 51" Muffler Shield w/o Mtng. Clamps, w/Horizontal Opening



180° MUFFLER SHIELD CLAMP KITS

MUFFLER SHIELD CLAMP KITS (2 Clamps)	
Part No.	Specifications
36224☆	Chrome Clamp Kit for 8" Diameter Muffler
35886☆	Chrome Clamp Kit for 8½" Diameter Muffler
35887☆	Chrome Clamp Kit for 9" Diameter Muffler
35933☆	Chrome Clamp Kit for 10" Diameter Muffler
35935☆	Chrome Clamp Kit for 10¾" Diameter Muffler
35790☆	Zinc Plated Clamp Kit for 9" Diameter Muffler
35791☆	Zinc Plated Clamp Kit for 10" Diameter Muffler
35792☆	Zinc Plated Clamp Kit for 10½" Diameter Muffler

☆ Clamps (2) included in box.

ALUMINIZED AND STAINLESS STEEL MUFFLER AND PIPE SHIELDS

270° MUFFLER SHIELDS AND CLAMP KITS

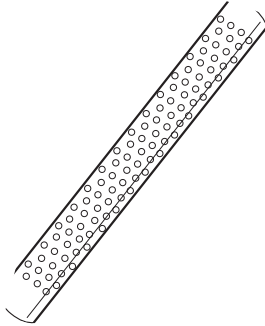

MUFFLER SHIELDS	
Part No.	Specifications
29048	Aluminized 8½"-10½" x 48" Muffler Shield w/o Mtng. Clamps, Round Holes
29046▼	Stainless Steel 8½"-10½" x 48" Muffler Shield w/o Mtng. Clamps, Round Holes
29051	Stainless Steel 9"-10" x 51" Muffler Shield w/o Mtng. Clamps, Round Holes

▼ Shield only, requires (2) 35370 clamps and 29110 Grab Handle.

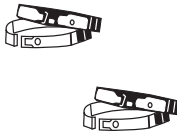

MUFFLER SHIELD CLAMP KIT (2 Clamps)	
Part No.	Specifications
36227	Aluminized Clamp Kit for 9" Muffler
36226	Aluminized Clamp Kit for 10" Muffler
35216	Chrome Clamp Kit for 9" Muffler
35370	Chrome Clamp Kit for 10" Muffler

270° PIPE SHIELDS AND CLAMP KITS

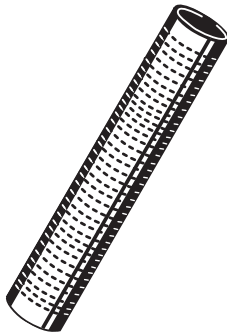

PIPE SHIELDS	
Part No.	Specifications
29033	Aluminized 4"-5" x 36" Pipe Shield w/o Mtng. Clamps, Round Holes

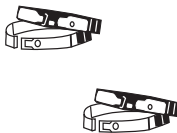

PIPE SHIELD CLAMP KIT (2 Clamps)	
Part No.	Specifications
35884	Chrome Plated Clamp Kit for 4" Diameter Pipe
35885	Chrome Plated Clamp Kit for 5" Diameter Pipe
35441	Zinc Plated Clamp Kit for 4" Diameter Pipe
35442	Zinc Plated Clamp Kit for 5" Diameter Pipe

ACCESSORIES

TECH-FIT

HEAVY DUTY TRUCK
GVW 7-8

APPLICATION BY ENGINE

MEDIUM DUTY TRUCK
GVW 3-6

SCHOOL BUS

AGRICULTURAL

MUFFLER SPECS

O.E. CROSS REFERENCE

ACCESSORIES

MUFFLER HANGERS

Heavy Duty muffler body clamp and hanger strap. The strap can be bent and twisted to fit the installation. Use for horizontal or vertical mount. Use two for maximum rigidity.

Part No.	Style	Fits Body Diameter
35745	B	7-8 ⁵ / ₈
35854	A	6
35855	A	7
35338	A	8
35856	A	8 ¹ / ₂
35972	A	9
35983	A	10
35733	A	8 ¹ / ₄ x 11 ¹ / ₂
35984	A	10 x 15
35899	A	11 ¹ / ₈
36209	C	10 x 15
36448	A	12

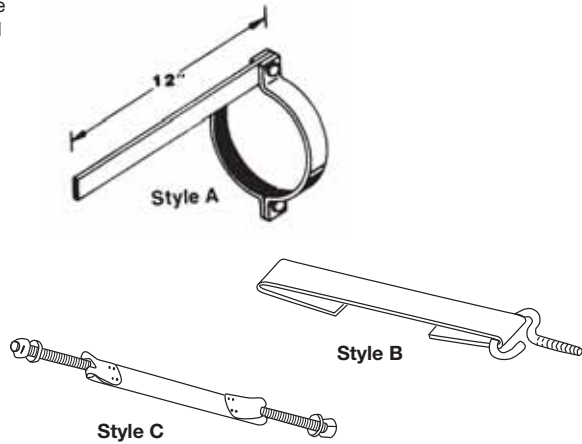

PIPE HANGERS

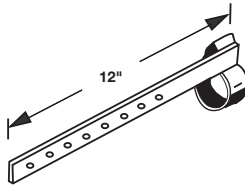

Clamp and Hanger strap, made of heavy gauge steel to hold tail pipe and exhaust pipe in a rigid position.

Part No.	Fits Pipe Diameter	Part No.	Fits Pipe Diameter
35604	2 ¹ / ₂	35853	4
35605	2 ³ / ₄	35734	5
35606	3	35855	7
35852	3 ¹ / ₂		

UNIVERSAL HANGER & BRACKET

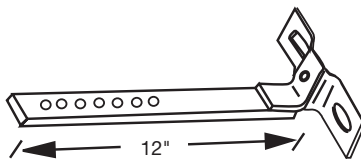

35966
Fits 2³/₄" - 4¹/₂" O.D.

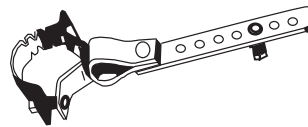

35600
Fits 1¹/₂" to 2¹/₄" OD

UNIVERSAL HANGERS

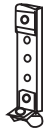

35209

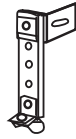

35210



35315



35517

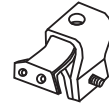

35544

O.E. Type Hanger	Universal Hanger	O.E. Type Hanger	Universal Hanger
35315	35209	35544	35210
35517	35209		

INTERNATIONAL TAIL PIPE BRACKET AND HANGERS

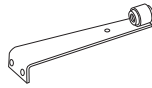

36449

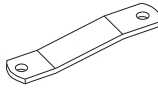

36450



36451

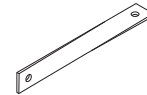

36452

Part No.	International No.
36449	482173C1
36450	255502C1
36451	282400C1
36452	1675835C1

INTERNATIONAL MUFFLER HANGER

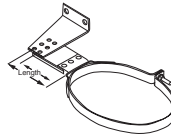

36393

Length	IHC Part Number	Strap Locations
4½	1660539C91	Top row of holes
5	1660543C91	Bottom row of holes

FREIGHTLINER MUFFLER HANGER



36457

Freightliner Part Number	Fits Body Diameter
04-17998-001	11⅝

ACCESSORIES

TECH-FIT

HEAVY DUTY TRUCK GVM 7-8

APPLICATION BY ENGINE

MEDIUM DUTY TRUCK GVM 3-6

SCHOOL BUS

AGRICULTURAL

MUFFLER SPECS

O.E. CROSS REFERENCE

ACCESSORIES

INSTALLING UNIVERSAL RESONATOR

The universal resonators shown in the accessory section of the catalog, properly installed in the center of the exhaust pipe, can generally reduce the exhaust noise level 2 to 3 db(A).

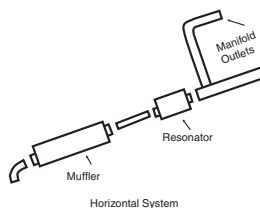
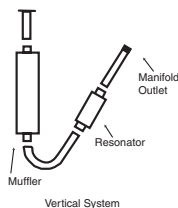

UNIVERSAL TYPE RESONATORS

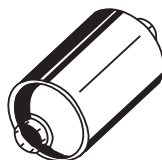

Four popular sizes specially designed for use in combination with gas or diesel heavy duty mufflers.

Part No.	21146	22538	21467	21464	21835
Inlet Diameter (ID)	3	3	3½	4	5
Outlet Diameter (ID)	3	3	3½	4	5
Shell Diameter	7	9	7	7	9
Shell Length	12	11½	12	12	12
Overall Length	20	16	20	20	20

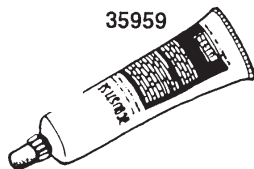

Muffler Cement & Sealing Compound

35958

Consists of iron-reinforced material tested to 12000 F. Effective for sealing exhaust joints subject to elevated temperatures - such as catalytic converters. Available in 16 oz. tubes only.

35959

Stops sound leaks and prevents dangerous exhaust gas leakage to 9000 F. Ideal for "out-of-round" muffler and pipe connections. Easy to apply. Available in 5 oz. tubes.



35729
35165
35187

Pipe Hooks

35729 - Up to 2½" Diameter.

35165 - For 2¾" to 4" Diameter.

35187 - For 5" to 6" Diameter.

Packaged 50 to a box, these hooks provide an economical and easy method of storing exhaust and tail pipes.

SPARK ARRESTORS

SPARK ARRESTOR APPROVED
UNDER USDA FOREST
SERVICE STANDARD 5100-1a

As indicated by this symbol
▼ embossed on all unit shells.

**NOTE:
INLET IS SLOTTED END**

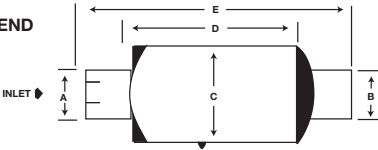

- Tested and U.S. Forest Service approved for vertical or horizontal installations.
- All Spark arrestors 95% or greater efficiency on incendiary sparks - reduces fire hazard.
- Centrifugal force separates solids from exhaust gas.
- Aluminized construction with stainless steel critical parts.

Part No.	Body Diameter	Inlet and Outlet Diameter	Body Length	Overall Length
35807	4¼	1½ ID - 1½ OD	3⅞	6
21578	5⅝	2 ID - 2 ID	6⅝	11
21579	5⅝	2½ ID - 2½ ID	8⅝	12⅞
21580	6⅝	3 ID - 3⅞ OD	10⅞	14⅞
21581	7⅝	3½ ID - 3⅝ OD	12	17⅝
21582	8½	4 ID - 4⅞ OD	14⅝	21⅞

SELECTING A SPARK ARRESTOR

Seven models of different sizes and capacities are currently being produced. Generally, if a spark arrester will fit on the exhaust pipe of an engine, it will also have acceptable back pressure for that engine. In some cases, a larger size spark arrester will be required to stay within back pressure limits and in those cases, adapters will have to be used.

ACCESSORIES

TECH-FIT

HEAVY DUTY TRUCK
TRUCK
GVW 7-8

APPLICATION BY ENGINE

MEDIUM DUTY TRUCK
GVW 3-6

SCHOOL BUS

AGRICULTURAL

MUFFLER SPECS

O.E. CROSS REFERENCE

ACCESSORIES

RUBBER GOODS

90° ELBOW

Size	Part No.	DIMENSIONS					
		A	B	C	D	E	F
4	36171	4	5 $\frac{3}{4}$	5 $\frac{3}{4}$	1 $\frac{1}{2}$	1 $\frac{1}{2}$	$\frac{1}{4}$
5	36172	5	6	6	1 $\frac{1}{2}$	1 $\frac{1}{2}$	$\frac{1}{4}$
☆5 $\frac{1}{2}$	36173	5 $\frac{1}{2}$	6 $\frac{1}{2}$	6 $\frac{1}{2}$	1 $\frac{3}{4}$	1 $\frac{3}{4}$	$\frac{1}{4}$
6	36175	6	7	7	2	2	$\frac{1}{4}$
7	36178	7	7 $\frac{9}{16}$	7 $\frac{9}{16}$	2	2	$\frac{1}{4}$

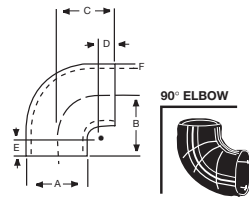

☆ Not recommended for use on Cummins 1710 engine.

90° SHORT RADIUS ELBOW

Size	Part No.	DIMENSIONS					
		A	B	C	D	E	F
6	36176	6	5	5	$\frac{3}{4}$	$\frac{3}{4}$	$\frac{3}{4}$

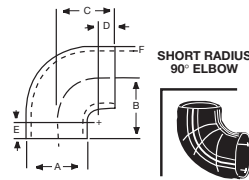

90° REDUCER ELBOW

Size	Part No.	DIMENSIONS						
		A	B	C	D	E	F	G
6 x 5 $\frac{1}{2}$	36177	6	5 $\frac{1}{2}$	6 $\frac{3}{4}$	6 $\frac{3}{4}$	2	1 $\frac{3}{4}$	$\frac{1}{4}$

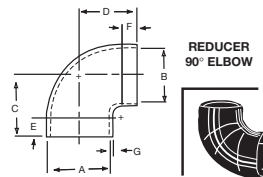

45° ELBOW

Size	Part No.	DIMENSIONS				
		A	B	C	D	E
4	36164	4	45°	$\frac{1}{4}$	1 $\frac{15}{32}$	1 $\frac{15}{32}$
6	36166	6	45°	$\frac{1}{4}$	1 $\frac{3}{4}$	1 $\frac{3}{4}$

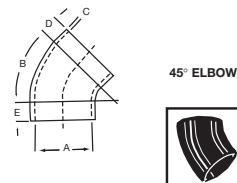

RUBBER GOODS (Cont.)

HUMP HOSE

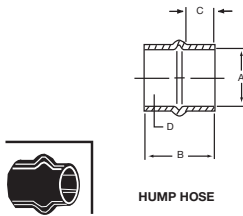

Size	Part No.	DIMENSIONS			
		A	B	C	D
4	36183	4	5¼	2	¼
5½	36185	5½	6	2¼	¼
6	36186	6	7	2¾	¼

REDUCER INSERT

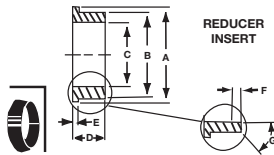

Size	Part No.	DIMENSIONS						
		A	B	C	D	E	F	G
5 x 4	36190	5½	5	4	1¾	¼	½	45°
5½ x 5	36193	6	5½	5	1¾	¼	¼	45°

AIR LINE CLAMPS



Size	Part No.	Size	Part No.
3	36203	5½	36201
3½	36202	6	36206
4	36204	7	36207
5	36205	8	36208

AIR INTAKE ALUMINUM TUBING

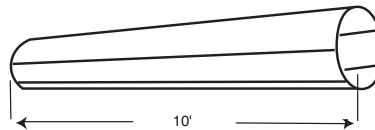

Size	Part No.
4	49200
6	49203
7	49204

ACCESSORIES

TECH-FIT

HEAVY DUTY TRUCK
GVW 7-8

APPLICATION BY ENGINE

MEDIUM DUTY TRUCK
GVW 3-6

SCHOOL BUS

AGRICULTURAL

MUFFLER SPECS

O.E. CROSS REFERENCE