

# FLARED ADAPTERS

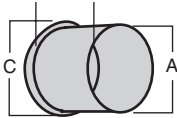

Style A

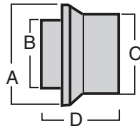

Style B

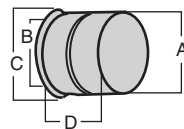

Style C

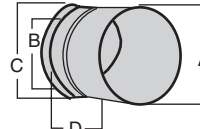

Style D

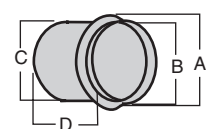

Style E

Part No.	Style	A	B	C	D	Flare	Application	Used w/ V-Band Clamp
41861	D	4.00 OD	2.875 ID	3.75 OD	3.50	20°		35690
41873	D	4.00 OD	2.875 ID	3.937 OD	3.50	20°		35495
41871	A	2.50 OD	—	3.70 OD	1.50	20°		—
41645	A	3.00 ID	—	3.78	3.00	20°	Ford Motor Co, Detroit Diesel 6V71, 6v73, Cummins V555, V902	
41646	C	3.00 OD	3.00 ID	3.62	4.00	22°	Detroit Diesel 6V71	35695
41659	A	3.00 OD	—	3.50	3.50	45°		35695
41656	C	3.00 OD	3.125 ID	3.625 OD	4.75	45°		35449
41662	A	3.00 ID	3.00 ID	3.90 OD	2.50	20°	GMC Truck/Bus w/8.2N	35495
41865	A	3.50 OD	—	4.00	3.50	22°	Cat 3208T	35520
41862	A	3.50 OD	—	4.00 OD	5.00	45°	Detroit Diesel	35494
41657	C	3.50 ID	3.50 ID	4.00 OD	4.75	45°		35494
41647	C	3.50 ID	3.58 ID	4.30	4.00	20°	Detroit Diesel 8V-71	35804
41872	C	3.50 OD	3.63 ID	4.25 OD	4.00	22°	Detroit Diesel 8V-71	35804
41864	C	3.50 OD	3.63 ID	4.25 OD	4.00	22°	Detroit Diesel 8V-71	35804
41648	A	3.50 OD	—	4.30	3.00	20°	Detroit Diesel 8V92, 4-53	35520
41649	A	3.50 OD	—	4.00	3.00	45°	Detroit Diesel	35494
35110	A	3.69 OD	—	4.25 OD	1.50	20°	Navistar	—
41663	C	4.00 OD	3.625 ID	4.25	4.00	22°	Detroit Diesel 8V-71	35804
41860	D	4.00 OD	3.75 OD	4.25 OD	4.00	22°	Detroit Diesel 8V-71	35804
41650	C	4.00 OD	4.00 ID	4.75	4.00	22°	Detroit Diesel 12V71	35641
41651	D	4.00 OD	3.50 ID	4.25	4.00	20°	Detroit Diesel 8.2N, Cummins VT225	35496
41863	C	4.00 OD	4.00 ID	4.50 OD	4.75	45°		35805
41874	C	4.00 OD	4.00 ID	4.50 OD	4.75	45°		35805
41652	A	4.00 OD	—	4.80	3.00	20°	Detroit Diesel 6-71, 8.2N, 8.2T, Mack	35499
41653	A	4.00 OD	—	4.50	5.00	45°	Cummins	35805
41688*	B	5.00 OD	4.50 OD	5.15 OD	4.45	20°	Detroit Diesel 8V-71T, 16V-71T, 6V-92T, 8V-92T	35746
41654	A	5.00 OD	—	5.50	5.00	45°	Cummins	35500
41655	A	5.00 OD	—	5.72	3.00	20°	Caterpillar Turbo, Cummins Turbo, Navistar	35806
41696	A	5.00 OD	—	5.75 OD	5.50	20°	Navistar	35806
41689	A	5.00 OD	—	5.875	6.25	20°	T-50 Turbo Charger	35806
41658	C	5.00 OD	5.00 ID	5.50 OD	4.75	45°		35500
41875	D	5.00 ID	5.00 OD	5.75 OD	5.00	20°		—
35747	B	5.15 OD	4.55 OD	4.81 OD	1.94	20°	Detroit Diesel 8V71T, 16V-71, 6V-92T, 8V-92T, 16V-92T	35746
41690	E	5.69 OD	5.00 OD	5.00 OD	6.00	—	Cummins Engines	35806

\* With machined ring.